



APEX CONNECTOR  
鋁鋼精密科技  
- Since 1978 -

# SMA / SMB / MMCX

Sub Miniature Coaxial Connectors

Semi-Rigid Cable Assemblies  
STAFLEX Cable Assemblies for Microwave

**APEX**  
CONNECTORS

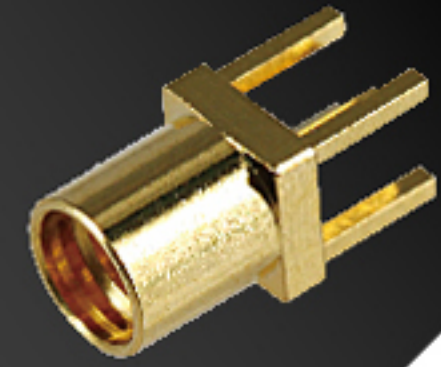

[www.plt.com.tw](http://www.plt.com.tw)



產品多元·網站查詢  
Diversified products for more information  
please check our website



# CONTENTS











## SMA Series

OVERVIEW	APEX NO.	PAGE
	SMA-101	04
	SMA-102	04
	SMA-103	04
	SMA-104	05
	SMA-105	05
	SMA-106	05
	SMA-107	05
	SMA-108	05
	SMA-109	06
	SMA-109C	06
	SMA-110	06

OVERVIEW	APEX NO.	PAGE
	SMA-111	05
	SMA-112	06
	SMA-113	07
	SMA-114	07
	SMA-115	07
	SMA-116	07
	SMA-117	07
	SMA-118	08
	SMA-119	08
	SMA-120	08
	SMA-121	08

# CONTENTS

## SMA Series

OVERVIEW	APEX NO.	PAGE
	<b>SMA-122</b>	<b>08</b>
	<b>SMA-123</b>	<b>09</b>
	<b>SMA-125</b>	<b>09</b>
	<b>SMA-132</b>	<b>09</b>
	<b>SMA-134</b>	<b>09</b>
	<b>SMA-136</b>	<b>09</b>
	<b>SMA-139</b>	<b>10</b>
	<b>SMA-141</b>	<b>10</b>
	<b>SMA-142</b>	<b>10</b>
	<b>SMA-143</b>	<b>10</b>
	<b>SMA-144</b>	<b>10</b>

OVERVIEW	APEX NO.	PAGE
	<b>SMA-145</b>	<b>11</b>
	<b>SMA-146</b>	<b>11</b>
	<b>SMA-501A</b>	<b>11</b>
	<b>SMA-801A</b>	<b>11</b>
	<b>SMA-802A</b>	<b>11</b>
	<b>SMA-803A</b>	<b>12</b>
	<b>SMA-804A</b>	<b>12</b>
	<b>SMA-807A</b>	<b>12</b>
	<b>SMA-808A</b>	<b>12</b>
	<b>SMA-809A</b>	<b>12</b>
	<b>SMA-810A</b>	<b>13</b>

# CONTENTS

## SMA Series

OVERVIEW	APEX NO.	PAGE
	WA-1072A-R	13
	WA-1097A-R	13
	SMA-126C	13

## SMB Series

OVERVIEW	APEX NO.	PAGE
	SMB-101	14
	SMB-102	14
	SMB-103	14
	SMB-104	15
	SMB-105	15
	SMB-109B	15
	SMB-114A	15
	SMB-115B	15

## MMCX Series

OVERVIEW	APEX NO.	PAGE
	MMCX-101	16
	MMCX-102	16
	MMCX-103	16
	MMCX-105A	17
	MMCX-111A	17

**Semi-Rigid Cable Assemblies** 17

**STAFLEX Cable Assemblies for Microwave** 17

## ORDERING INFORMATION

### SMA - 101A - B G G T

**SMA SERIES**

**MODEL NO.**

**CABLE SIZE / TYPE**

**BODY MATERIAL**

B	COPPER ALLOY
Z	ZINC ALLOY
S	STAINLESS

**BODY PLATING**

C	CHROME
G	GOLD
S	SILVER
N	NICKEL

**INSULATOR**

D	DELTRIN
T	TEFLON
P	PLASTIC
PB	PBT POLYESTER
PH	PHENOLIC

**PIN PLATING**

C	CHROME
G	GOLD
S	SILVER
N	NICKEL

### Electrical Specifications

- Voltage Rating : AC 500V
- Withstanding Voltage : AC 1,500V one minute
- Insulation Resistance : 1,000MΩ min at DC 500V
- Contact Resistance : 3mΩ max.
- Impedance : 50Ω

#### SMA-101



#### PLUG

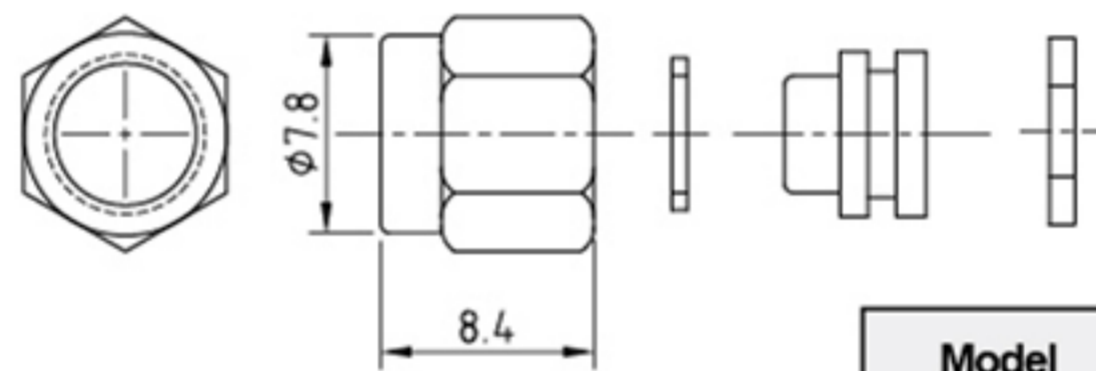

Model	Equivalent Identification	Cables for Use
SMA-101A	SMA-P-141AU	RG-141A/U RG-303/U

#### SMA-102



#### PLUG

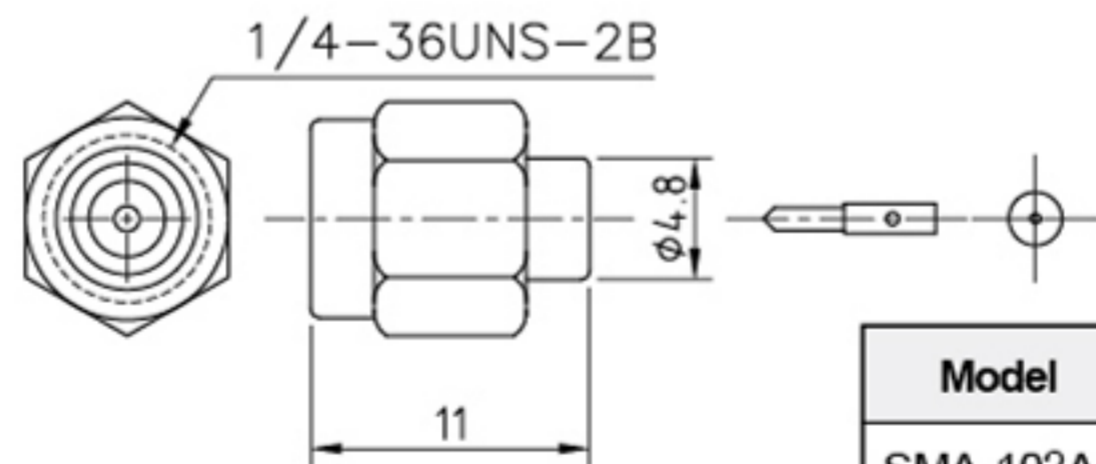

Model	Equivalent Identification	Cables for Use
SMA-102A	SMA-P-58U	RG-141A/U RG-58/U

#### SMA-103



#### BULKHEAD RECEPTACLES

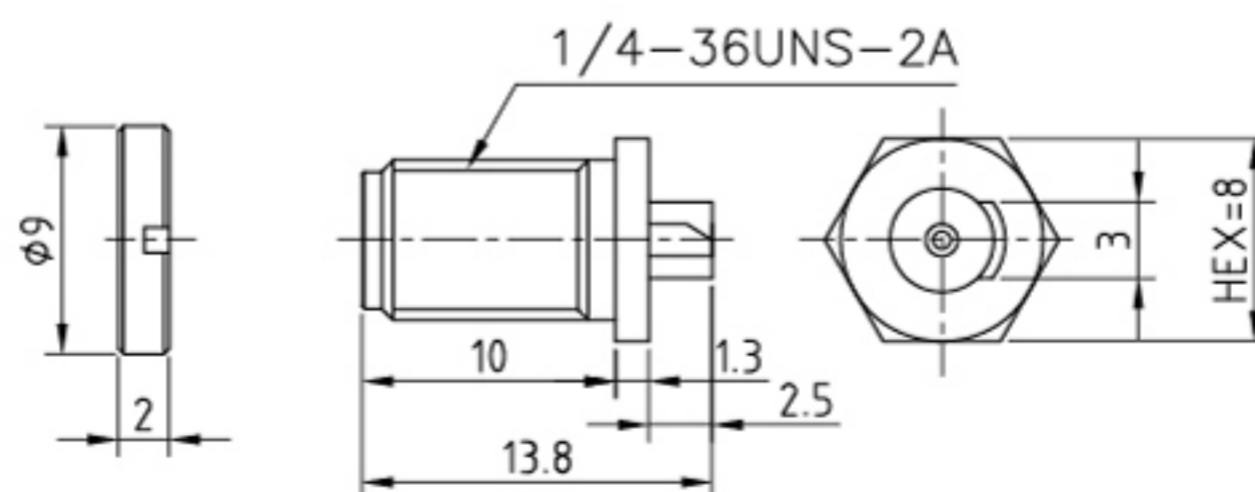

SMA-104



PLUG CLAMP

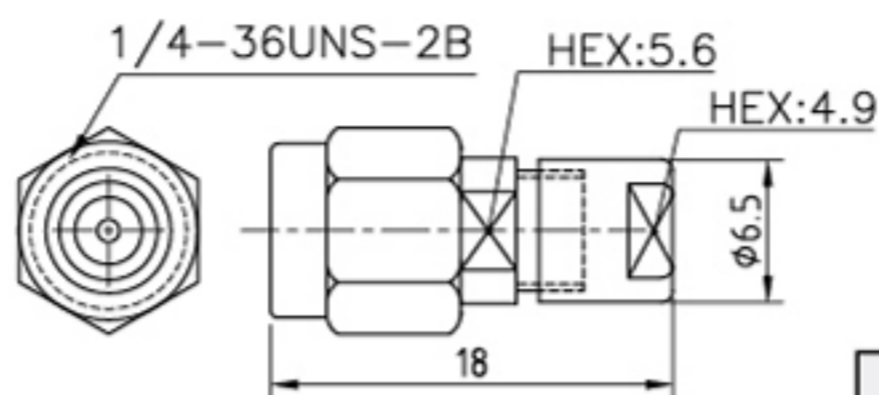

Model	Equivalent Identification	Cables for Use
SMA-104A	SMA-P-1.5D	1.5D-2V

SMA-105



PLUG CLAMP

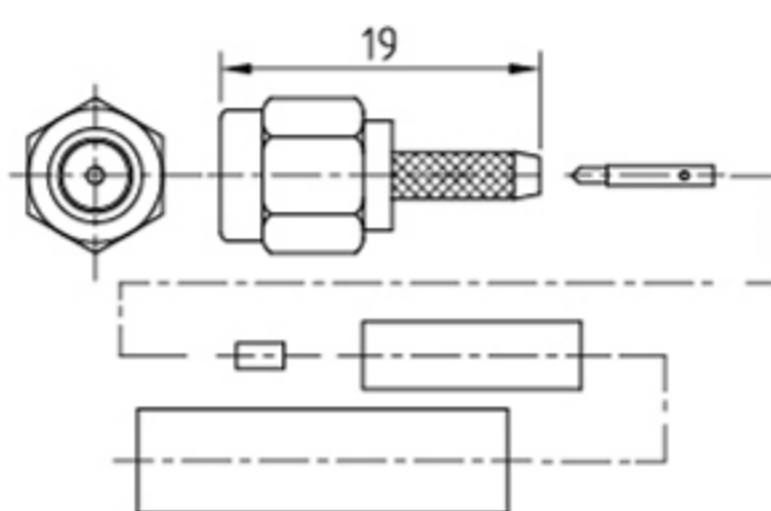

Model	Equivalent Identification	Cables for Use
SMA-105A	SMA-P-1.5D	1.5D-2V
SMA-105B	SMA-P-2.5D	2.5D-2V
SMA-105C	SMA-P-3D	3D-2V
SMA-105D	SMA-P-55U	RG-55/U

SMA-106



ADAPTERS PP

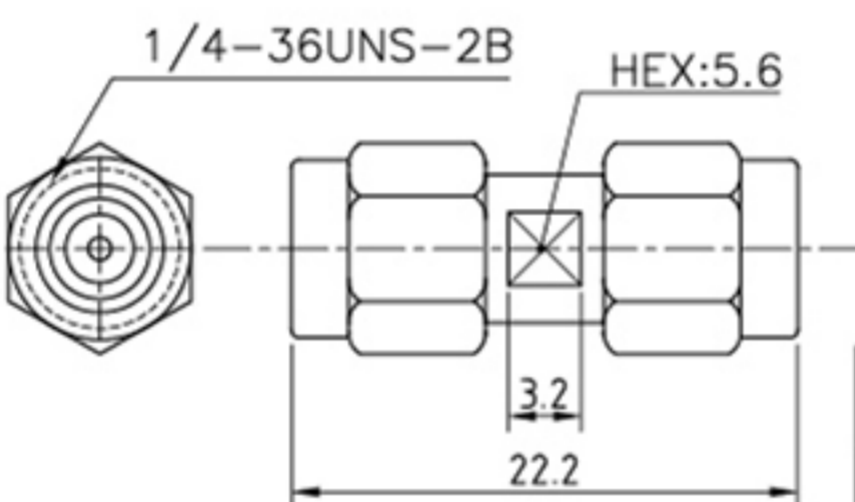

Model	Equivalent Identification	Cables for Use
SMA-106A	SMA-P-141AU	RG-141A/U RG-303/U

SMA-107



R/A PCB RECEPTACLE JACK

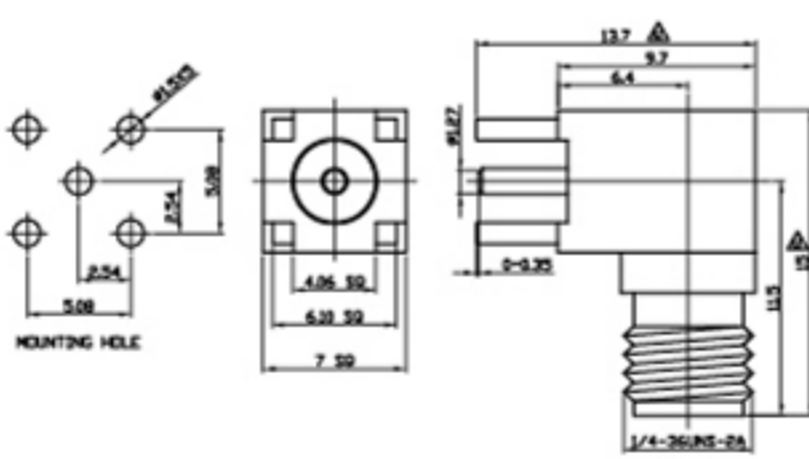

Model	Equivalent Identification	Cables for Use
SMA-107A	SMA-P-141AU	RG-141A/U RG-303/U

SMA-108



JACK CLAMP

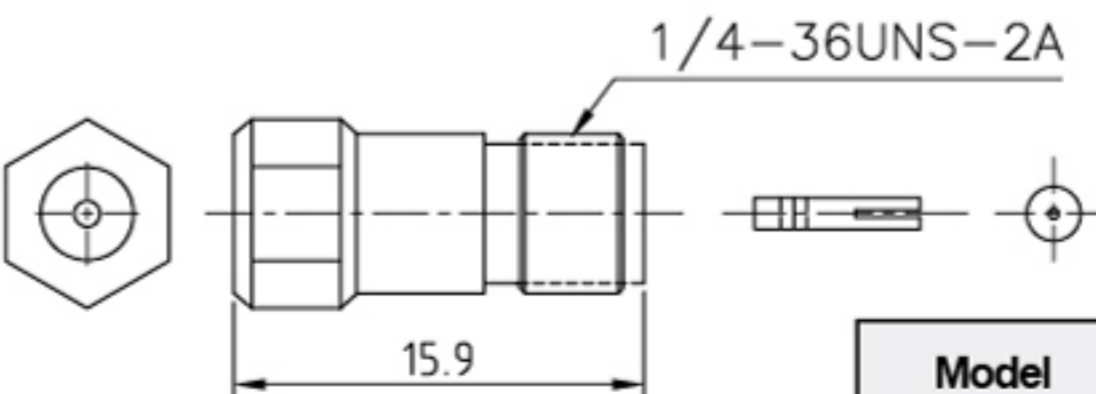

Model	Equivalent Identification	Cables for Use
SMA-108A	SMAJ-85U	RG-85U
SMA-108B	SMA-J-141A/U	RG-141A/U

SMA-109



R/A PLUG CLAMP

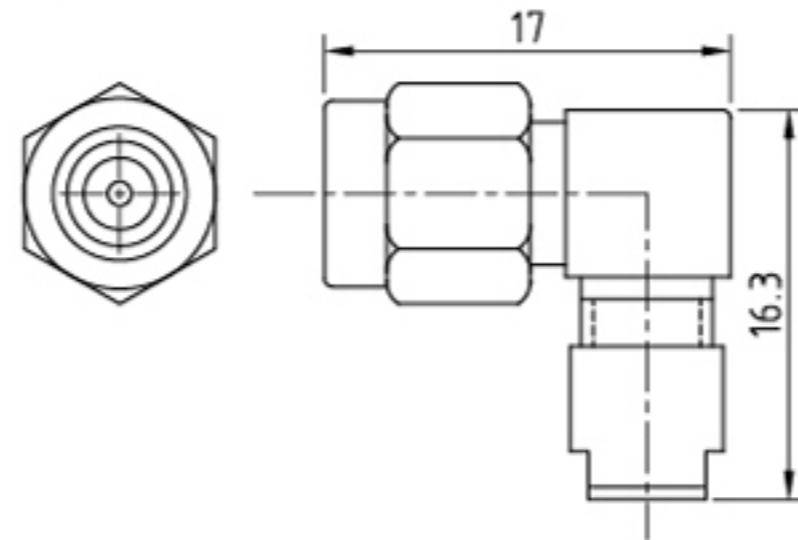

Model	Equivalent Identification	Cables for Use
SMA-104A	SMA-P-1.5D	1.5D-2V

SMA-109C



PLUG CLAMP

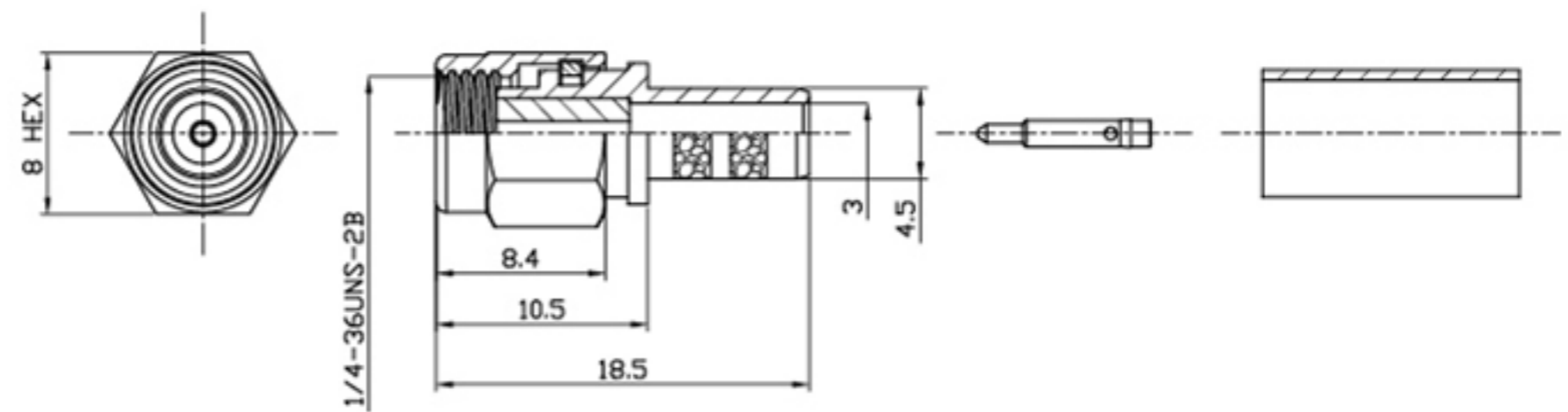

SMA-110



PLUG CLAMP

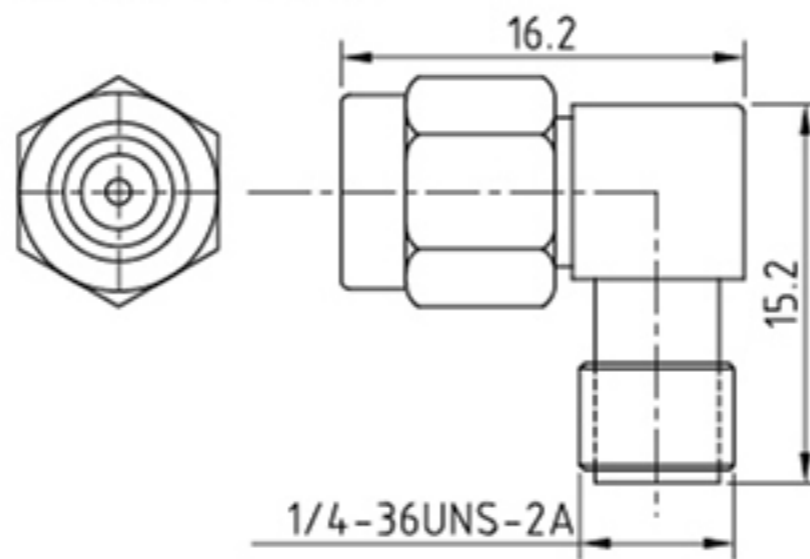

SMA-111



R/A PLUG CLAMP

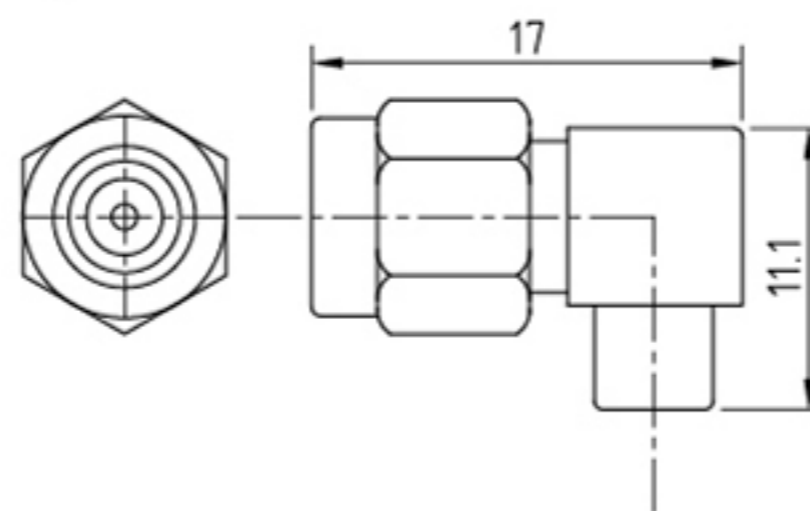

Model	Equivalent Identification	Cables for Use
SMA-111A	SMA-P-85U	RG-85/U
SMA-111B	SMA-P-141A/U	RG-141A/U

SMA-112

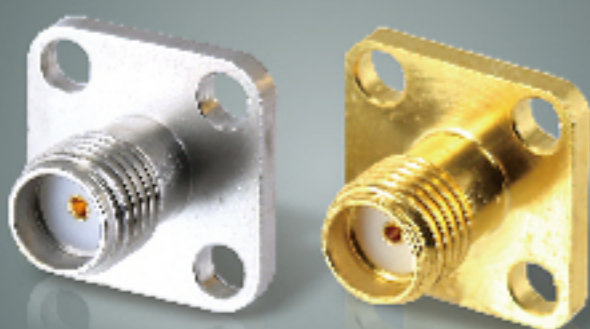

PANEL RECEPTACLE SOLDER

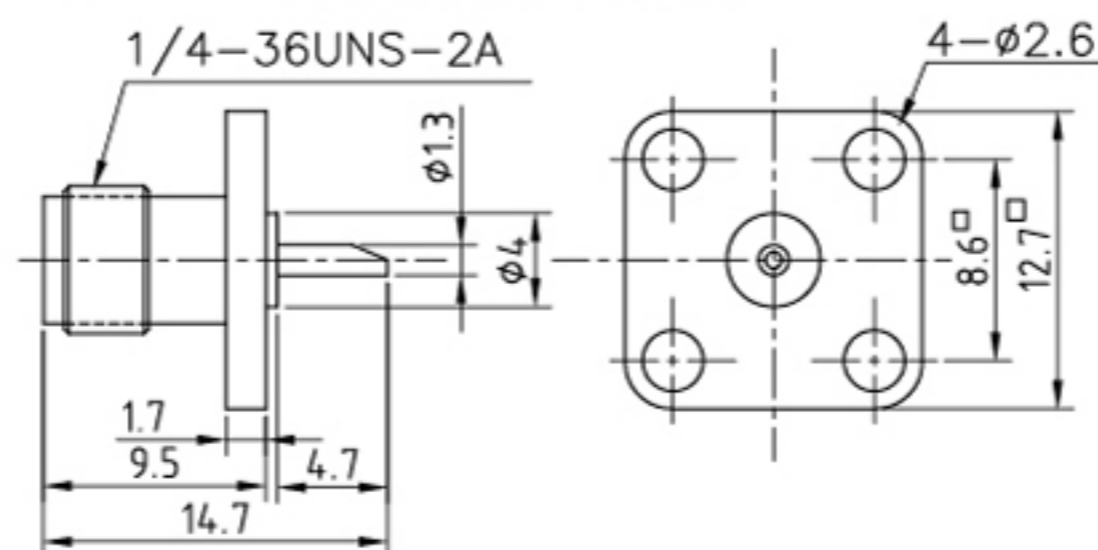

SMA-113



PANEL RECEPTACLE PCB

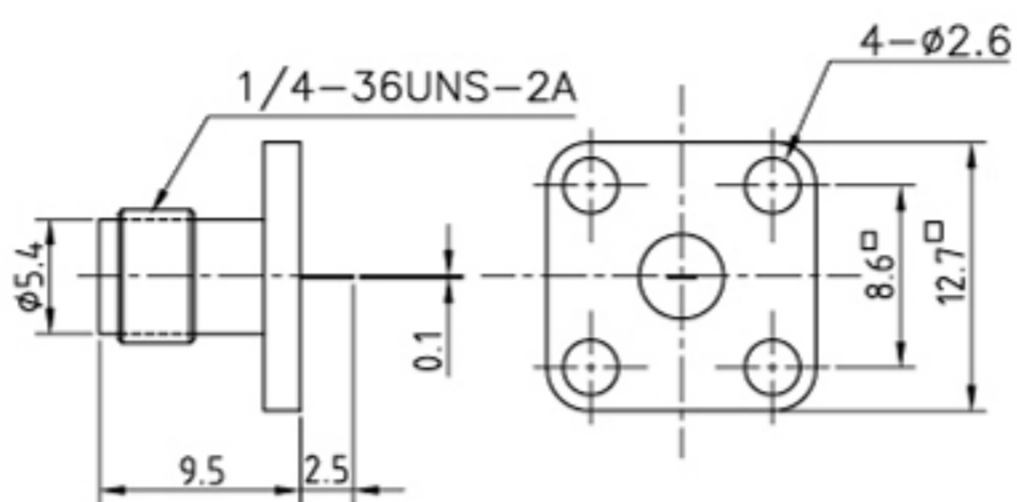

SMA-114



PANEL RECEPTACLE CRIMP

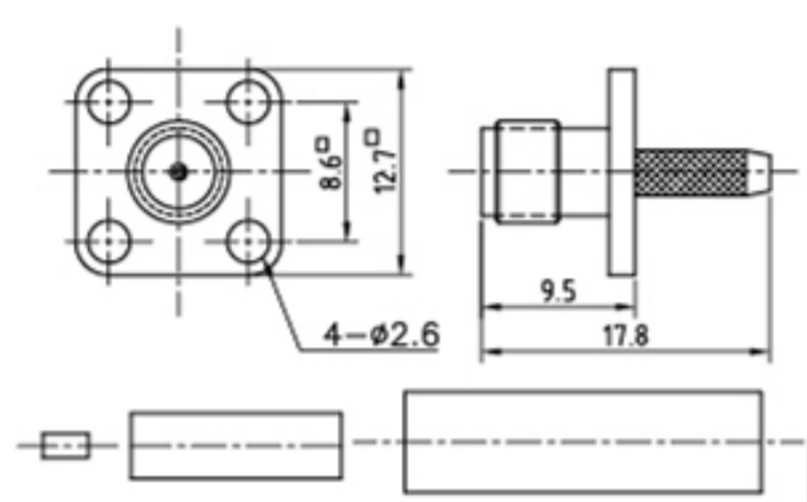

Model	Equivalent Identification	Cables for Use
SMA-114A	SMA-J-1.5D	1.5D-2V
SMA-114B	SMA-J-2.5D	2.5D-2V
SMA-114C	SMA-J-3D	3D-2V
SMA-114D	SMA-J-55U	RG-55/U

SMA-115



ADAPTER PANEL JJ

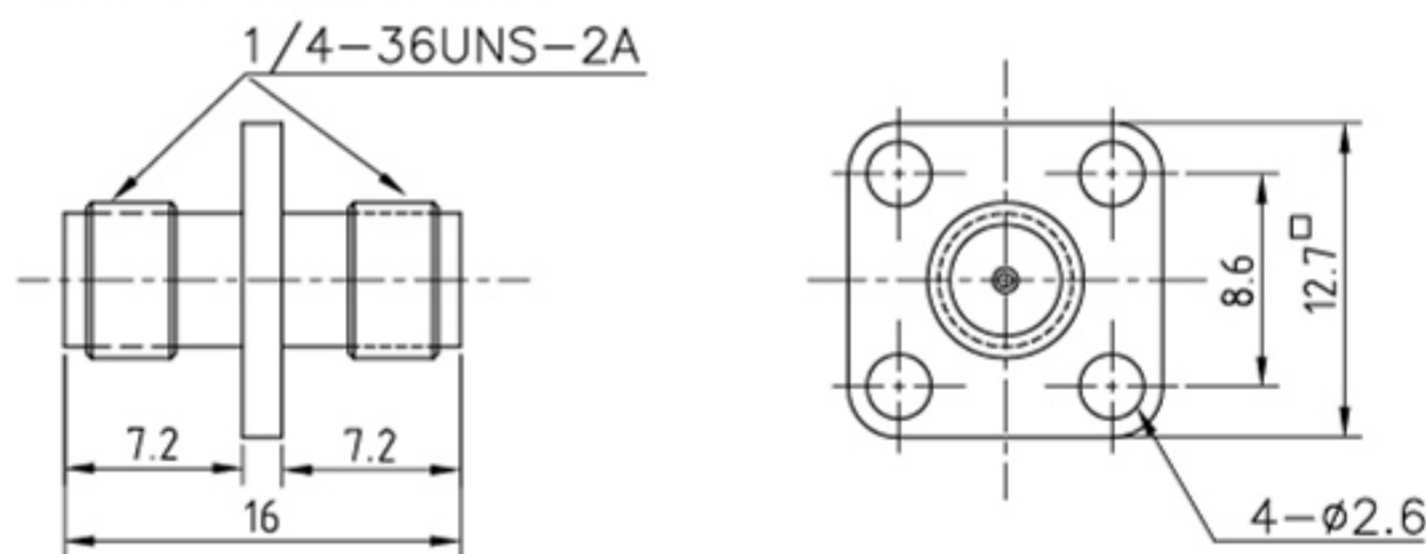

SMA-116



PANEL RECEPTACLE PCB

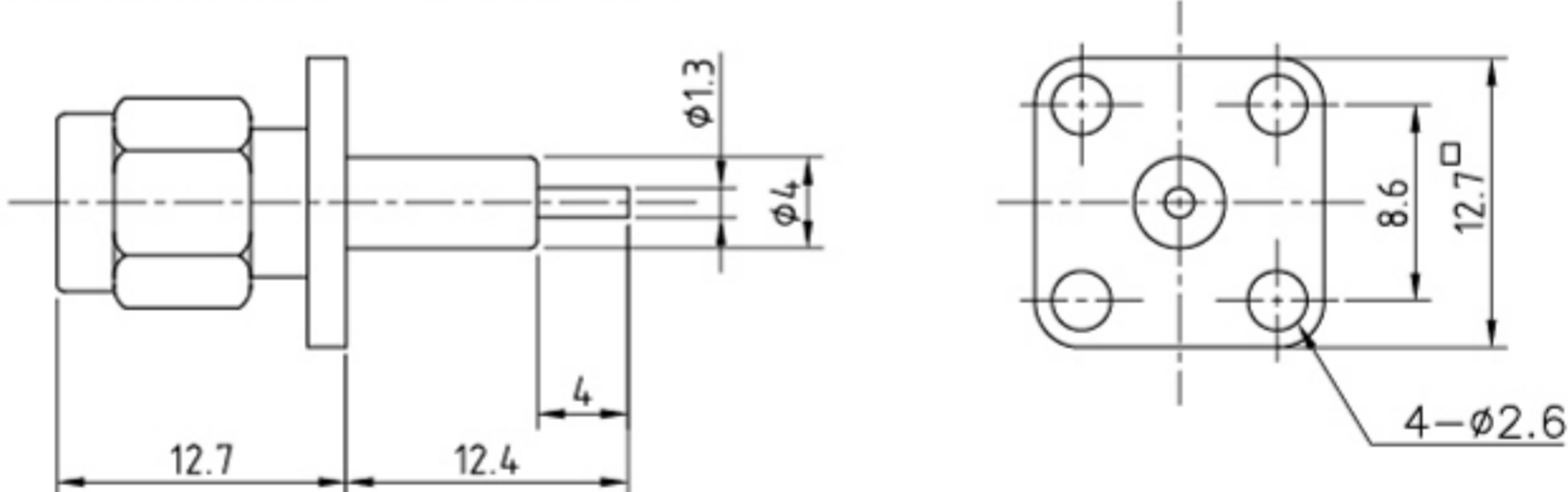

SMA-117



PANEL RECEPTACLE SOLDER

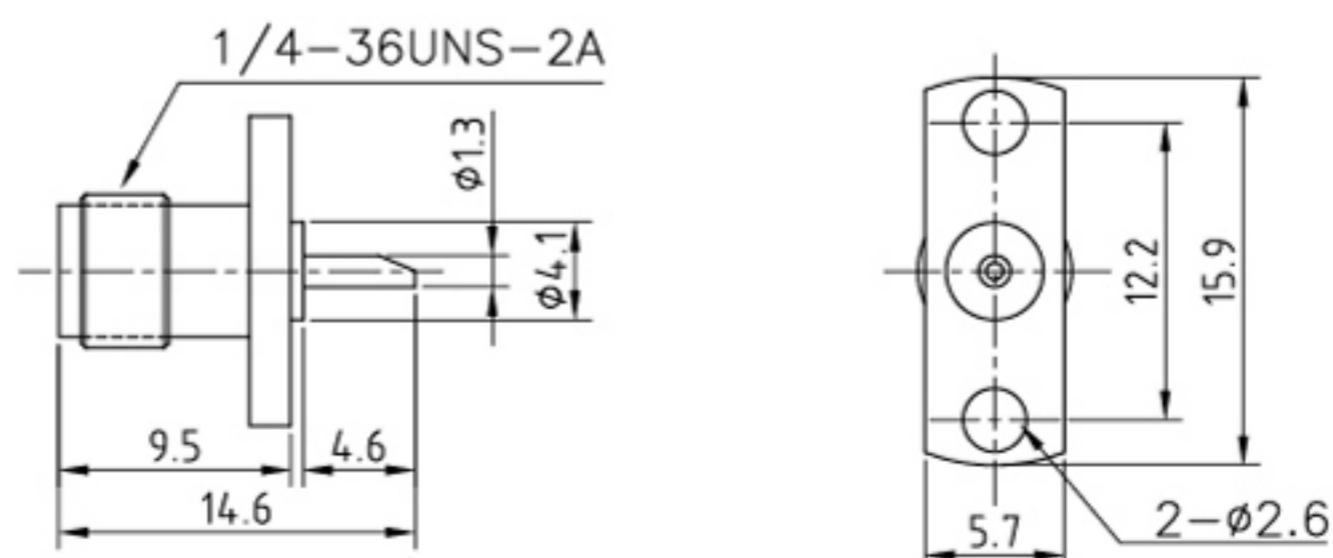

SMA-118



**PANEL RECEPTACLE PCB**

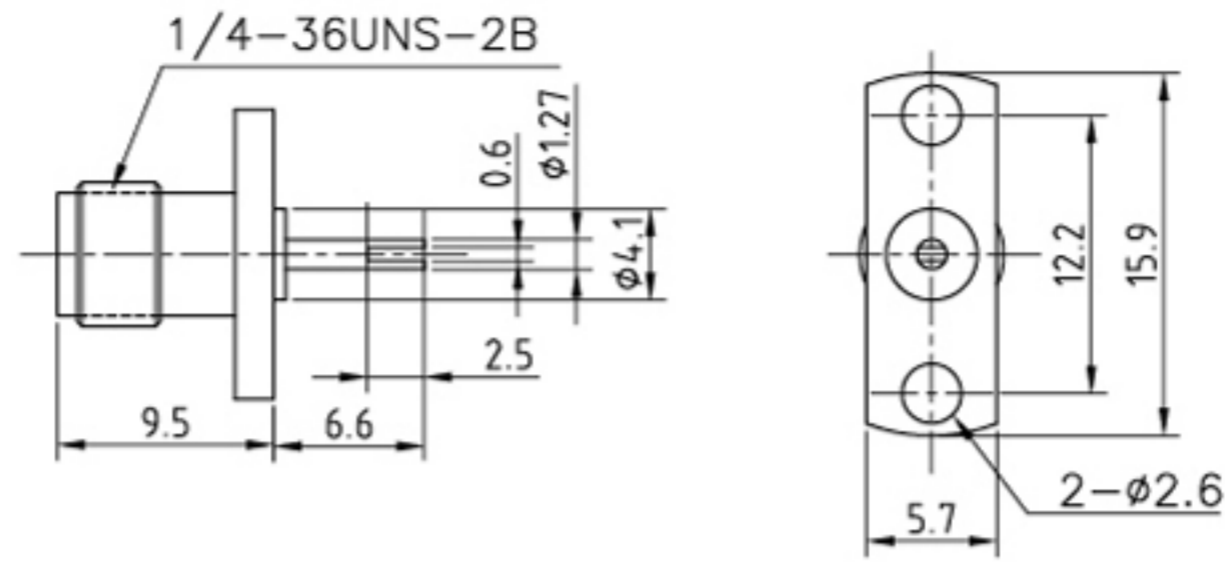

SMA-119



**ADAPTER PLUG-TA-JJ**

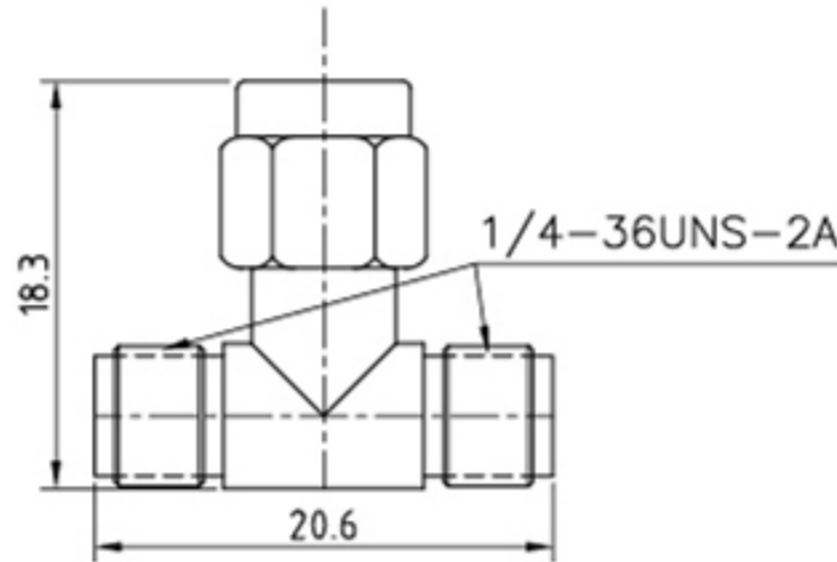

SMA-120



**ADAPTER JACK-TA-JJ**

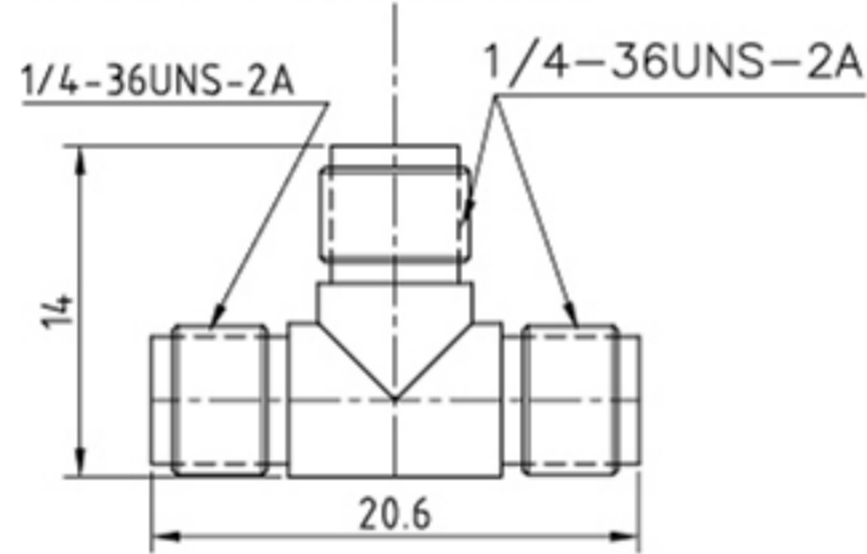

SMA-121



**RECEPTACLE**

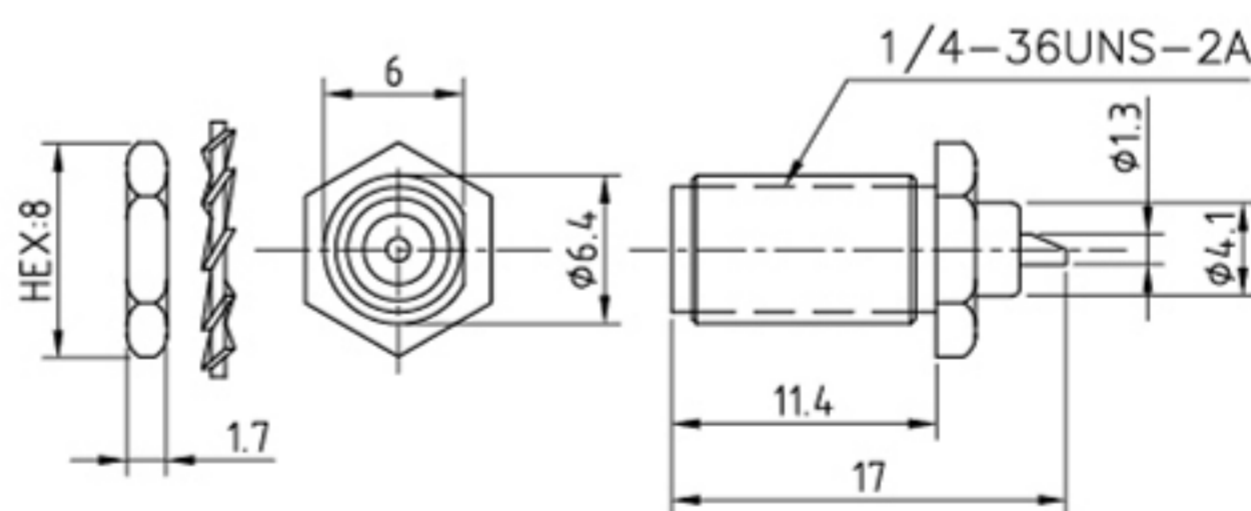

SMA-122



**ADAPTER JJ**

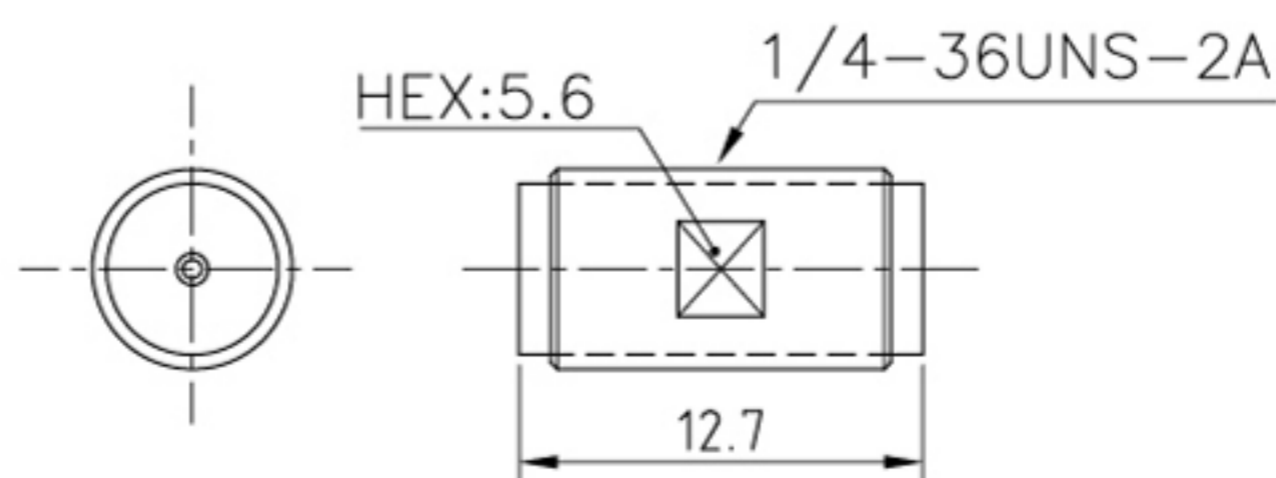

**SMA-123**



**ADAPTER JJ**

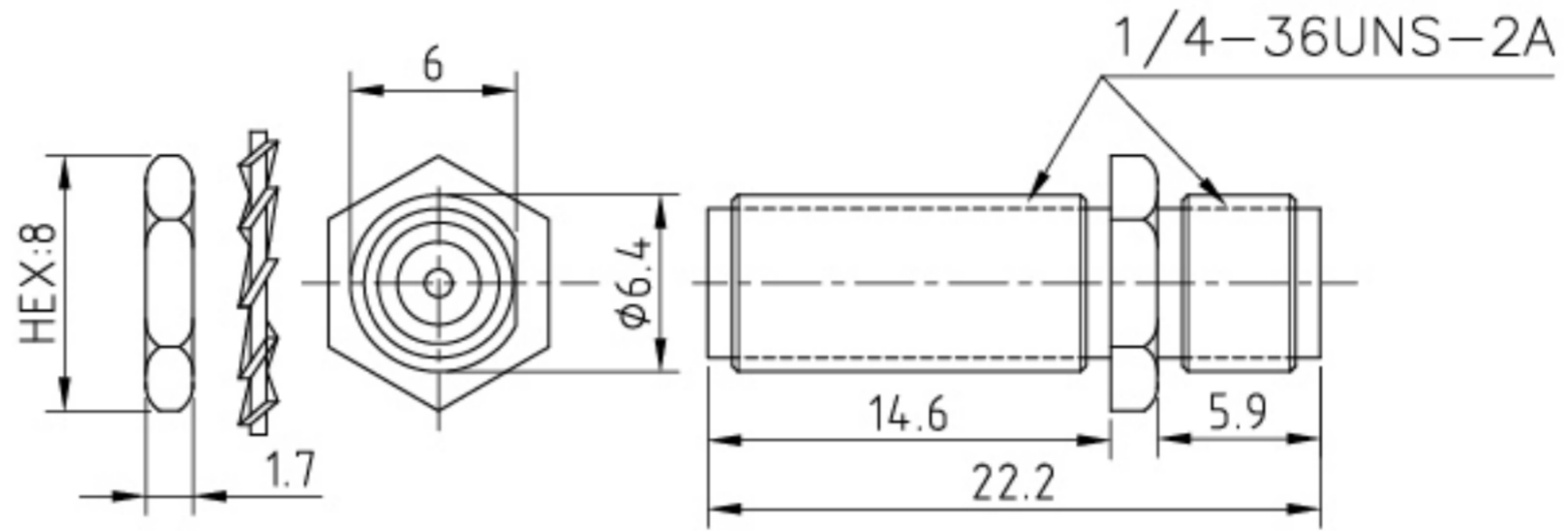

**SMA-125**



**SMA PLUG ANT RIGHT ANGLE**

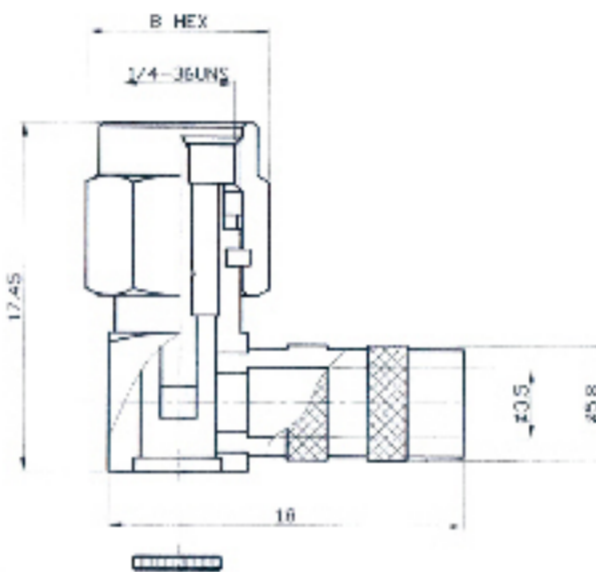

**SMA-132**



**RECEPTACLE PCB**

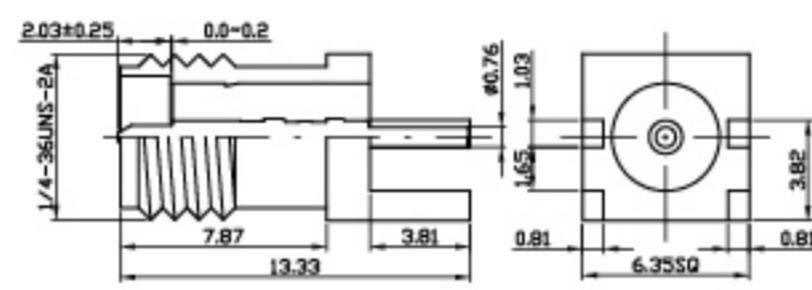

Model	Equivalent Identification	Cables for Use
SMA-132A	SMA-P-1.5D	1.5D-2V
SMA-132B	SMA-P-2.5D	2.5D-2V
SMA-132C	SMA-P-3D	3D-2V

**SMA-134**



**SMA CABLE RG/58U CRIMPPLUG**

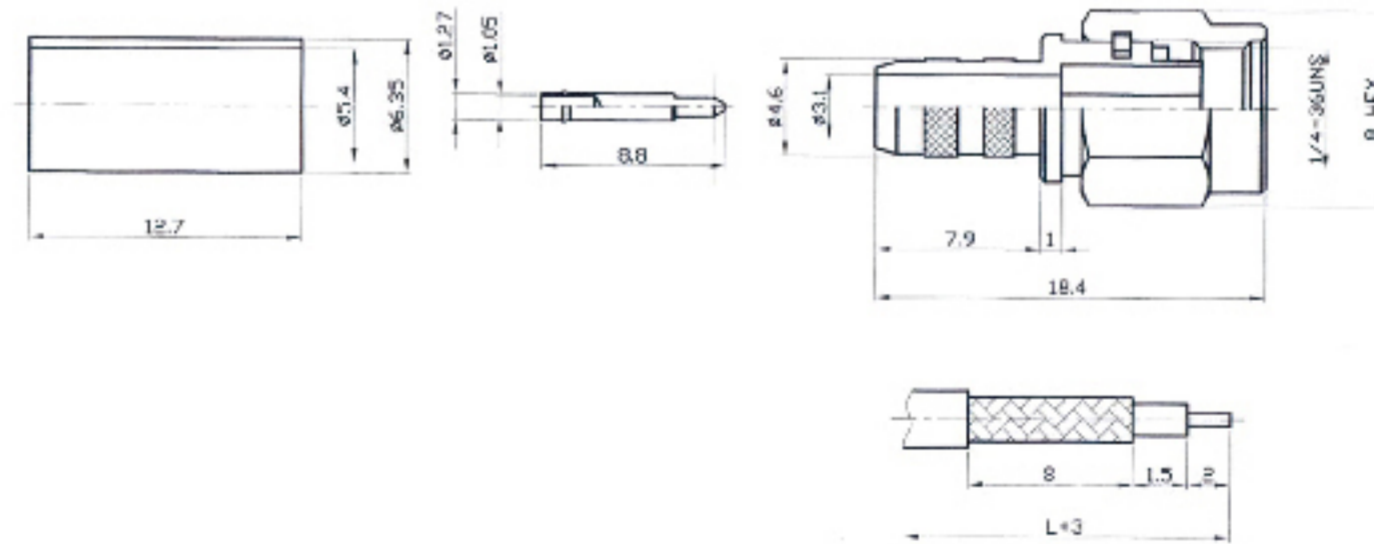

**SMA-136**



**SMA CRIMP PLUG RG/316U RIGHT ANGLE**

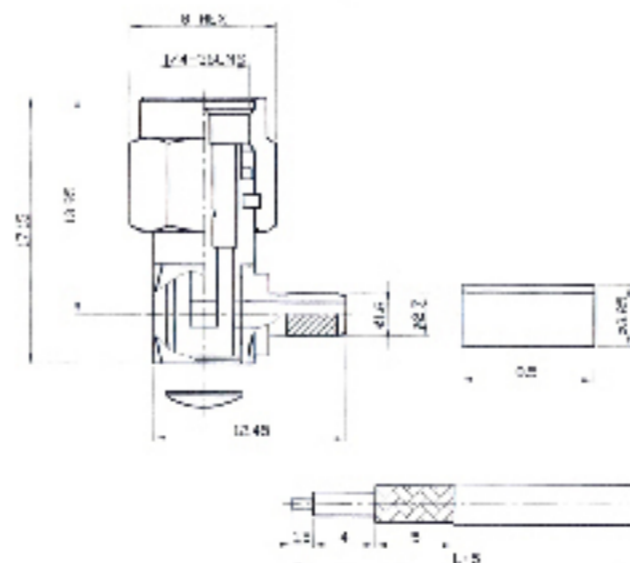

SMA-139



**SMA CABLE BULKHEAD CRIMP JACK**

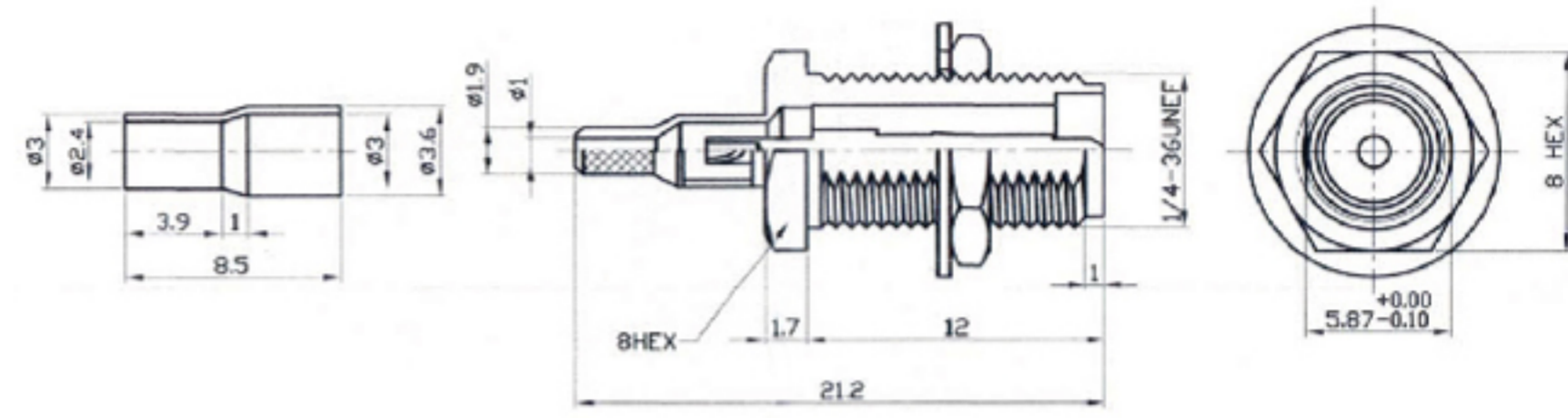

SMA-141



**RECEPTACLE PCB**

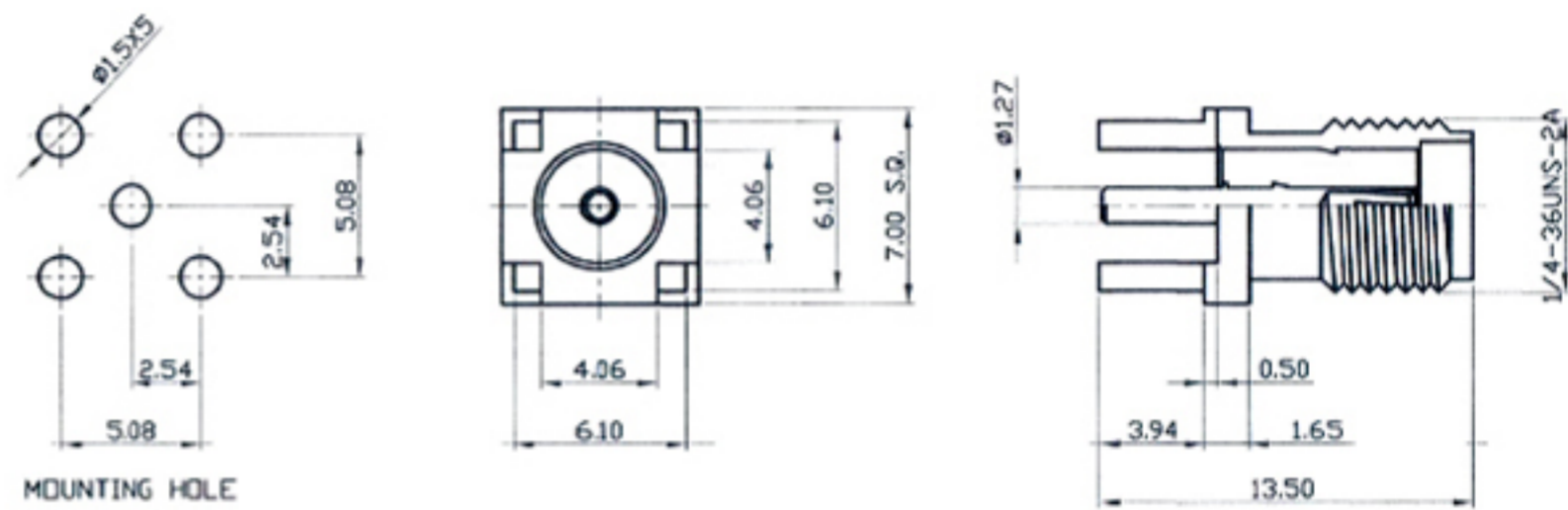

SMA-142



**RECEPTACLE PCB**

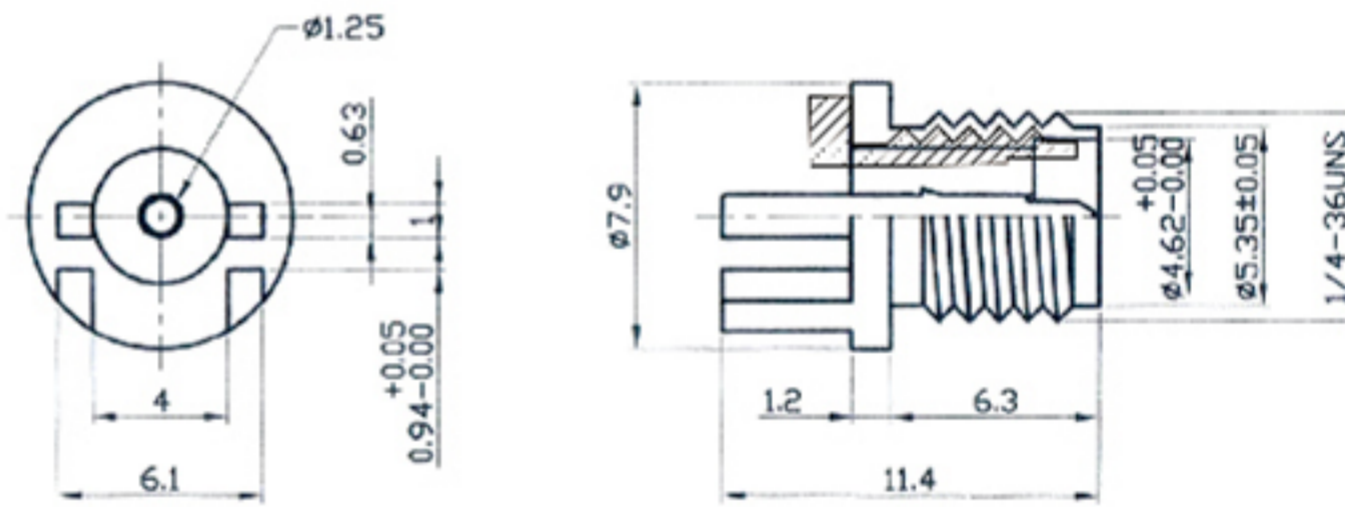

SMA-143



**SMA P.C.B EDGE MOUNT RECEPTACLE JACK**

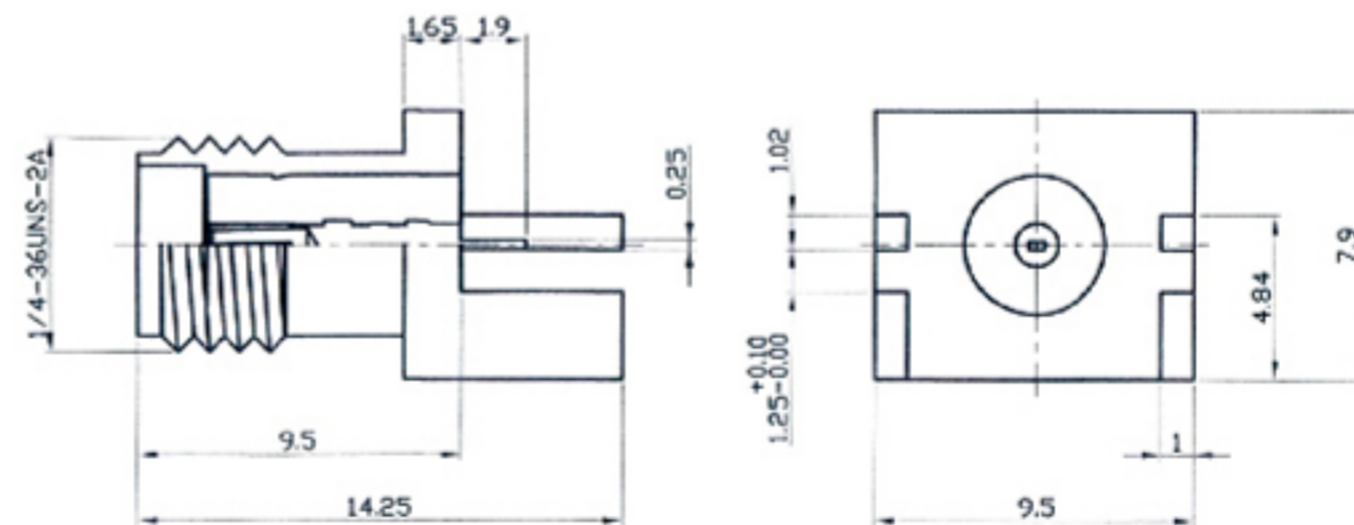

SMA-144



**SMA P.C.B EDGE MOUNT RECEPTACLE JACK**

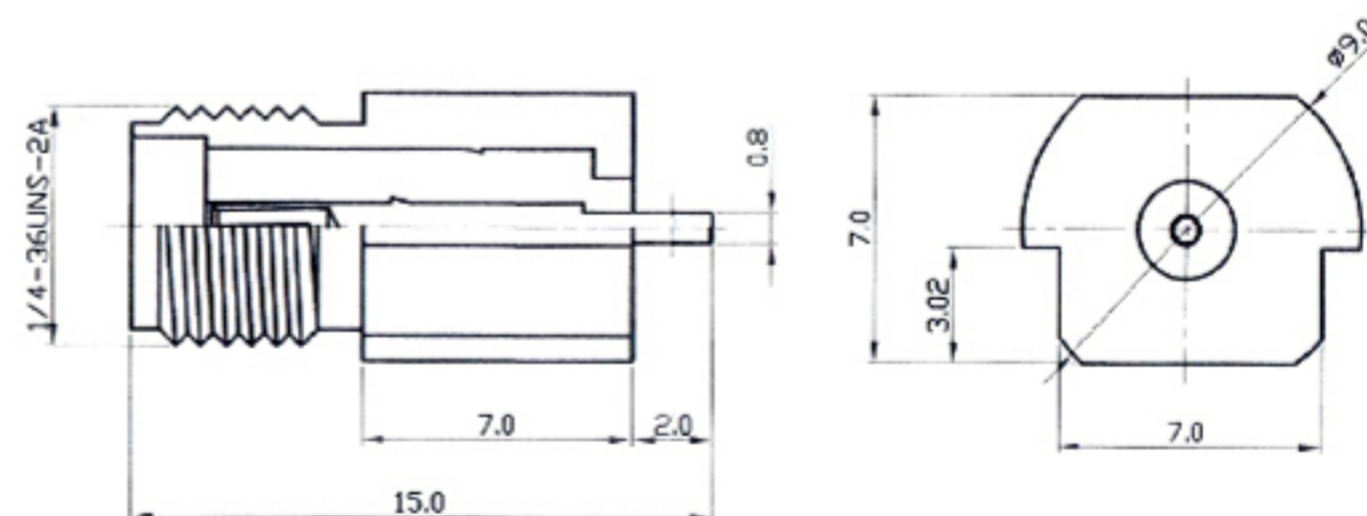

SMA-145



SMA P.C.B EDGE MOUNT RECEPTACLE JACK

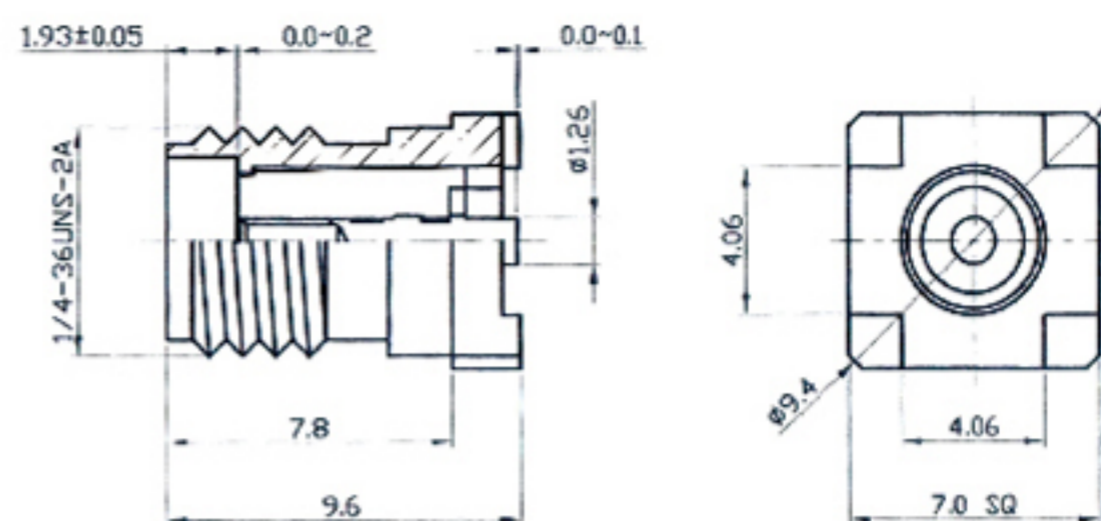

SMA-146



SMA P.C.B EDGE MOUNT RECEPTACLE JACK

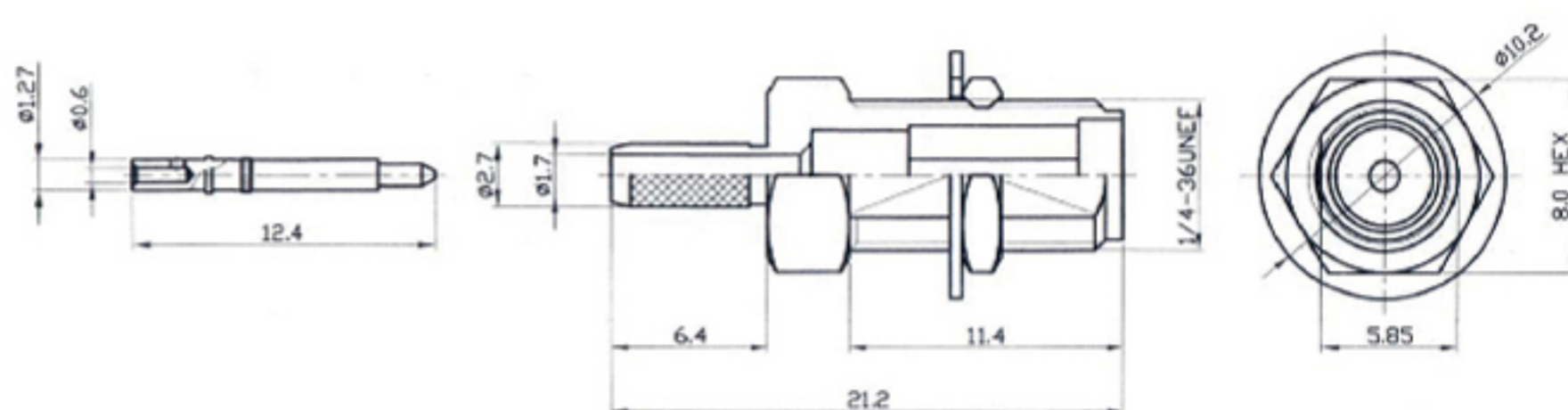

SMA-501A



SMA ANTENNA

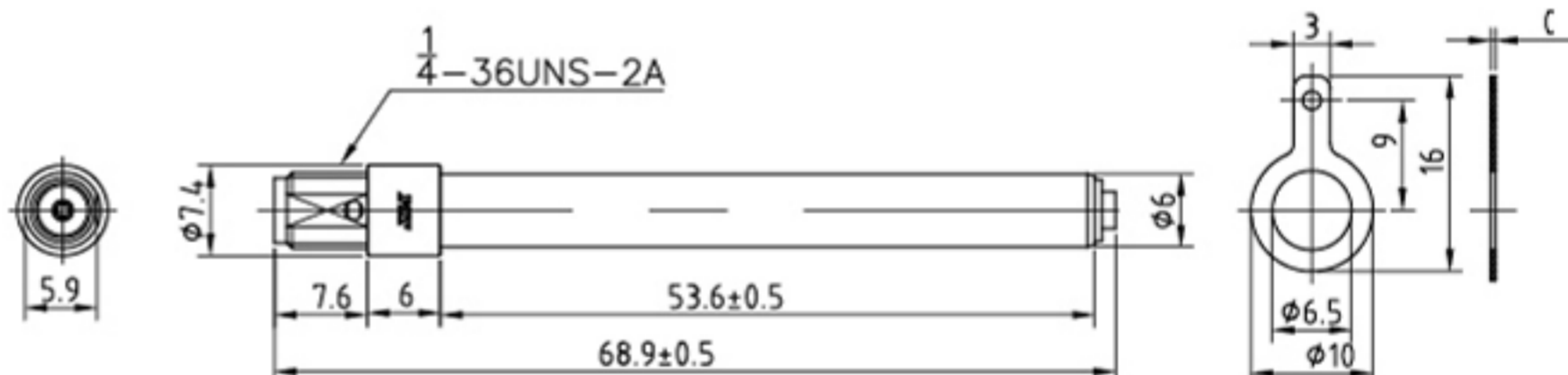

SMA-801A



ADAPTER SMAP-BNCP

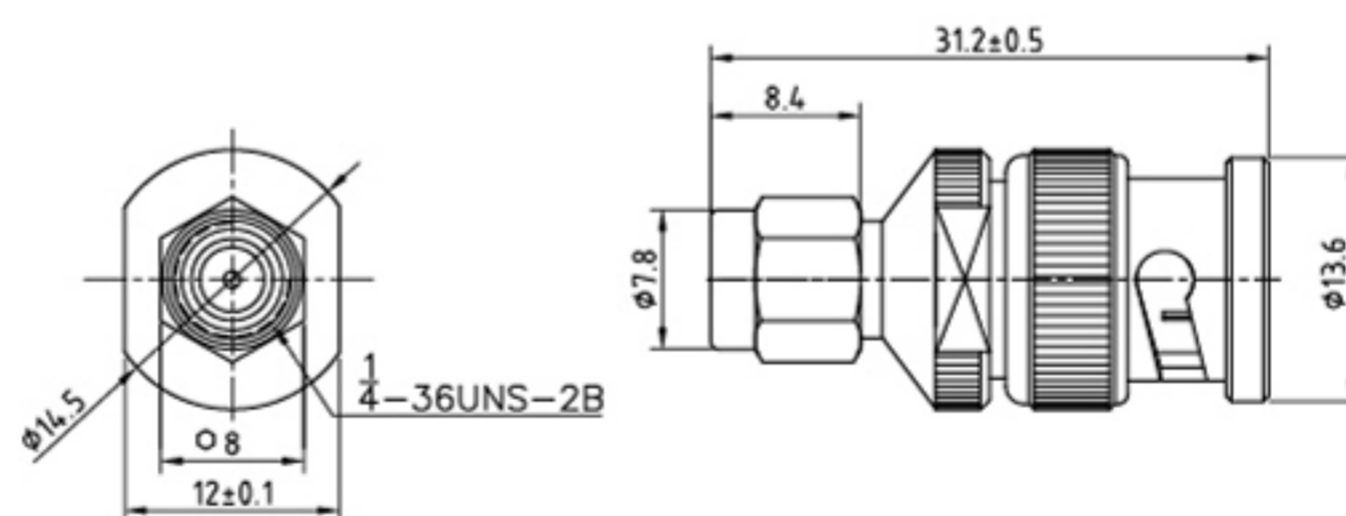

SMA-802A



ADAPTER SMAP-BNCJ

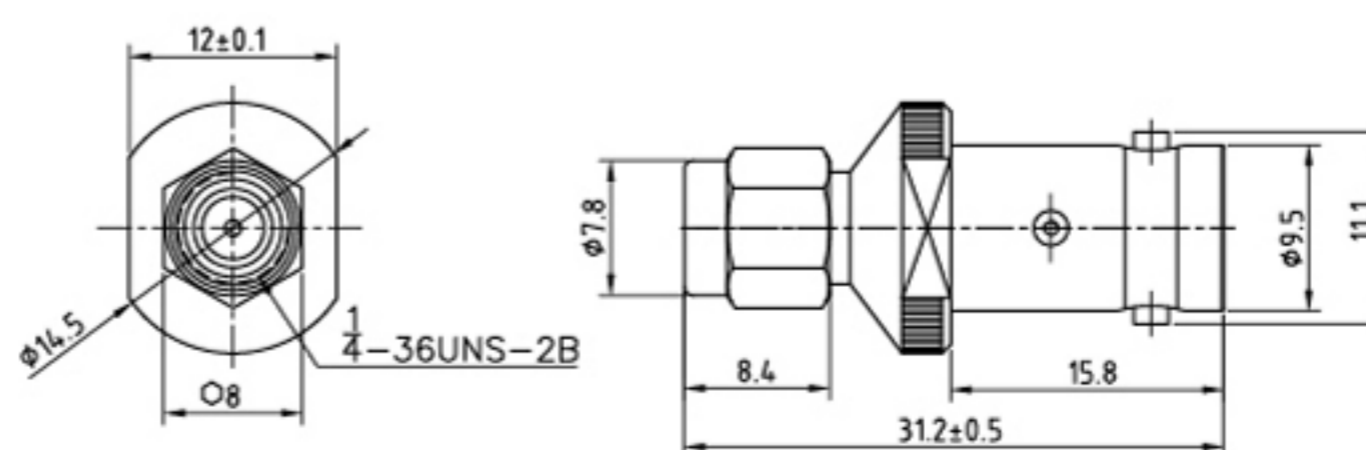

SMA-803A



**ADAPTER SMAJ-BNCP**

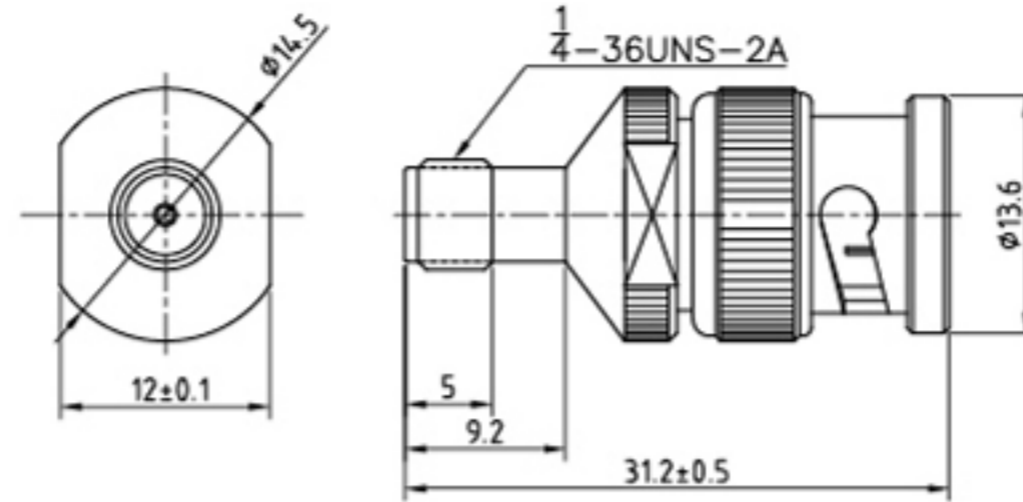

SMA-804A



**ADAPTER SMAJ-BNCJ**

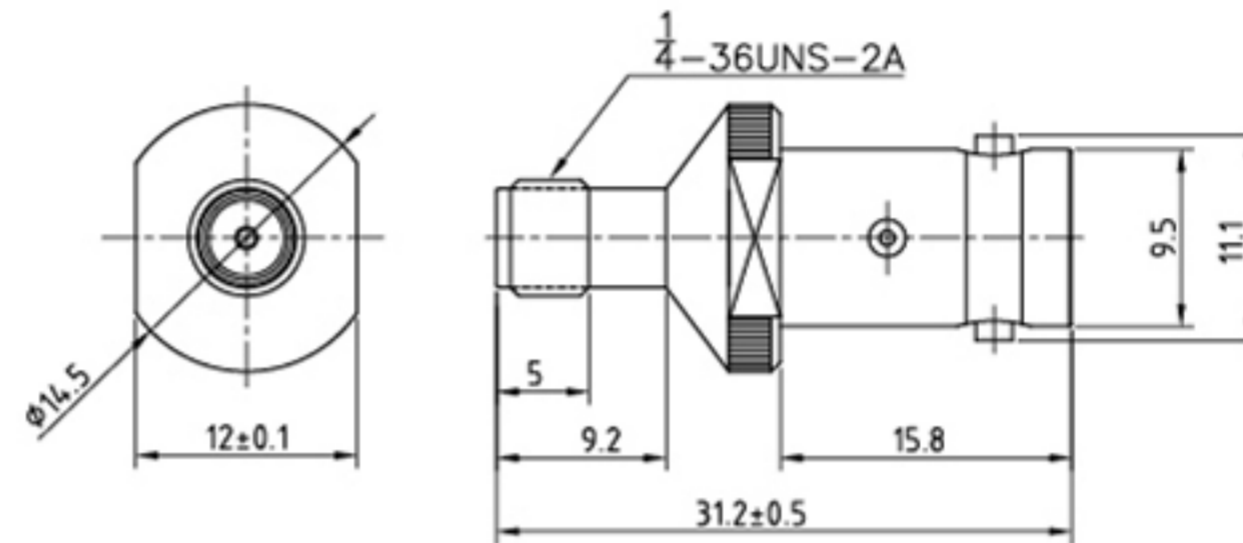

SMA-807A



**SMA PLUG TO TNC JACK ADAPTERS**

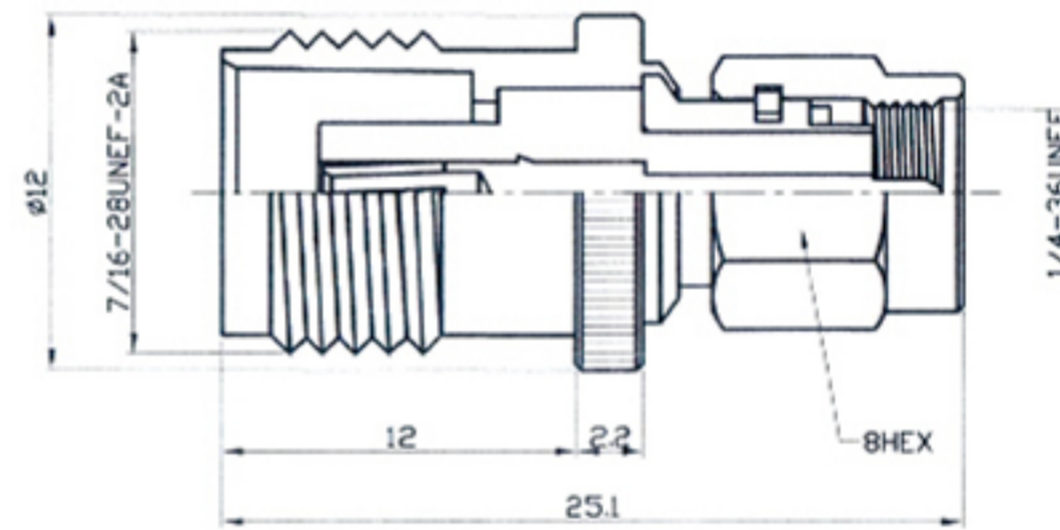

SMA-808A



**SMA JACK TO BNC JACK ADAPTERS**

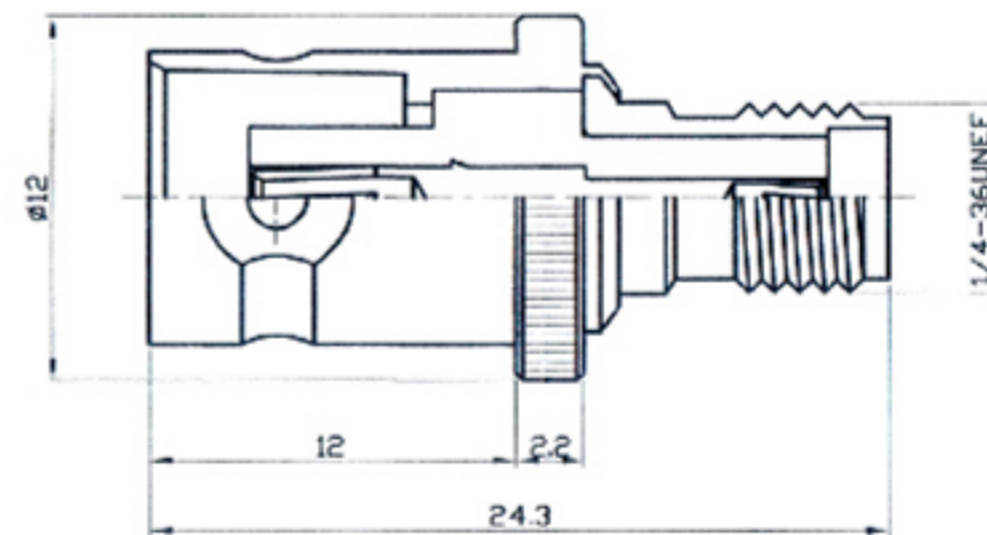

SMA-809A



**SMA PLUG TO BNC JACK ADAPTERS**

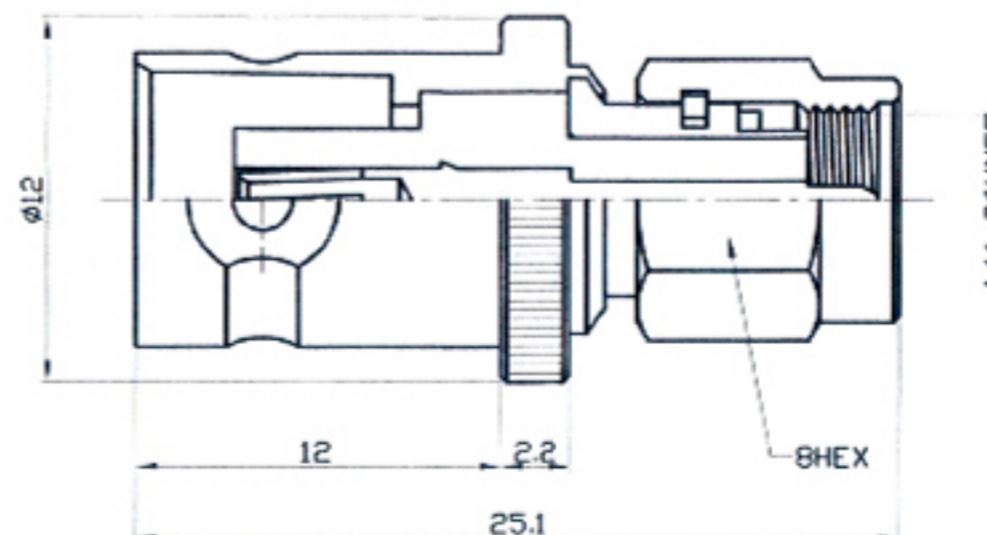

SMA-810A



SMA JACK TO TNC JACK ADAPTERS

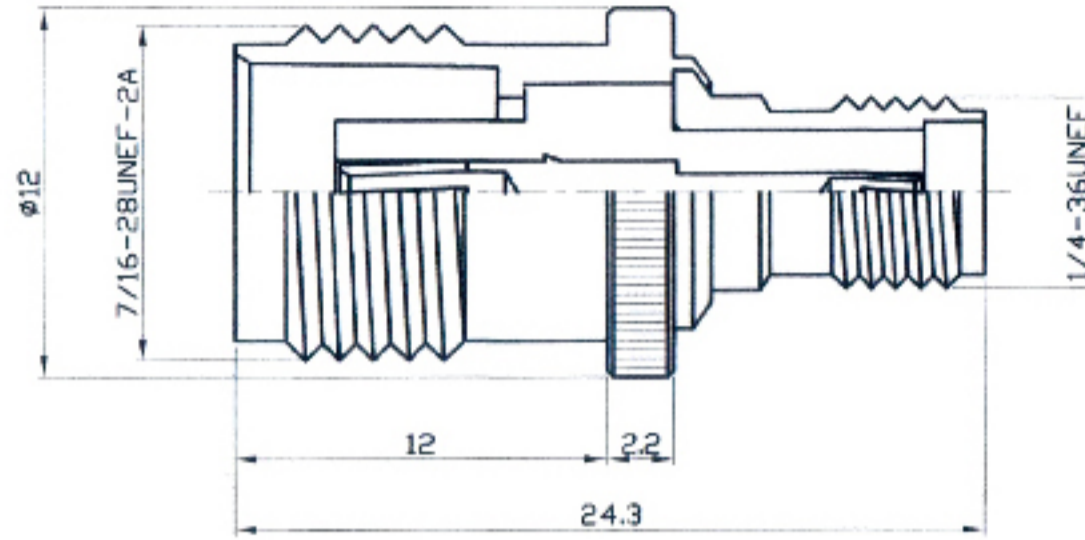

WA-1072A-R



SMA CABLE ASS'Y

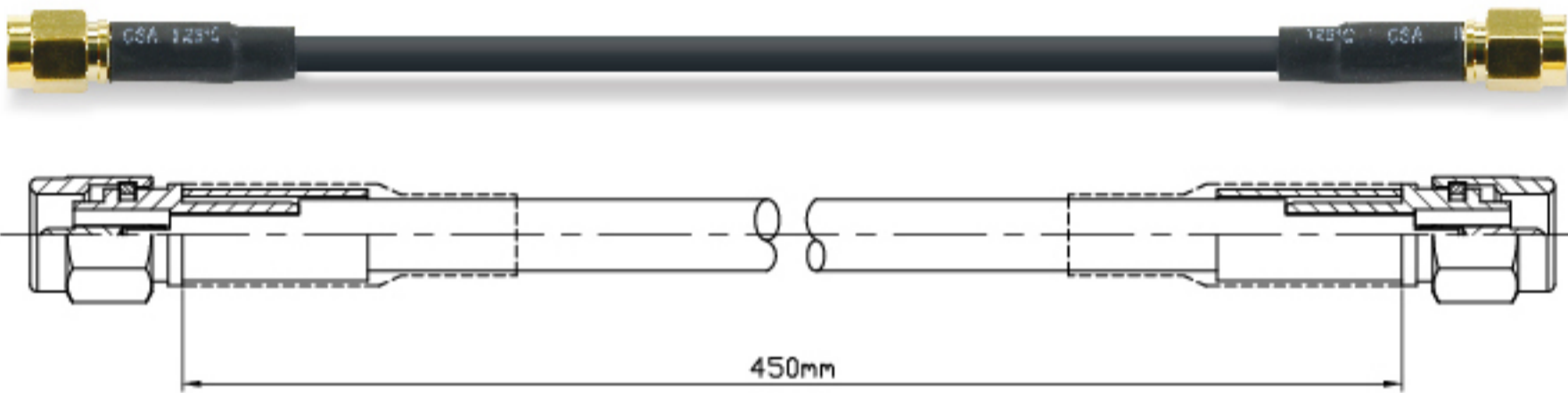

WA-1097A-R



CABLE 1.13M/M ASS'Y SMT PLUG TO SMA JACK BULKHEAD

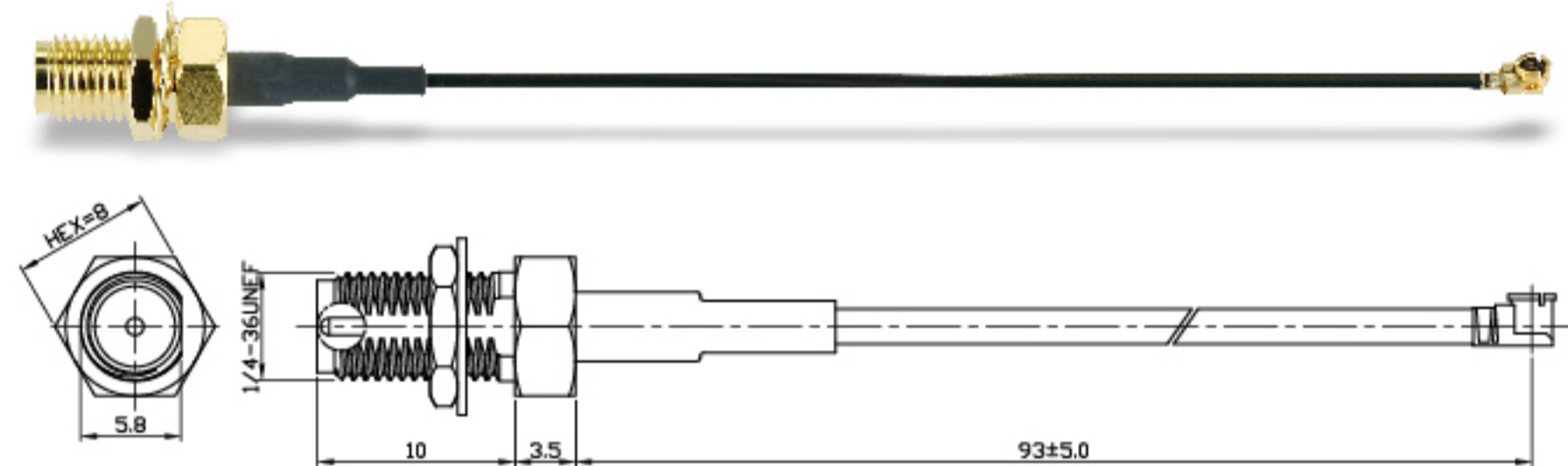

SMA-126C



SMA ANT CONNECTOR

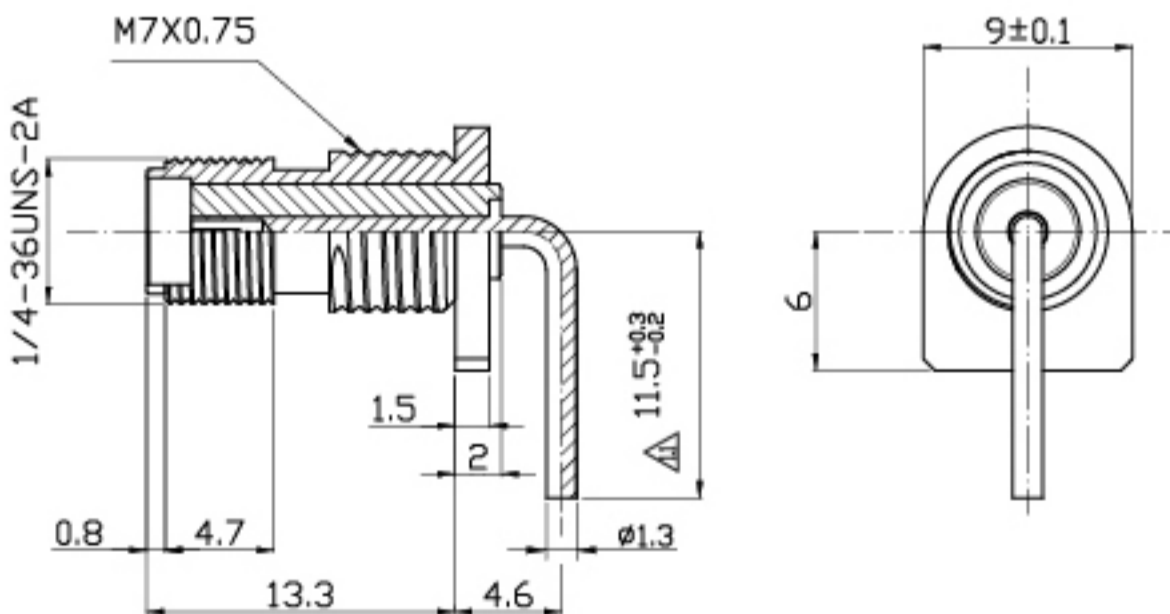

## ORDERING INFORMATION

### SMB - 101A - B G G T

**SMB SERIES**

**MODEL NO.**

**CABLE SIZE / TYPE**

**BODY MATERIAL**

B	COPPER ALLOY
Z	ZINC ALLOY
S	STAINLESS

**BODY PLATING**

C	CHROME
G	GOLD
S	SILVER
N	NICKEL

**INSULATOR**

D	DELTRIN
T	TEFLON
P	PLASTIC
PB	PBT POLYESTER
PH	PHENOLIC

**PIN PLATING**

C	CHROME
G	GOLD
S	SILVER
N	NICKEL

### Electrical Specifications

- Impedance : 50 ohm
- Connections : Push-ON
- Frequency Range : 0-4 GHz
- Insulation Resistance : 1,000MΩ min. at DC 500V
- Dielectric Withstanding Voltage : 1000V AC per minute
- Contact Resistance : Between internal conductors 5mΩ max / Between outer conductors 1mΩ max

SMB-101



**RECEPTACLE PCB**

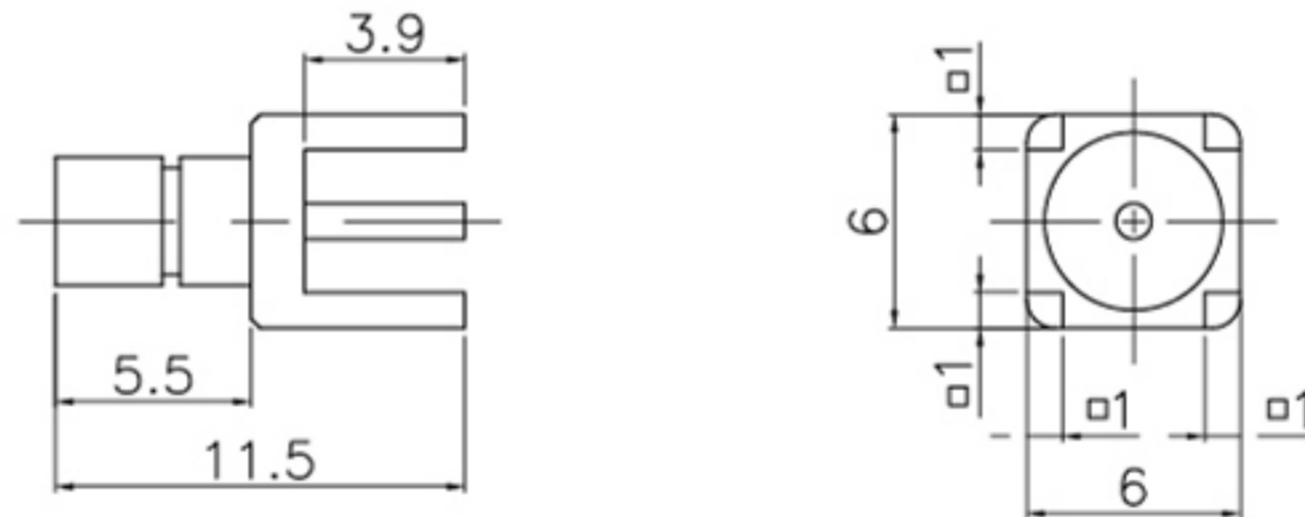

SMB-102



**R/A RECEPTACLE PCB**

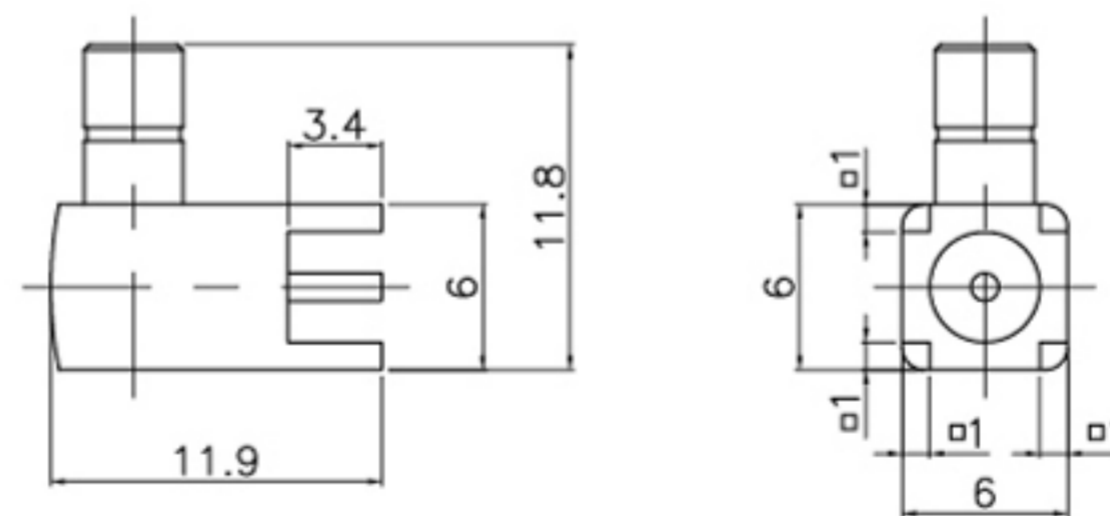

SMB-103



**RECEPTACLE SOLDER**

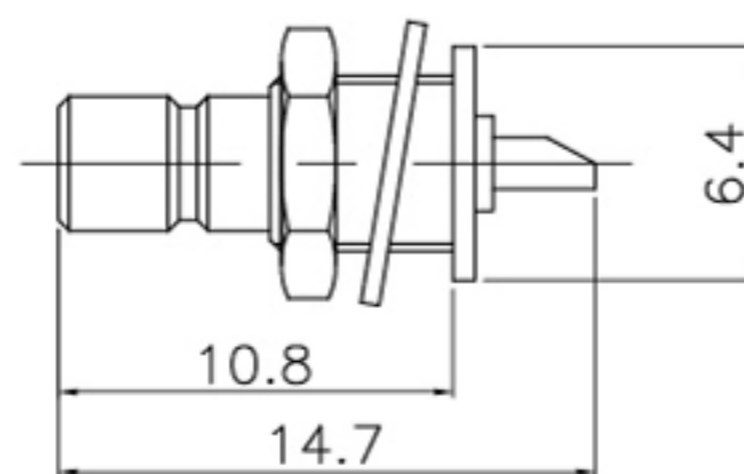



# ORDERING INFORMATION

## MMCX - 101A - B G G T

**MMCX SERIES**

**MODEL NO.**

**CABLE SIZE / TYPE**

**BODY MATERIAL**

B	COPPER ALLOY
Z	ZINC ALLOY
S	STAINLESS

**BODY PLATING**

C	CHROME
G	GOLD
S	SILVER
N	NICKEL

**INSULATOR**

D	DELTRIN
T	TEFLON
P	PLASTIC
PB	PBT POLYESTER
PH	PHENOLIC

**PIN PLATING**

C	CHROME
G	GOLD
S	SILVER
N	NICKEL

### Electrical Specifications

- Impedance : 50 ohm
- Frequency Range : 0-6 GHz
- Insulation Resistance : 500MΩ min.
- Dielectric Withstanding Voltage : 500V rms. min.
- Contact Resistance : Center contact 10mΩ max / Outer contact 5mΩ max

**MMCX-101**

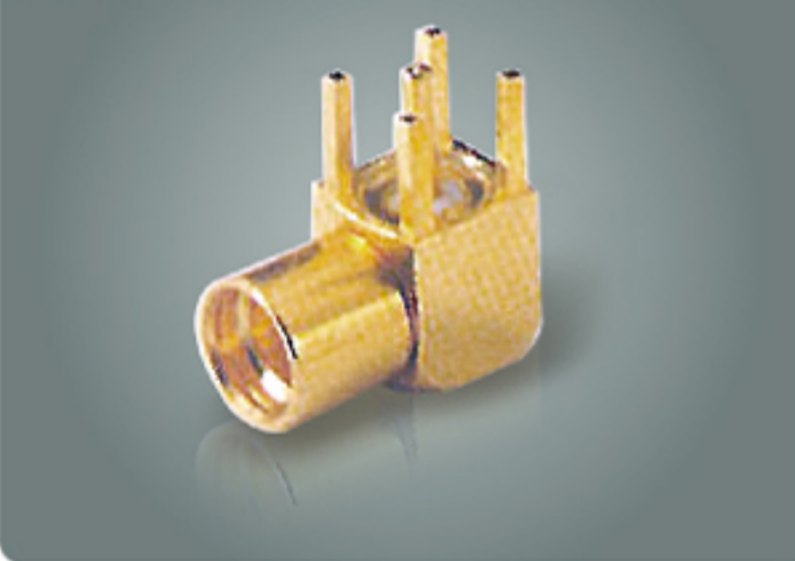

**RECEPTACLE R/A PCB**

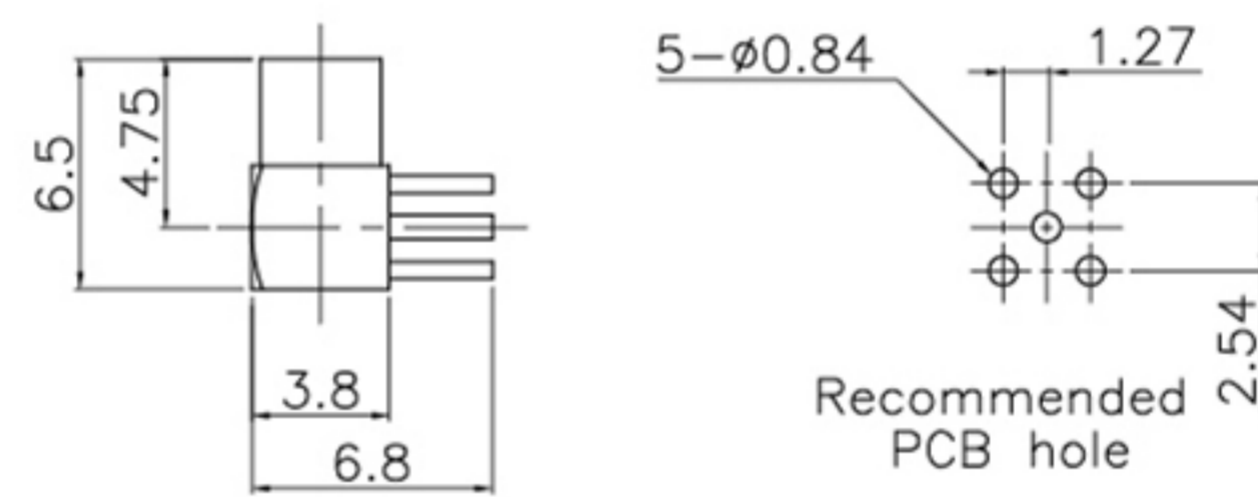

**MMCX-102**



**CRIMP CABLE PLUG**

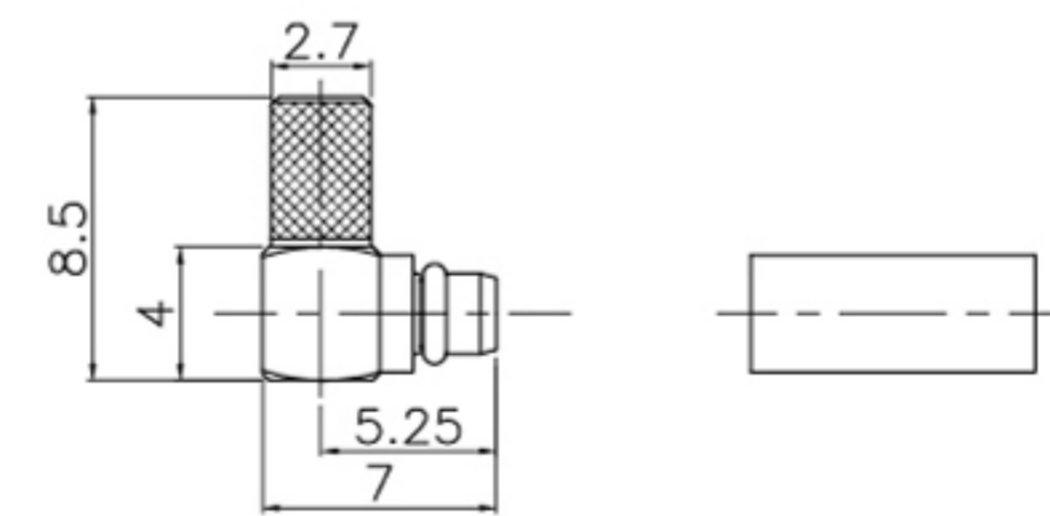

**MMCX-103**



**RECEPTACLE JACK**

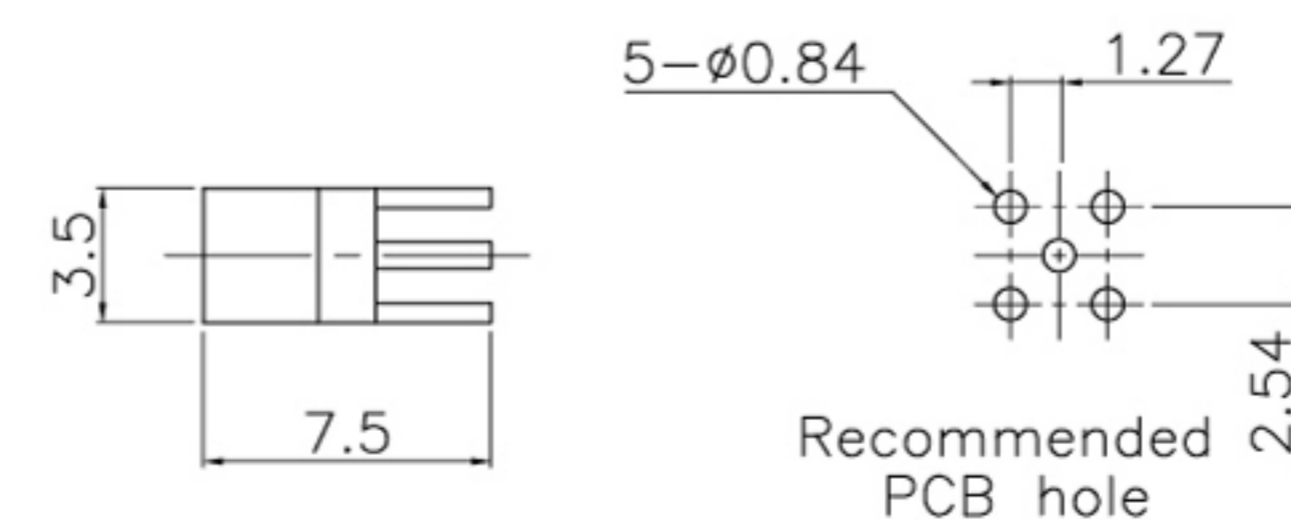

- 1.本目錄記載數據僅供參考，詳細內容請參考式樣書或圖面。
- 2.本目錄記載內容為了改進產品如有變更，恕不另行通知敬請見諒。

1.The product information in this catalog is for reference only.  
Please request the engineering drawing for the most current and accurate design information.

2.In order to make improvements in the products,we reserve the right to make changes,  
updates and corrections to the information provided in this catalog at any time.  
Subject to change without notice. Thank you for your understanding.



Manufacturer

OEM / ODM

**APEX PRECISION TECHNOLOGY CORP.**  
**錫鋼精密科技股份有限公司**

總公司/總廠 : 24264 新北市新莊區民安西路405號 E-mail: apexmail@plt.com.tw  
Headquarters No. 405, Min-an W. Rd., Sinjhuang District, New Taipei City 24264, Taiwan  
TEL : +886-2-2206-8899 FAX : +886-2-2208-0559

台中/大雅廠 : 42844 台中市大雅區民生路3段191巷4號、6號、8號  
Taichung Plant No. 8, Lane 191, Section 3, Minsheng Rd., Daya District, Taichung City 42844, Taiwan  
TEL : +886-4-2560-7272 FAX : +886-4-2565-2228

日本公司 : 株式会社 PLT JAPAN Technology R&D / Import & Export  
Japan Office 〒151-0053 東京都渋谷区代々木3丁目28番-1・28-1, Yoyogi 3-Chome, Shibuya-ku, Tokyo, Japan  
TEL : +81-3-6276-8845 FAX : +81-3-6276-6645 日本携帯電話 : +81-80-4166-2688

**AS9100D** 航太國防工業品質管理系統認證通過  
QUALITY MANAGEMENT SYSTEMS -  
REQUIREMENTS FOR AVIATION, SPACE,  
AND DEFENSE ORGANIZATIONS

**IATF 16949** 全球汽車產業品質管理系統認證通過  
CERTIFIED IN GLOBAL AUTOMOBILE INDUSTRY

**ISO 14001** 國際環境管理系統認證通過  
ENVIRONMENTAL MANAGEMENT SYSTEMS

**ISO 9001** 國際品質管理系統認證通過  
QUALITY MANAGEMENT SYSTEMS

**ISO/TS 22163** 國際鐵路行業標準認證通過  
INTERNATIONAL RAILWAY INDUSTRY STANDARD