

 Aviation
  Automobile
  Energy
  Boats
  Rails
  Medical

APEX CONNECTORS

100% MADE IN TAIWAN

WATERPROOF

M12 M8

M23



Apex connector
專業製造廠

鋁鋼精密科技

APEX PRECISION TECHNOLOGY

Since 1978



M8-G-5015 APEX PRECISION TECHNOLOGY CORP. E124783 AWM STYLE 2464 VM-1 60°C 300V 24AWG WORLDWIDE CSA ANMM 1/2 A/B 60°C 300V LL-103324 FT1 FT2



APEX Enterprise and Nature Coexistence

Coexistence of human and nature is the highest enterprise principle to APEX.
All APEX's staff and operation must be based on the premise of preserving natural environment and protecting the earth.

- Manufacturing the low-pollution products
- Manufacturing without polluting the environment
- Recycle and reuse
- Contribution to protecting the earth
- Development of environmental protection

1. The product information in this catalog is for reference only.

Please request the engineering drawing for the most current and accurate design information.

2. In order to make improvements in the products, we reserve the right to make changes, updates and corrections to the information provided in this catalog at any time.

Subject to change without notice. Thank you for your understanding.



APEX 企業與自然共存

APEX 應該視(人類和地球自然環境共存)為企業最高指導的原則，
所有的APEX職員和企業的全部運作，都要以維護自然環境、保護地球為前提。

- 製造低污染的產品
- 製造處理不汙染環境
- 所有的廢棄物回收再利用
- 為保護地球環境，貢獻一份心力
- 持續環境保護發展的工作

1. 本目錄記載數據僅供參考，詳細內容請參考式樣書或圖面。

2. 本目錄記載內容為了改進產品如有變更，恕不另行通知敬請見諒。

APEX企業は自然と共存します

APEXはずっとく人類と地球の共存する環境を企業最高指導の原則とし、
全てのAPEX社員及び企業の活動は全て地球環境の保護、維持を前提としております。

- 汚染の少ない製品作り
- 製造プロセスでは環境汚染を下げる
- すべての廃棄物は回収または再利用する
- 地球環境保護のため、気力を持って貢献する
- 環盡保護發展の仕事を持続する

1. 本カタログ記載の数値につきましては、参考数値です。詳しい内容につきましては、仕様書、図面を参考して下さい。

2. 本カタログ記載内容は、製品向上のため予告なく変更する事がありますのでご了承下さい。

M8 Series

IP67

	M-631-PML-R M-641-PML-R	8
	M-642-PML-R M-631-PMDL-R M-641-PMDL-R	8
	M-642-LPML-R M-631-LPMDL-R M-641-LPMDL-R	8
	M-631/M-641/ M-642-PMP-R	8
	M-631/M-641/ M-642-PM-R	8
	M-641-RM-R	8
	M-631/M-641/ M-642-PF-R	8
	M-631/M-641/ M-642-PFL-R	8
	M-631/M-641/ M-642-LPFL-R	8
	M-631/M-641/ M-642-RFL-R	8
	A-606PX	8

M8 Series

IP67

	M-641-PFB-R	8
	WA-637 A-R	9

M61 Series

IP65

	M-61◇R-R	10
	M-61◇RA-R M-61◇RL-R	10
	M-61◇A-R	10
	M-61◇DL-R	10
	M-61◇E-R	10

M12 Series

IP67

 SHELL: ZINC DIE-CASTING (鋅合金壓鑄)	M-D62◇-PM-R D-CODE	11
	M-D62◇-RFA-R	11

M12 Series



	M12 Series Straight Cable Ass'y M-62 ◆ -PFL-R	12
	M12 Series Straight Cable Ass'y M-62 ◆ -PML-R	12
	M12 Series Straight Cable Ass'y M-62 ◆ -PFGL-R	12
	M12 Series Straight Cable Ass'y M-62 ◆ -PMGL-R	12
	M12 Series Straight Cable Ass'y M-62 ◆ -PF-R	12
	M12 Series Straight Cable Ass'y M-62 ◆ -PM-R	12
	M12 Series Right Angle Cable Ass'y M-62 ◆ -LPFL-R	13
	M12 Series Right Angle Cable Ass'y M-62 ◆ -LPML-R	13
	M12 Series Right Angle Cable Ass'y M-62 ◆ -A-LPFL-R	13
	M12 Series Right Angle Cable Ass'y M-62 ◆ -A-LPML-R	13

M12 Series



	M12 Series Receptacle Female M-62 ◆ -RF-R	14
	M12 Series Receptacle Female M-62 ◆ -RFA-R	14
	M12 Series Receptacle Female M-62 -RCa-R	14
	M12 Series Receptacle Female M-62 ◆ -RFB-R	14
	M12 Series Receptacle Female M-62 ◆ -RFC-R	14
	M12 Series Receptacle Male M-62 ◆ -RMA-R	15
	M12 Series Receptacle Female M-62 ◆ -A-GP-R	15
	M12 Series Receptacle Male M-62 ◆ -RMB-R	15
	M12 Series Receptacle Male M-62 ◆ -RMC-R	15
	M12 Series Receptacle Male M-62 ◆ -RMJ-R	15
	M12 Series A-607PX	15

M12 Series

 IP67

	 IP67 M12 Series Receptacle Male M-62 ◆ -RMD	16
	 IP67 M12 Series Receptacle Male M-62 ◆ -RME	16
	 IP67 M12 Series Receptacle Male M-624/626 ◆ -RME M-625/628 ◆ -RME	16
	 IP67 M12 Series Receptacle Male M-62 ◆ -RMH	16
	 IP67 M12 Series Receptacle Male M-62 ◆ -RMS <small>SHELL: STAINLESS STEEL (不鏽鋼)</small>	16
	 IP67 M-62 ◆ SP-PF-R	17
	 IP67 M-62 ◆ SP-PM-R	17
	 IP67 M-X628-PMA-R M-X628-RFA-R	17
	 IP67  PAT M-623T5-ADP-R	18
	 IP67  PAT M-623A-PF	18

654 Series

 IP67

	 IP67 WA-782A-R	19
	 IP67 M-655-RM	19
	 IP67 M-654-RFO	19

WPS Series

 IP67

	 IP67  PAT AMS3126A WPS3112E	21
	 IP67  PAT WA-987C-R	21
	 IP67 WPS-236A-PF	22
	 IP67 WPS-236A-RM WPS-236A-LPF	22

WPM Series

 IP67
 IP68

	 IP67 WPM06B-9-16S	23
	 IP67 WPM02A-9-16P	23

WPM Series

IP67
IP68

	WPM16A11-6PL-R	24
	WPM16A11-6SL-R	24
	WPM16A11-6R-R	24
	WPM16C12- S-R WPM16C12- P-R	25
	WPM-19 ♦ -PM-R WPM-19 ♦ -PF-R WPM-19 ♦ -RF-R WPM-19 ♦ -RM-R	26
	WPM-19 ♦ -RCa-R	26
	WPM-19 ♦ -SPM-R WPM-19 ♦ -SPF-R	27
	WPM-20 ♦ -PM-R WPM-20 ♦ -PF-R WPM-20 ♦ -RF-R WPM-20 ♦ -RM-R	28
	WPM-20 ♦ -WGPM2.5-R WPM-20 ♦ -WGPF2.5-R	28
	WPM-20 ♦ -RCa-R	28

WPM Series

IP67
IP68

	WPM-20 ♦ -SPM-R WPM-20 ♦ -SPF-R	29
	WPM-20 ♦ -WSPM2.5-R WPM-20 ♦ -WSPF2.5-R	29
	WPM-20 ♦ -ADF-R WPM-20 ♦ -ADFA-R WPM-20 ♦ -ADM-R WPM-20 ♦ -ADMA-R	29
	PAT WPM-21 ♦ -RF-R WPM-21 ♦ -PM-R	30
	WPM-21 ♦ -PL-R	31
<p>SHELL: STAINLESS STEEL (不銹鋼)</p> 	WPM-21 ♦ -PF-R	31
	WPM-21 ♦ -RM-R	31
	PAT WPM-223 ♦ -PML-R	32
	PAT WPM-223-PM-R WPM-223-PMA-R	32
	PAT WPM-223-RF-R WPM-223-RFA-R	32

WPM Series

IP67
IP68

	WPM-305A-PF-R WPM-305A-RM-R	33
	WPM-24 ◆ -PM-R	34

WA Series

IP67

	WA-715A-R	35
	WA-738A	35
	WA-188A-R	35

PLP Series

IP65
IP67

	PLP-123-P9 (D-SUB)	36
	PLP-138P8A-R PLP-138R8A-R (RJ-45)	37
	PLP-138AD8A-R (RJ-45)	38

PLS Series

IP67

	PLS-28 ◆ -PFD-R PLS-28 ◆ -RM-R	39
	PLS-28 ◆ -RMA-R PLS-28 ◆ -PFA-R <small>SHELL: STAINLESS STEEL (不鏽鋼)</small>	39

WPS Series

IP67

	WPS-2407-LF WPS-2407-SF	40
	WPS-2407-LM WPS-2407-SM	40

OTHER Series

	N-301P-SXGT WA-948D	41
	WA-884A-R	41
	WA-885A-R	41
	WA-889A-R	41



■ IEC/EN 60529 為現今國際上最常引用作為產品外殼機構保護等級的規範，故也稱為“國際保護等級，IP Code”。

■ IEC/EN 60529, IP 碼構成

構成要件	IP	可防護下列直徑之物品完全進入 (Equipment)	描述 Description
第一字碼 固態微粒防護 (SOLIDS)	0	---	等同於直接暴露，無法保護接觸與外物入侵 No Protection
	1	>50 mm	可避免身體上任意大表面接觸，例如：手背，但無法防禦身體部位的有意接觸。 Protection against contact with large areas of the body (e.g. back of hand)
	2	>12 mm	可阻擋手指大小或相似大小之物體。 Protection against contact with fingers
	3	>2.5 mm	能阻止工具或粗電線進入。 Protection against tools or solid objects in the mentioned diameter
	4	>1 mm	隔絕多數電線伸入與細小尖端的工具。 Protection against wires or solid objects in the mentioned diameter
	5	防塵	並不完全防禦灰塵進入，但必須有足夠的數量才能對設備的正常運作造成影響。Protection against dust
	6	完全防塵	灰塵無法進入，完全防止接觸。Totally against dust

構成要件	IP	防護於 (Equipment)	測試條件及細節描述 Description
第二字碼 液體滲透防護 (WATER)	0	無防護	等同於直接暴露，無法保護接觸與液體滲透 No Protection
	1	垂直滴水	水量等同 1 mm/min，測試時間：10 分鐘 Protection against vertically falling drops
	2	傾斜15度滴水	水量等同 3 mm/min，測試時間：10 分鐘 Protection against direct sprays of water up to 15 degrees vertically
	3	加壓噴霧(垂直線60度內)	噴嘴測試 (水量：10L/min，水壓 50-150kPa，測試時間：10 分鐘) Protection against direct sprays of water up to 60 degrees vertically
	4	潑濺 (任何角度)	噴嘴測試 (水量：10L/min，水壓 50-150kPa，測試時間：10 分鐘) Protection against water spray from all directions
	5	低壓水柱 (任意角度)	噴嘴口徑 (6.3mm) 於3米處以12.5L/min水量持續噴水至少3分鐘 Protection against low-pressure jets of water with limited ingress requested from all directions
	6	高壓水柱 (任意角度)	噴嘴口徑 (12.5mm) 於3米處以100L/min 水量持續至少3分鐘 Protection against strong jets of water with limited ingress requested from all directions
	7	浸入水中最多一米	物件高度低於850mm，需低於水面1000mm；物件高度高於850mm，需低於水線150mm (測試時間：30分鐘) Protection against the temporary immersion 1M at the most
	8	浸入水中超過一米	測試深度買賣雙方協議 (測試時間：持續浸入水中至少1小時) Protection against the long period of immersion more than 1M
	9	高溫高壓水柱	水量：14-16L/min於0.10-0.15米，水壓8-10MPa，水溫80度C於四個角度下各30秒 (測試時間共2分鐘) Protection against high pressure, high temperature jets of water from multiple directions



ORDERING INFORMATION

M-624-PML-R

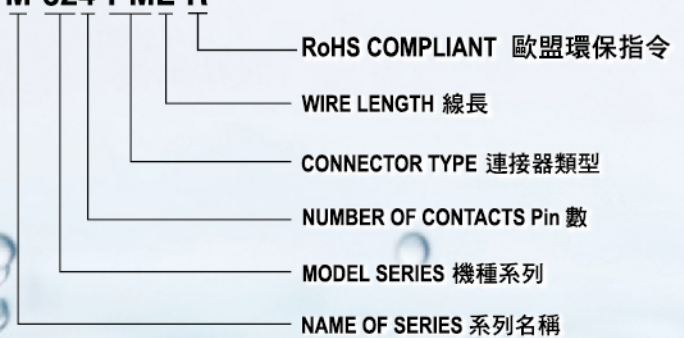

P:PLUG 插頭	R:Receptacle 插座	F:Female 導梢	M:Male 導針
---------------------	---------------------------	-----------------------	---------------------

MATERIAL & SURFACE

Description	Material	Surface
Shell / 外殼 本體	* Copper / 銅 * Stainless steel / 不鏽鋼 * Zinc alloy Die Casting / 鋅合金壓鑄 * Aluminum alloy Die Casting / 鋁合金壓鑄	* Chrome-plated / 鍍鉻 * Gold-plated / 鍍金 * Nickel-plated / 鍍鎳 * Silver-plated / 鍍銀
Insulator / 絕緣體	* Bakelite / 電木 * Delrin / 塑鋼 * Nylon / 尼龍	
Contact / 導針、導梢	* Copper / 銅 * Phosphor Copper / 磷青銅 * Berillium Copper / 鈹銅	* Gold-plated / 鍍金 * Silver-plated / 鍍銀 * Nickel-plated / 鍍鎳

M-631/M-641-PML-R

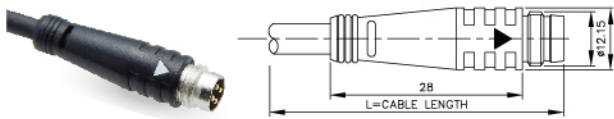

M-642-PML-R

M-631/M-641-PMDL-R

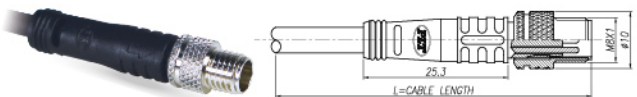

M-642-LPML-R

M-631/M-641-LPMDL-R

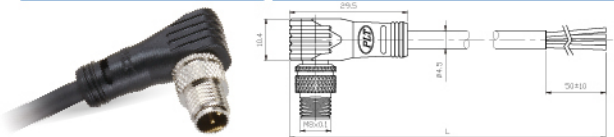

M-631/M-641/M-642-PMP-R

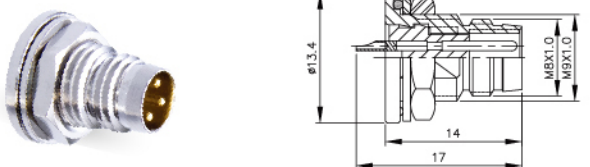

M-631/M-641/M-642-PM-R

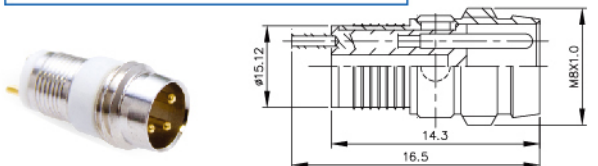

M-641-RM-R

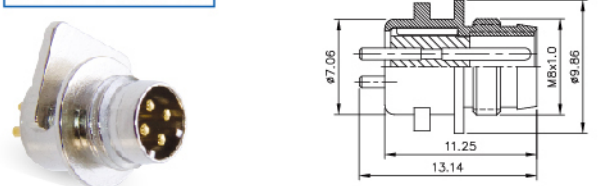

M-631/M-641/M-642-PF-R

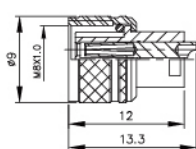

M-631/M-641/M-642-PFL-R

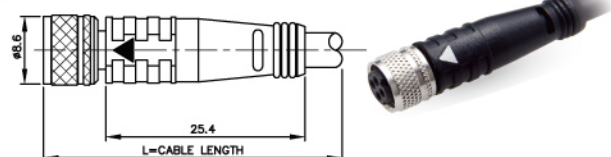

M-631/M-641/M-642-LPFL-R

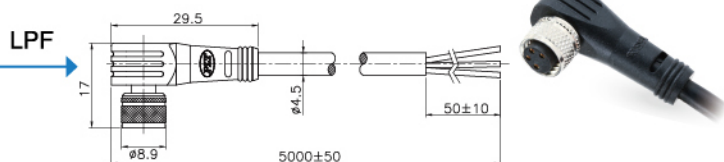

M-631/M-641/M-642-RFL-R

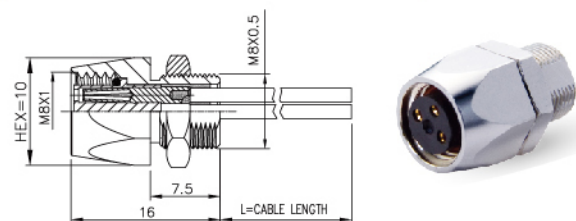

M641-PFB-R

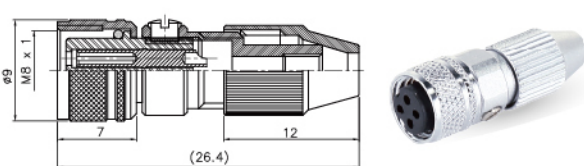

A-606PX

保護蓋 Protection Cap

◆ No. of contacts 接點數目	631	641	642			
Contacts Configuration 接點方位						
Standard 標準規範	IEC 61076-2-101(Ed.1) / IEC 60947-5-2					
Rated voltage 額定電壓	60 V AC/DC		30V AC/DC			
Rated Current 額定電流			3A			
Insulation resistance (MΩ MIN.) at DC 500V / 絕緣阻抗			300			
Contact resistance (mΩ MAX.) at DC 1A 接觸阻抗			3			
Solder inner diameter (Φ mm) 焊孔內徑			1			

WA-637 A-R

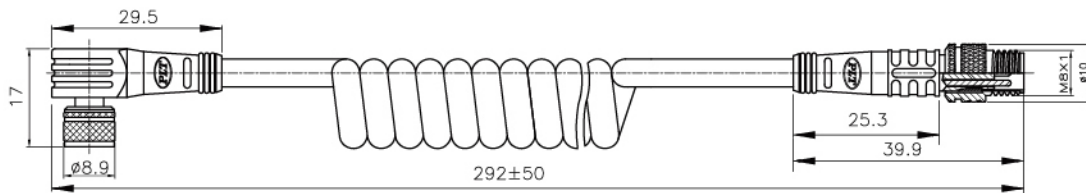

❖ No. of contacts 接點數目	31	41	42			
Contacts Configuration 接點方位						
Standard 標準規範	IEC 61076-2-101(Ed.1) / IEC 60947-5-2					
Rated voltage 額定電壓	60 V AC/DC		30 V AC/DC			
Rated Current 額定電流			3A			
Insulation resistance (MΩ MIN.) at DC 500V / 絕緣阻抗			300			
Solder inner diameter (Φ mm) 焊孔內徑			1			
LED Switch Status 開關狀態			Green			
LED Power Display 電源顯示			Yellow			



M-61 R-R

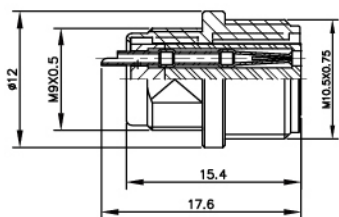

M-61 A-R

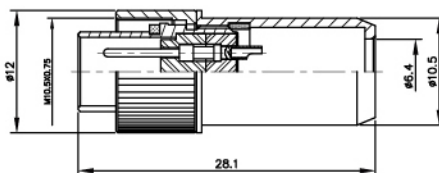

M-61 RA-R

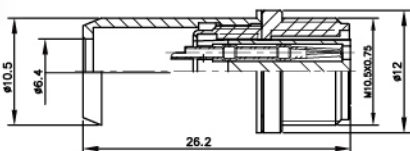

M-61 DL-R

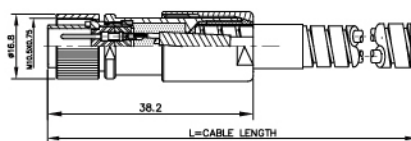

M-61 RL-R

WIRE LENGTH 線材長度

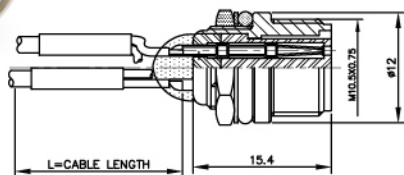

M-61 E-R

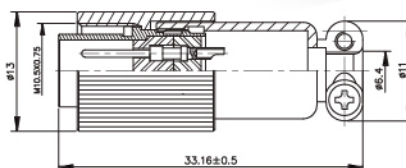

❖ No. of contacts 接點數目	2	3	4	5		
Contacts Configuration 接點方位						
Rated voltage 額定電壓	250 V AC/DC			125 V AC/DC		
Rated Current 額定電流	1A	1A	1A	1A		
Withstanding voltage (AC.V.rms) 1 minute 耐電壓1分鐘	AC 300V DC 500V	AC 300V DC 500V	AC 300V DC 500V	AC 300V DC 500V		
Insulation resistance (MΩ MIN.) at DC 500V / 絕緣阻抗	200	200	200	200		
Contact resistance (mΩ MAX.) at DC 1A 接觸阻抗	10	10	10	10		
Solder inner diameter (Φ mm) 焊孔內徑	0.9	0.9	0.9	0.9		



M-D62-PM-R

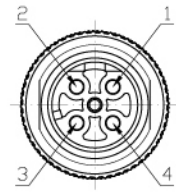
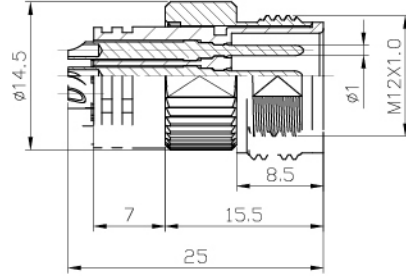

D-Code



M-D62-RFA-R

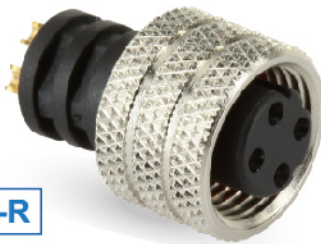
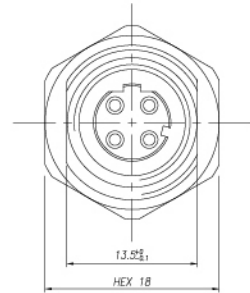
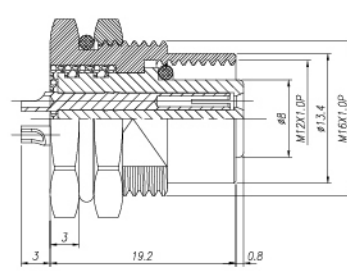

M-D62-PF-R

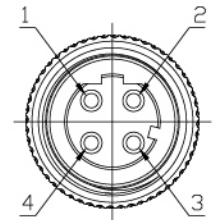
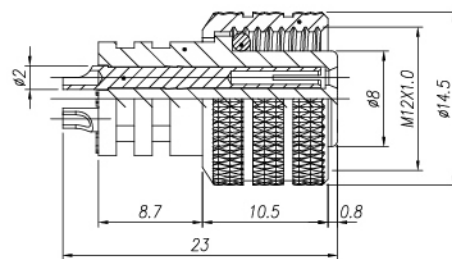

M-D62-PML-R

SHELL: ZINC ALLOY DIE-CASTING (鋅合金壓鑄)

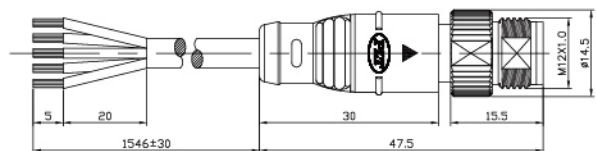

◆ No. of contacts 接點數目	4			
Contacts Configuration 接點方位				
Standard 標準規範	IEC 61076-2-101 (Ed.1) / IEC 60947-5-2			
Rated voltage 額定電壓	250 V AC/DC			
Rated Current 額定電流	4A			
Insulation resistance (MΩ MIN.) at DC 500V 絕緣阻抗	100			
Withstanding voltage (AC.V.rms) 1 minute 耐電壓1分鐘	1000			

M-62❖-PFL-R

WIRE LENGTH 線材長度
Cap Material : Al Alloy 固定帽材質：鋁合金

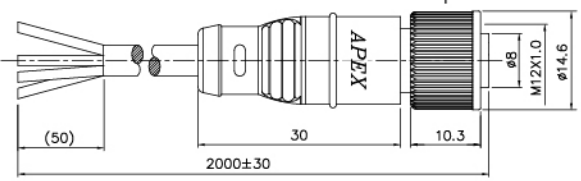

L	WIRE LENGTH
1	1M
2	2M
3	3M
4	4M
5	5M



M-62❖-PML-R

WIRE LENGTH 線材長度
Cap Material : Brass 固定帽材質：銅

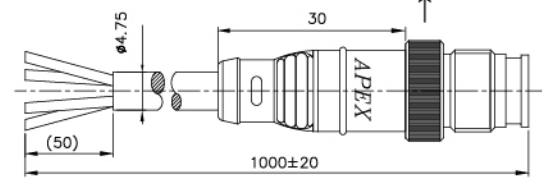

L	WIRE LENGTH
1	1M
2	2M
3	3M
4	4M
5	5M



M-62❖-PFGL-R

WIRE LENGTH 線材長度
Cap Material : Brass 固定帽材質：銅

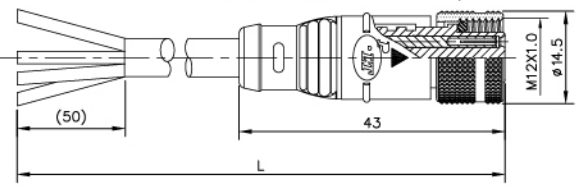

L	WIRE LENGTH
1	1M
2	2M
3	3M
4	4M
5	5M



M-62❖-PMGL-R

WIRE LENGTH 線材長度
Cap Material : Brass 固定帽材質：銅

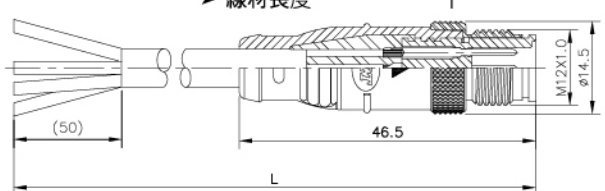

L	WIRE LENGTH
1	1M
2	2M
3	3M
4	4M
5	5M



M-62❖-PF-R

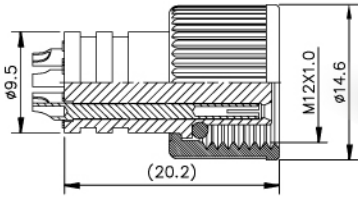

M-62❖-PM-R

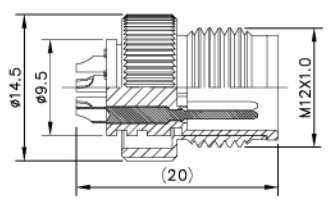

❖ No. of contacts 接點數目	2	3	3A	4	5	6	8	12
Contacts Configuration 接點方位								
Standard 標準規範	IEC 61076-2-101(Ed.1) / IEC 60947-5-2							
Rated voltage 額定電壓	250 V AC/DC			125 V AC/DC		60 V AC/DC		30 V AC/DC
Rated Current 額定電流	4A			4A		2A		1A
Withstanding voltage (AC.V.rms) 1 minute 耐電壓1分鐘	1000			1000		1000		500
Insulation resistance (MΩ MIN.) at DC 500V 絕緣阻抗	100			100		100		100
Contact resistance (mΩ MAX.) at DC 1A 接觸阻抗	3			3		3		8
Solder inner diameter(Φ mm) 焊孔內徑	1.0			1.0		1.0		1.0

M-62❖-LPFL-R

WIRE LENGTH 線材長度

Cap Material : Al Alloy
固定帽材質：鋁合金

L	WIRE LENGTH
1	1M
2	2M
3	3M
4	4M
5	5M

M-62❖-LPML-R

WIRE LENGTH 線材長度

Cap Material : Brass
固定帽材質：銅

L	WIRE LENGTH
1	1M
2	2M
3	3M
4	4M
5	5M

M-62❖A-LPFL-R

WIRE LENGTH 線材長度

Cap Material : Brass
固定帽材質：銅

L	WIRE LENGTH
1	1M
2	2M
3	3M
4	4M
5	5M

M-62❖A-LPML-R

WIRE LENGTH 線材長度

Cap Material : Brass
固定帽材質：銅

L	WIRE LENGTH
1	1M
2	2M
3	3M
4	4M
5	5M

❖ No. of contacts 接點數目	2	3	3A	4	5	6	8	12
Contacts Configuration 接點方位								
Standard 標準規範	IEC 61076-2-101(Ed.1) / IEC 60947-5-2							
Rated voltage 額定電壓	250 V AC/DC			125 V AC/DC		60 V AC/DC		30 V AC/DC
Rated Current 額定電流	4A			4A		2A		1A
Withstanding voltage (AC.V.rms) 1 minute 耐電壓1分鐘	1000			1000		1000		500
Insulation resistance (MΩ MIN.) at DC 500V 絕緣阻抗	100			100		100		100
Contact resistance (mΩ MAX.) at DC 1A 接觸阻抗	3			3		3		8
Solder inner diameter(Φ mm) 焊孔內徑	1.0			1.0		1.0		1.0

M-62-RF-R

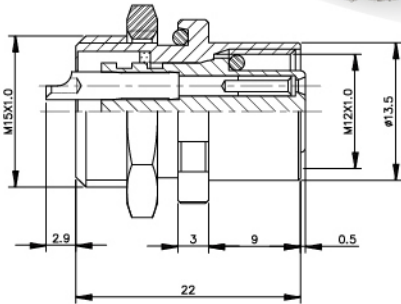

M-62-RFA-R

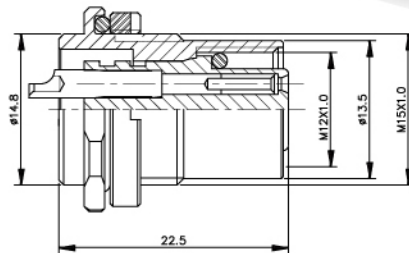

M-62-RFB-R

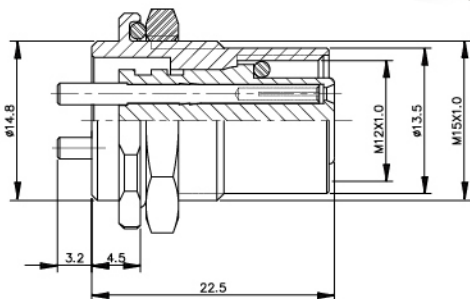

M-62-RFC-R

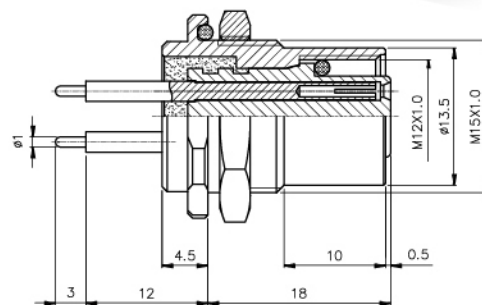

◆ No. of contacts 接點數目	2	3	3A	4	5	6	8	12
Contacts Configuration 接點方位								
Standard 標準規範	IEC 61076-2-101(Ed.1) / IEC 60947-5-2							
Rated voltage 額定電壓	250 V AC/DC			125 V AC/DC		60 V AC/DC		30 V AC/DC
Rated Current 額定電流	4A			4A		2A		1A
Withstanding voltage (AC.V.rms) 1 minute 耐電壓1分鐘	1000			1000		1000		500
Insulation resistance (MΩ MIN.) at DC 500V 絕緣阻抗	100			100		100		100
Contact resistance (mΩ MAX.) at DC 1A 接觸阻抗	3			3		3		8
Solder inner diameter(Φ mm) 焊孔內徑	1.0			1.0		1.0		1.0



M-62-RM-R

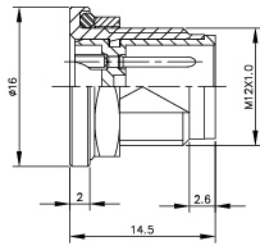

M-62-RMA-R

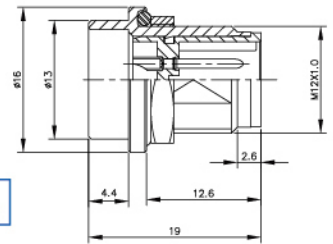

M-62-RMB-R

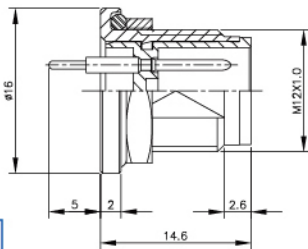

M-62-RMC-R

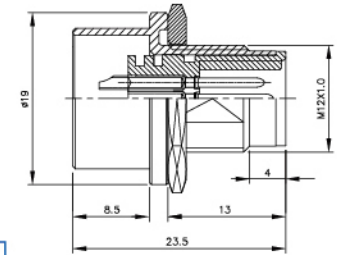

M-62-A-GP-R

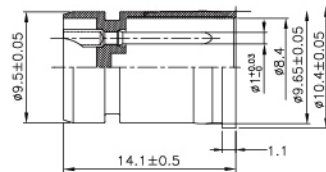

M-62-RCa-R

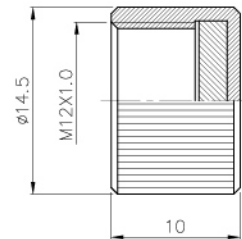

M-62-RMJ-R

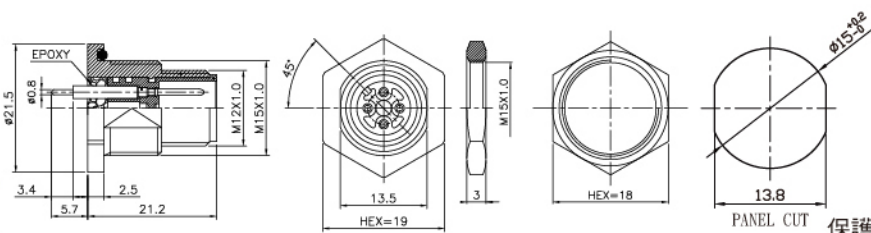

A-607PX

保護蓋 Protection Cap

◆ No. of contacts 接點數目	2	3	3A	4	5	6	8	12
Contacts Configuration 接點方位								
Rated voltage 額定電壓	250 V AC/DC			125 V AC/DC		60 V AC/DC		30 V AC/DC
Rated Current 額定電流	4A			4A		2A		1A
Withstanding voltage (AC.V.rms) 1 minute 耐電壓1分鐘	1000			1000		1000		500
Insulation resistance (MΩ MIN.) at DC 500V 絕緣阻抗	100			100		100		100
Contact resistance (mΩ MAX.) at DC 1A 接觸阻抗	3			3		3		8
Solder inner diameter (Φ mm) 焊孔內徑	1.0			1.0		1.0		1.0

M-62❖-RMD-R

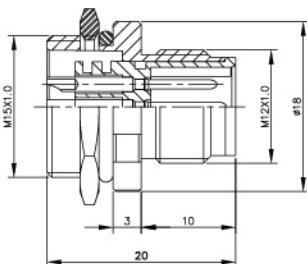

M-62❖-RME-R

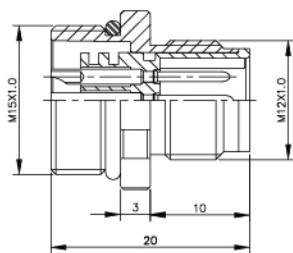

M-624/626❖-RME-R

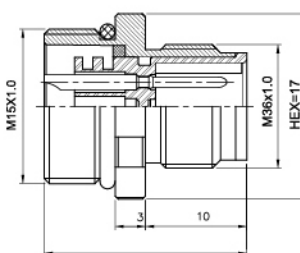

M-625/628❖-RME-R

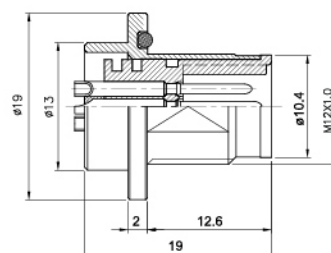

M-62❖-RMH-R

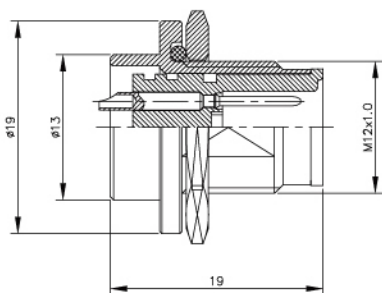

M-62❖-RMS-R

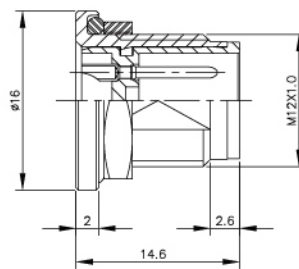

**SHELL: STAINLESS STEEL
(不鏽鋼)**

❖ No. of contacts 接點數目	2	3	3A	4	5	6	8	12
Contacts Configuration 接點方位								
Standard 標準規範	IEC 61076-2-101(Ed.1) / IEC 60947-5-2							
Rated voltage 額定電壓	250 V AC/DC			125 V AC/DC		60 V AC/DC		30 V AC/DC
Rated current / voltage 額定電流 / 電壓	4A			4A		2A		1A
Withstanding voltage (AC.V.rms) 1 minute 耐電壓1分鐘	1000			1000		1000		500
Insulation resistance (MΩ MIN.) at DC 500V 絕緣阻抗	100			100		100		100
Contact resistance (mΩ MAX.) at DC 1A 接觸阻抗	3			3		3		8
Solder inner diameter(Φ mm) 焊孔內徑	1.0			1.0		1.0		1.0



M-62 SP-PF-R



M-62 SP-PM-R

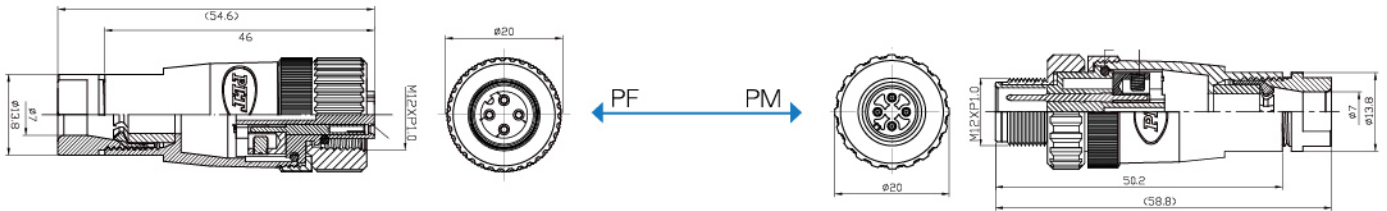

◆ No. of contacts 接點數目	4	5	6	8			
Contacts Configuration 接點方位							
Standard 標準規範	IEC 61076-2-101(Ed.1) / IEC 60947-5-2						
Rated voltage 額定電壓	250VAC/DC	125 V AC/DC	60 V AC/DC				
Rated Current 額定電流	4A	4A	2A				
Withstanding voltage (AC.V.rms) 1 minute 耐電壓1分鐘	1000	1000	1000	1000			
Insulation resistance (MΩ MIN.) at DC 500V 絕緣阻抗	100	100	100	100			
Contact resistance (mΩ MAX.) at DC 1A 接觸阻抗	3	3	3	3			
Solder inner diameter (Φ mm) 焊孔內徑	1.0	1.0	1.0	1.0			

X-Code Series



M-X628-RFA-R

M-X628-PMA-R

◆ No. of contacts 接點數目	8
Contacts Configuration 接點方位	
Standard 標準規範	IEC 61076-2-109
Rated voltage 額定電壓	50 V AC/DC
Rated Current 額定電流	0.5A
Insulation resistance (MΩ MIN.) at DC 500V 絕緣阻抗	100
Contact resistance (mΩ MAX.) at DC 1A 接觸阻抗	10

預計2020年下半年導入量產
Mass Production kick in the second half of 2020



M-623T5-ADP-R

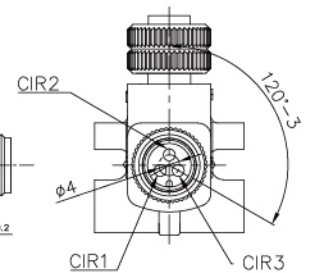
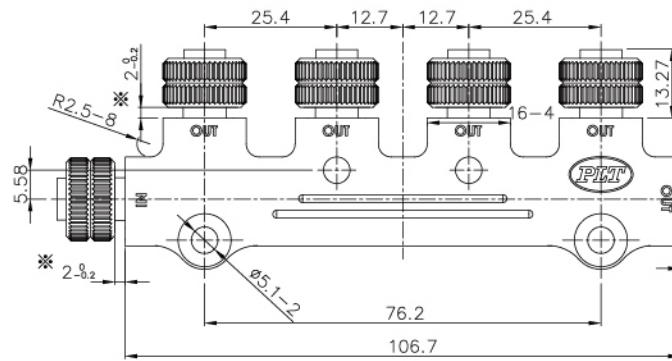
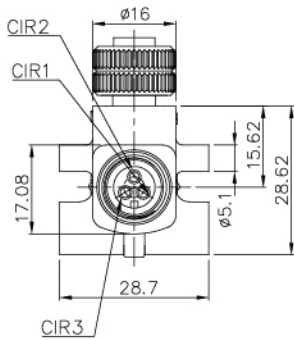
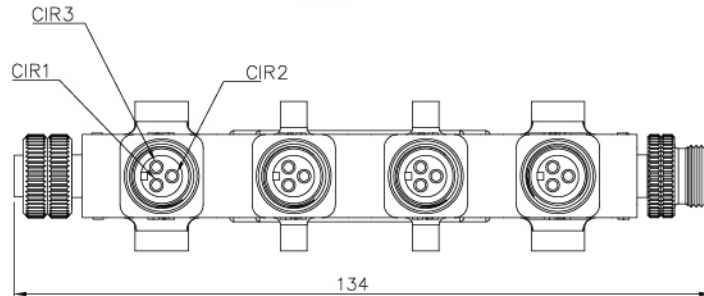

Switching Power Supply
可調式電源供應器

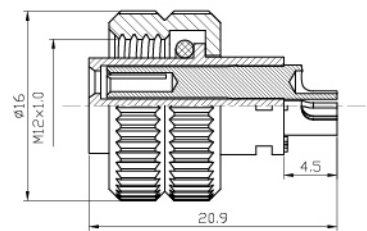
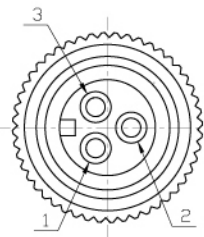

M-623A-PF

Items	Electrical specifications
Withstanding voltage (AC.V.rms) 1 minute 耐電壓 1分鐘	300
Insulation resistance (MΩ MIN.) at DC 500V 絕緣阻抗	100



WA-782A-R

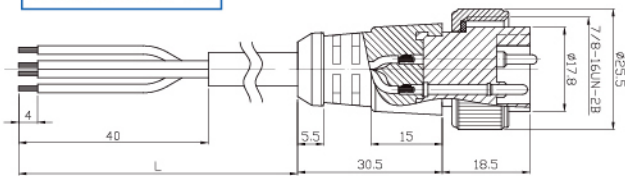

PM

M-654-RFO-R

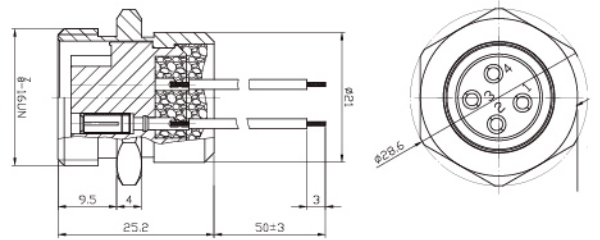

RF

M-654-RML-R

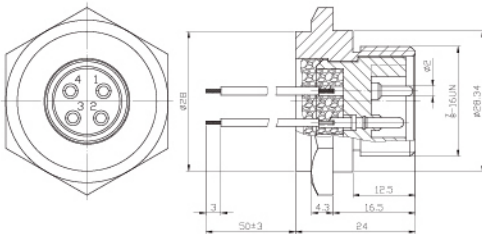

RM

WA-783A-R

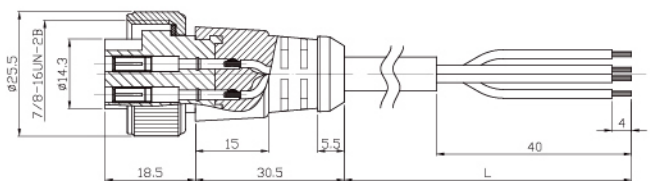

PF

M-655-RM-R

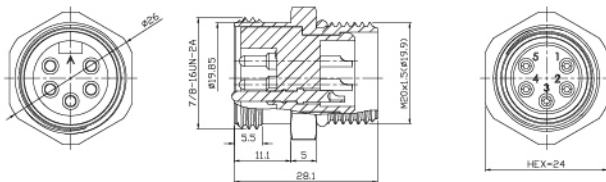

◆ No. of contacts 接點數目

Contacts Configuration 接點方位

Rated voltage 額定電壓

Rated Current 額定電流

Withstanding voltage (AC.V.rms) 1 minute 耐電壓1分鐘

Insulation resistance (MΩ MIN.) at DC 500V 絕緣阻抗

4

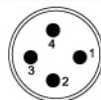

5



300 V AC/DC

300 V AC/DC

9A

9A

1000

1000

100

100



ORDERING INFORMATION

WPM-202-RM-R

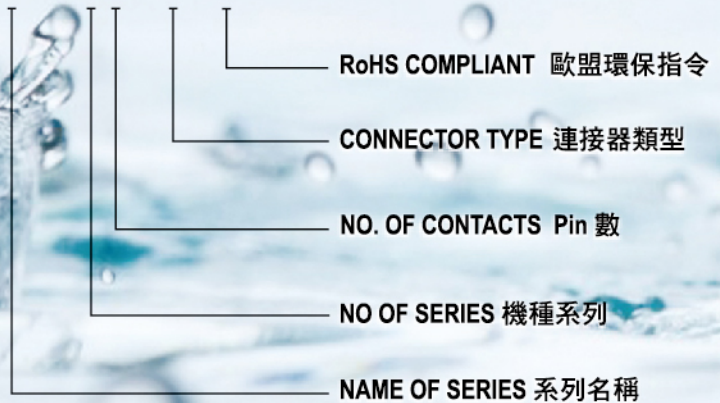

P:PLUG	R:Receptacle	F:Female	M:Male
插頭	插座	導梢	導針

WA-987C-R



AMS3126A 16-22P-R

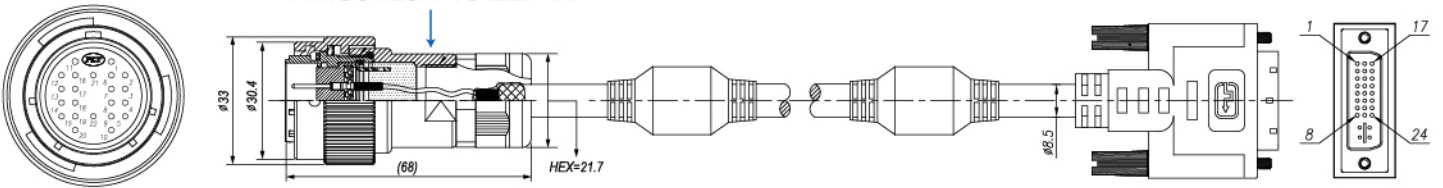

◆No. Electrical Specification			
Rated voltage 額定電壓	30 V / AC		
Rated Current 額定電流	2A		
Withstanding voltage (AC.V.rms) 1 minute 耐電壓1分鐘	1000		
Insulation resistance (MΩ MIN.) at DC 500V 絕緣阻抗	100		

AMS3126A 16-22P-R



WPS3112E 16-22SA-R

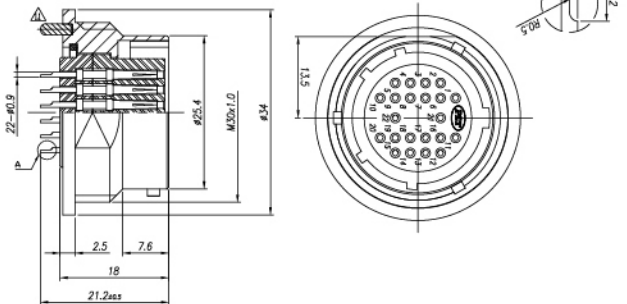
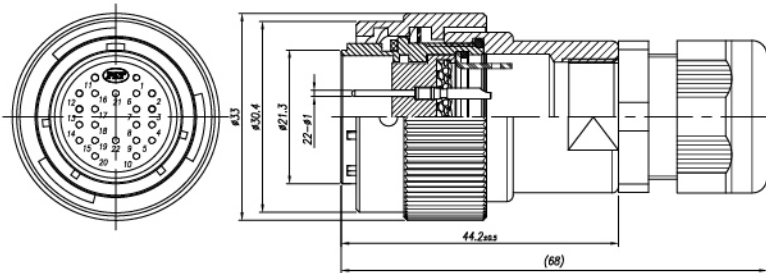

◆No. of contacts 接點數目	22		
Contacts Configuration 接點方位			
Rated voltage 額定電壓	125 V AC		
Rated Current 額定電流	2A		
Withstanding voltage (AC.V.rms) 1 minute 耐電壓1分鐘	1000		
Insulation resistance (MΩ MIN.) at DC 500V 絕緣阻抗	100		
Contact resistance (mΩ MAX.) at DC 1A 接觸阻抗	≦ 10		

WPS-236A-PF-R

量產中 Mass Production Stage

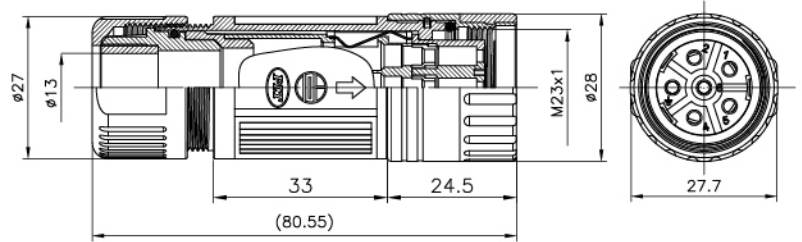

PLT-2012-RM-R

量產中 Mass Production Stage

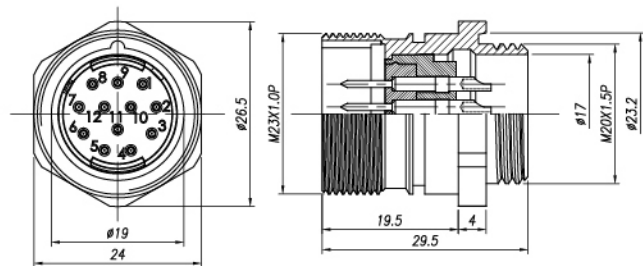

◆ No. of contacts 接點數目	6	12			
Contacts Configuration 接點方位					
Rated voltage 額定電壓	630 V AC/DC	125 V AC/DC			
Rated Current 額定電流	30A	3A			
Operation limit voltage (AC.V.rms) 操作電壓限制	630	300			
Insulation resistance (MΩ MIN.) at DC 500V 絕緣阻抗	2000	1000			
Withstanding voltage (AC.V.rms) 1 minute 耐電壓1分鐘	2000	300			
Contact resistance (mΩ MAX.) at DC 1A 接觸阻抗	3	3			



WPM06B-9-16S-R

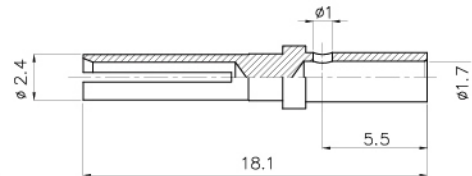
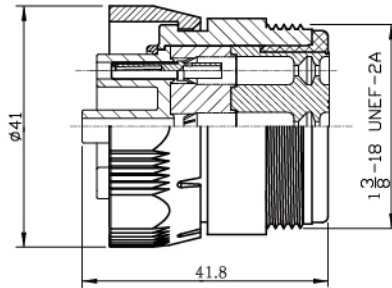
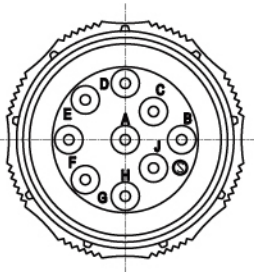

WPM02A-9-16P-R

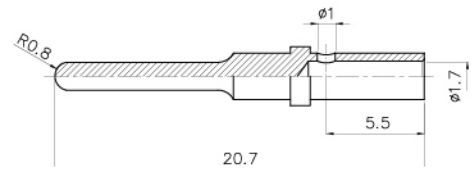
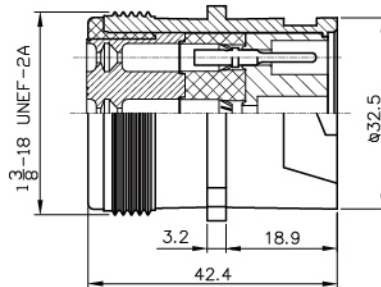
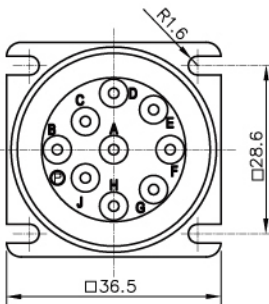

◆ No. of contacts 接點數目	9				
Contacts Configuration 接點方位					
Rated voltage 額定電壓	250 V AC				
Rated Current 額定電流	13A				
Operation limit voltage (AC.V.rms) 操作電壓限制	250				
Insulation resistance (MΩ MIN.) at DC 500V 絕緣阻抗	5000				
Withstanding voltage (AC.V.rms) 1 minute 耐電壓1分鐘	2000				
Contact resistance (mΩ MAX.) at DC 1A 接觸阻抗	3				
Solder inner diameter (Φ mm) 焊孔內徑	1.7				



WPM16A11-6PL-R

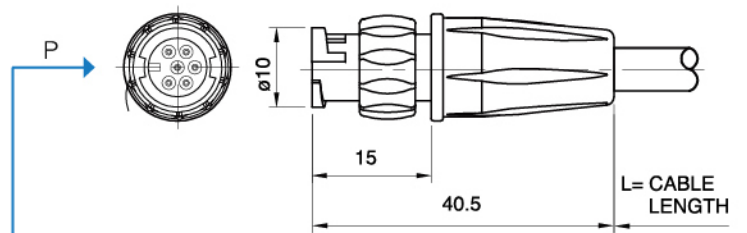

WPM16A11-6SL-R

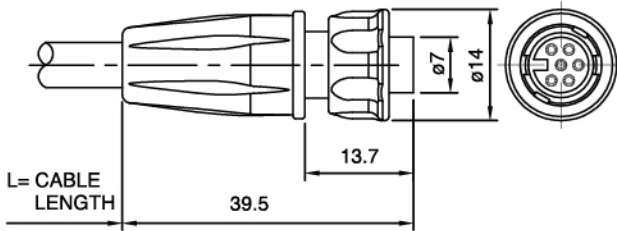

WPM16A11-6R-R

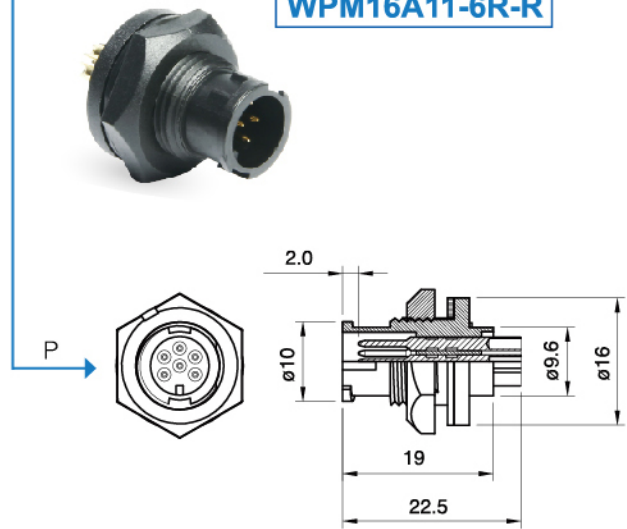

❖ No. Electrical Specification	6		
Contacts Configuration 接點方位			
Rated voltage 額定電壓	125 V AC		
Rated Current 額定電流	3A		
Insulation resistance (MΩ MIN.) at DC 500V 絕緣阻抗	100		
Withstanding voltage (AC.V.rms) 1 minute 耐電壓1分鐘	300		



WPM16C12-4S-R

WPM16C12-4P-R

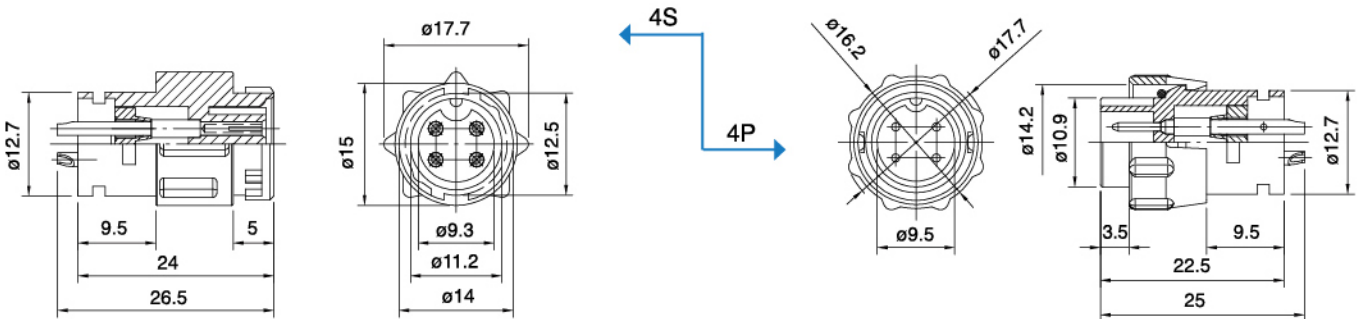

WPM16C12-8S-R

WPM16C12-8P-R

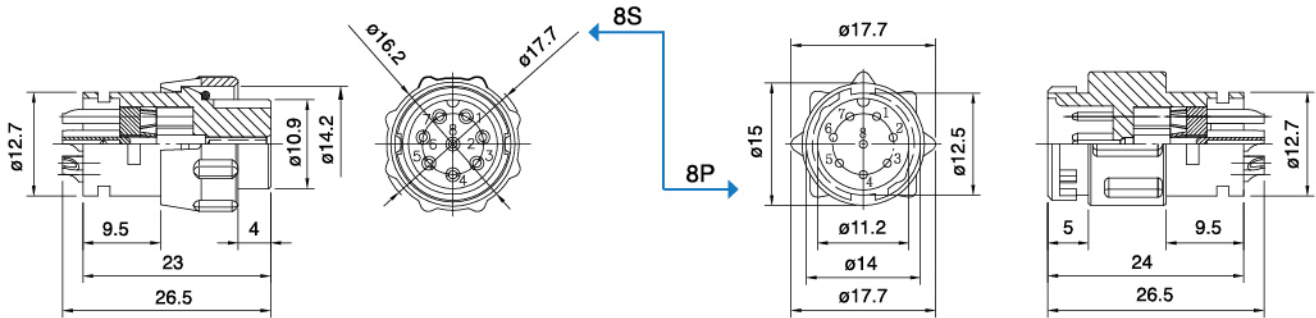

◆ No. Electrical Specification	4	8		
Contacts Configuration 接點方位				
Rated voltage 額定電壓	125 V AC	125 V AC		
Rated Current 額定電流	3A	3A		
Withstanding voltage (AC.V.rms) 1 minute 耐電壓1分鐘	1000	1000		
Insulation resistance (MΩ MIN.) at DC 500V 絕緣阻抗	100	100		
Contact resistance (mΩ MAX.) at DC 1A 接觸阻抗	3	3		



WPM-19❖-PM-R

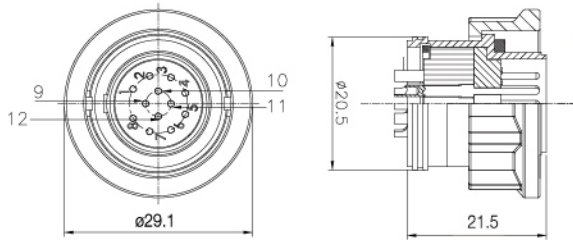

WPM-19❖-RF-R

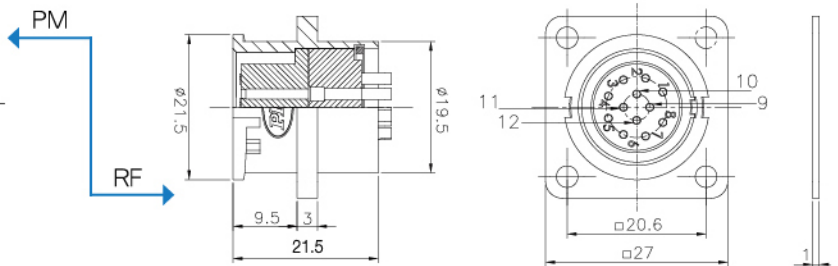

WPM-19❖-PF-R

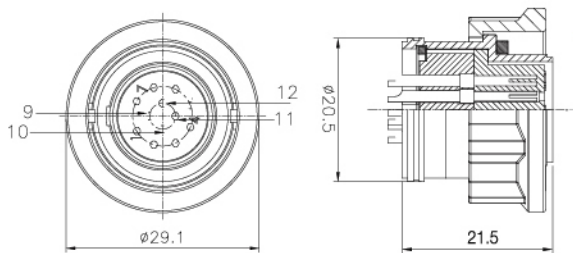

WPM-19❖-RM-R

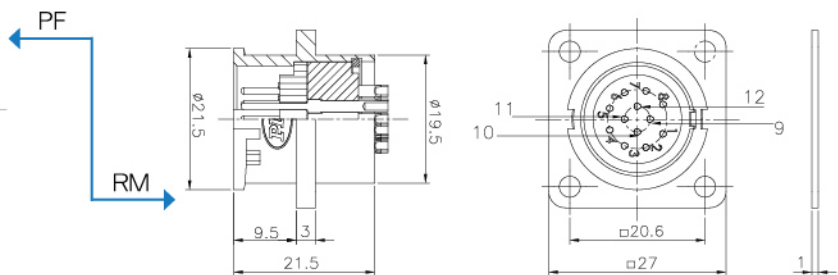

WPM-19❖-RCa-R

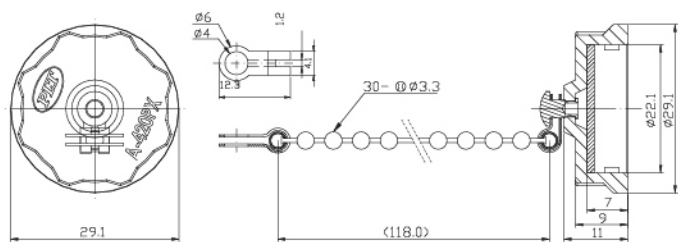

❖ No. of contacts 接點數目

8

12

Contacts

Configuration

接點方位



Rated voltage 額定電壓

125 V AC

125 V AC

Rated Current 額定電流

5A

5A

Operation limit voltage (AC. V. rms) 操作電壓限制

125

125

Withstanding voltage (AC.V.rms) 1 minute 耐電壓1分鐘

1500

1500

Insulation resistance (MΩ MIN.) at DC 500V 絕緣阻抗

1000

1000

Contact resistance (mΩ MAX.) at DC 1A 接觸阻抗

3

3

Solder inner diameter (Φ mm) 焊孔內徑

1.2

1.2



WPM-19◆-SPM-R

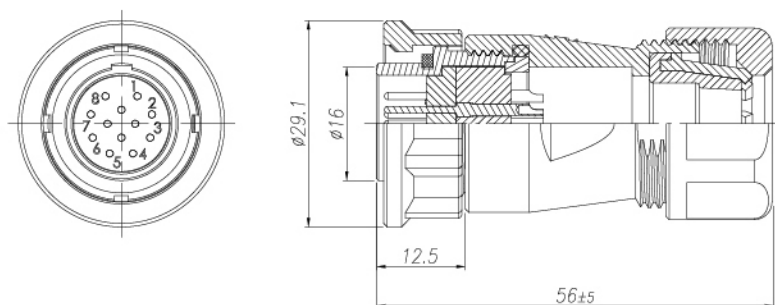

WPM-19◆-SPF-R

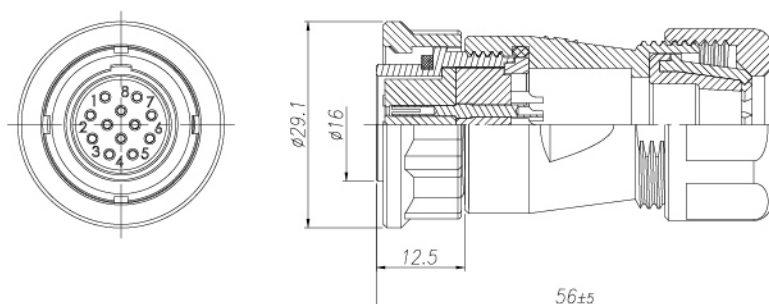

◆ No. of contacts 接點數目	8	12				
Contacts Configuration 接點方位						
Rated current / voltage 額定電流/電壓	5A 125V	5A 125V				
Operation limit voltage (AC.V.rms) 操作電壓限制	125	125				
Withstanding voltage (AC.V.rms) 1 minute 耐電壓1分鐘	1500	1500				
Insulation resistance (MΩ MIN.) at DC 500V 絕緣阻抗	1000	1000				
Contact resistance (mΩ MAX.) at DC 1A 接觸阻抗	3	3				
Solder inner diameter (Φ mm) 焊孔內徑	1.2	1.2				

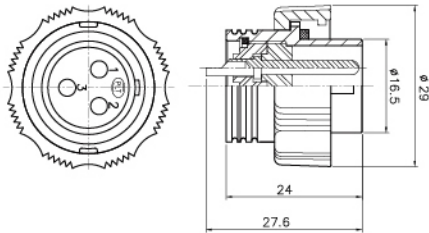
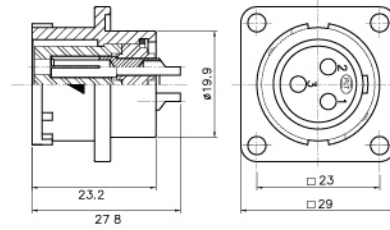
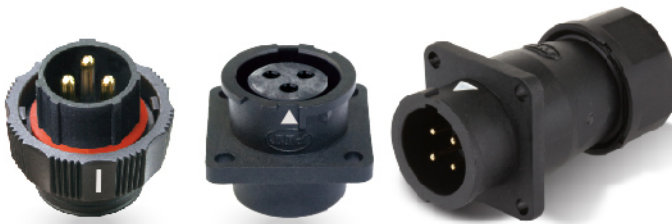

WPM-20-PM-R

PM RF

WPM-20-RF-R

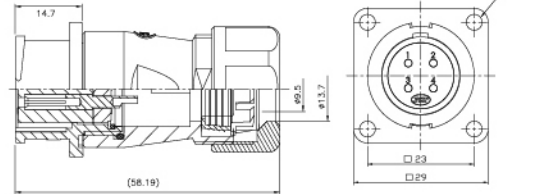

WPM-20-WGPF2.5-R

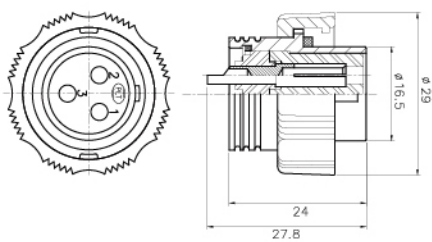
2.5=轉接5/16"尼龍管
2.5 for 5/16" nylon pipe

WPM-20-PF-R

PF WGPF

WPM-20-WGPM2.5-R

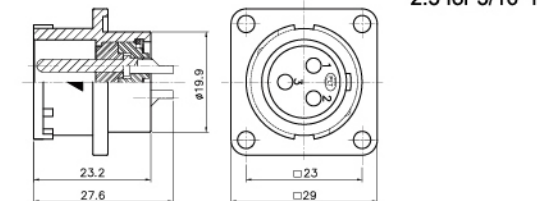
2.5=轉接5/16"尼龍管
2.5 for 5/16" nylon pipe

WPM-20-RM-R

WGPM RM

PAT WPM-20-RCa-R

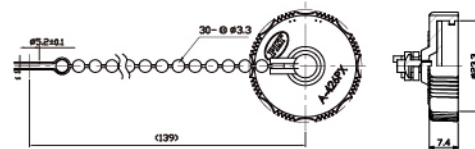

◆ No. of contacts 接點數目	2	3	4	7	12
Contacts Configuration 接點方位					
Rated voltage 額定電壓	250 V AC	250 V AC	250 V AC	250 V AC	250V AC
Rated Current 額定電流	15A	15A	15A	10A	5A
Operation limit voltage (AC.V.rms) 操作電壓限制	250	250	250	250	250
Withstanding voltage (AC.V.rms) 1 minute 耐電壓1分鐘	1500	1500	1500	1500	1000
Insulation resistance (MΩ MIN.) at DC 500V 絕緣阻抗	2000	2000	2000	2000	1000
Contact resistance (mΩ MAX.) at DC 1A 接觸阻抗	3	3	3	3	5
Solder inner diameter (Φ mm) 焊孔內徑	1.8	1.8	1.6	1.6	1.2

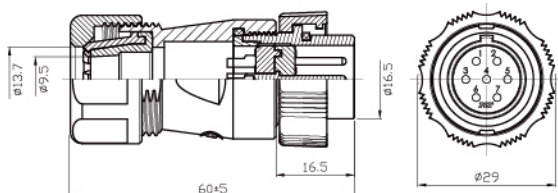

WPM-20-SPM-R

SPM

ADF

WSPM

ADFA

SPF

ADM

WSPF

ADMA

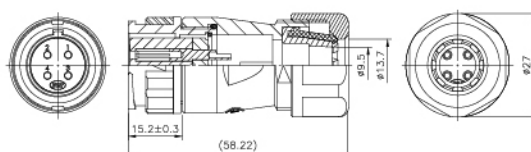

WPM-20-ADF-R

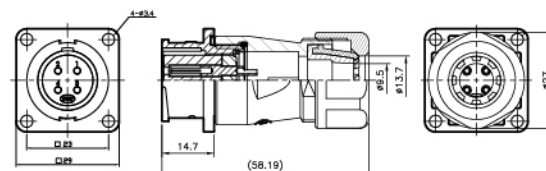

WPM-20-ADFA-R

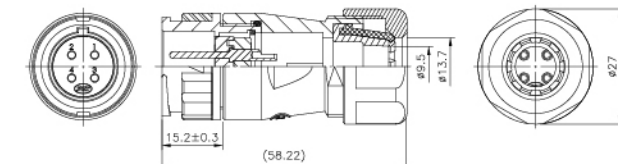

WPM-20-ADM-R

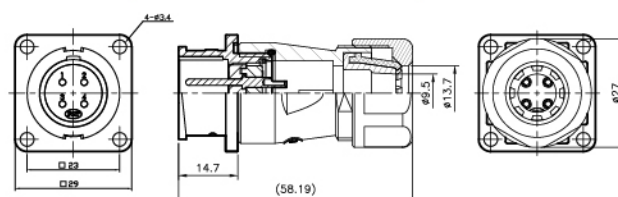

WPM-20-ADMA-R

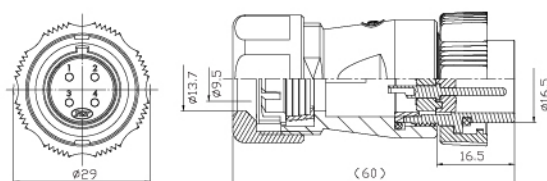
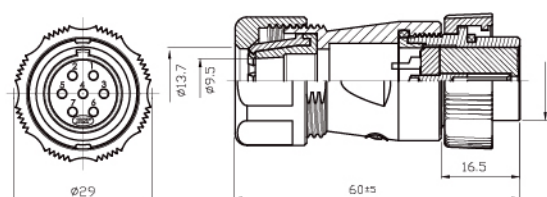
WPM-20-WSPM2.5-R 2.5=轉接5/16"尼龍管
2.5 for 5/16" nylon pipe

WPM-20-SPF-R

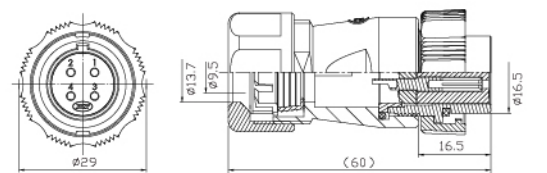
WPM-20-WSPF2.5-R 2.5=轉接5/16"尼龍管
2.5 for 5/16" nylon pipe

◆ No. of contacts 接點數目	2	3	4	5	7	12
Contacts Configuration 接點方位						
Rated voltage 額定電壓	250 V AC	250 V AC	250 V AC	250 V AC	250 V AC	250V AC
Rated Current 額定電流	15A	15A	15A	17.5A	10A	5A
Operation limit voltage (AC.V.rms) 操作電壓限制	250	250	250	250	250	250
Withstanding voltage (AC.V.rms) 1 minute 耐電壓1分鐘	1500	1500	1500	1500	1500	1000
Insulation resistance (MΩ MIN.) at DC 500V 絕緣阻抗	2000	2000	2000	2000	2000	1000
Contact resistance (mΩ MAX.) at DC 1A 接觸阻抗	3	3	5	5	3	5
Solder inner diameter (Φ mm) 焊孔內徑	1.8	1.8	1.6	1.6	1.6	1.2



WPM-21❖-RF-R

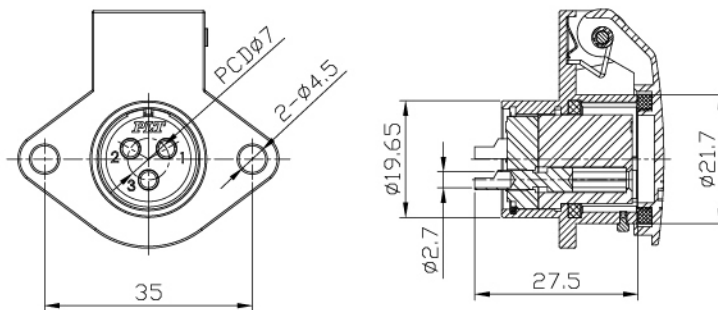

RF

PM

WPM-21❖-PM-R

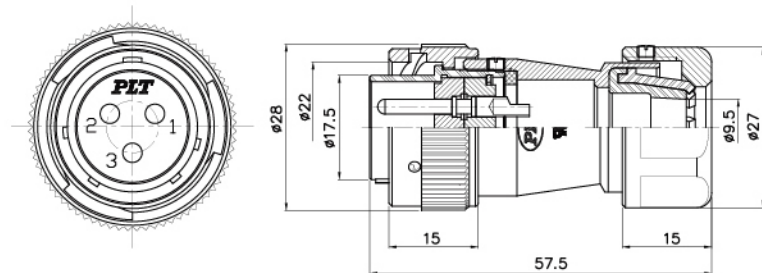

❖ No. of contacts 接點數目	3				
Contacts Configuration 接點方位					
Rated voltage 額定電壓	250 V AC				
Rated Current 額定電流	15A				
Operation limit voltage (AC.V.rms) 操作電壓限制	250				
Withstanding voltage (AC.V.rms) 1 minute 耐電壓1分鐘	1500				
Insulation resistance (MΩ MIN.) at DC 500V 絕緣阻抗	2000				
Contact resistance (mΩ MAX.) at DC 1A 接觸阻抗	3				

Cable Glands



SHELL: STAINLESS STEEL

(不鏽鋼)

Cable Clamp

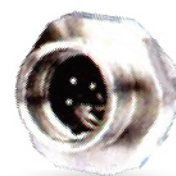
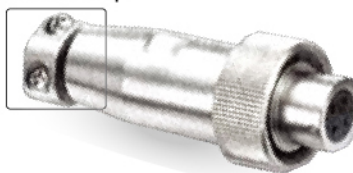

WPM-21❖-PL-R

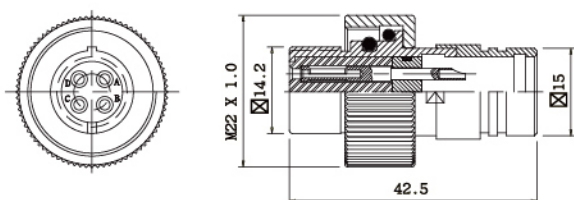

WPM-21❖-RM-R

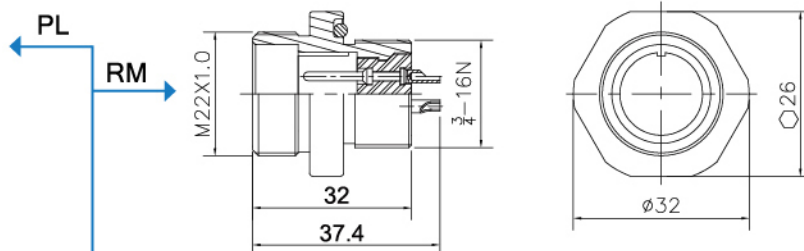

WPM-21❖-PF-R

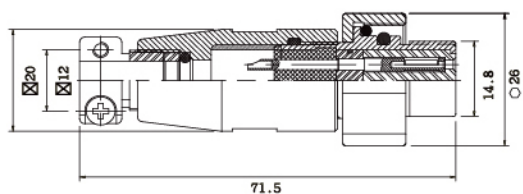

WPM-21❖-RA-R

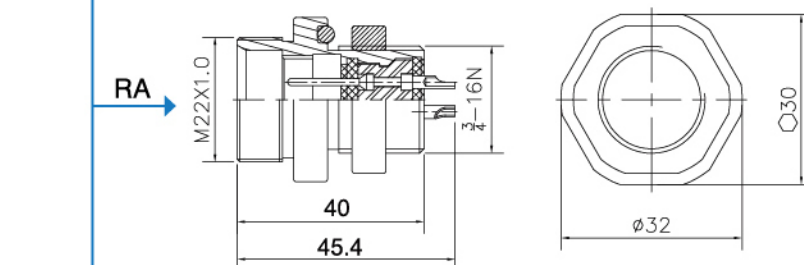

WPM-21❖-RCa-R

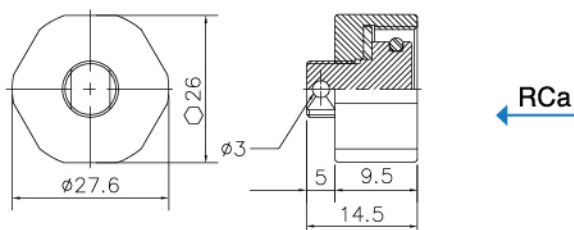

❖ No. of contacts 接點數目	4					
Contacts Configuration 接點方位						
Rated voltage 額定電壓	250 V AC					
Rated Current 額定電流	15A					
Operation limit voltage (AC.V.rms) 操作電壓限制	250					
Insulation resistance (MΩ MIN.) at DC 500V 絕緣阻抗	1500					
Contact resistance (mΩ MAX.) at DC 1A 接觸阻抗	3					
Solder inner diameter (Φ mm) 焊孔內徑	1.5					

WPM-223-PM-R

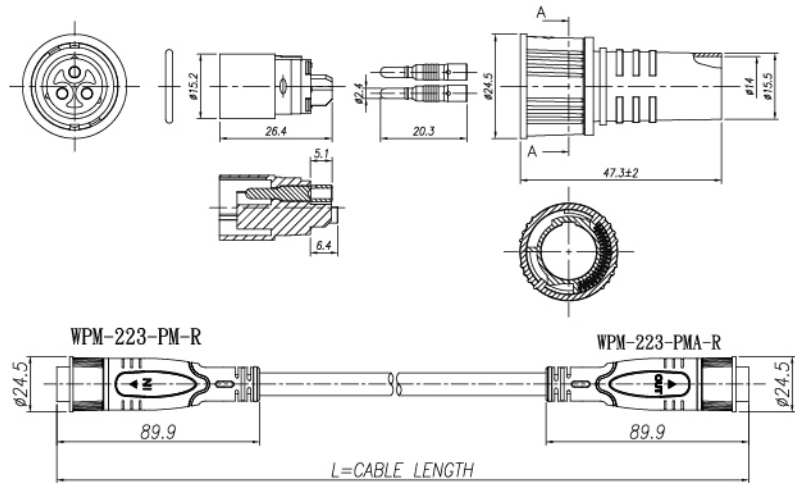

WPM-223-PMA-R

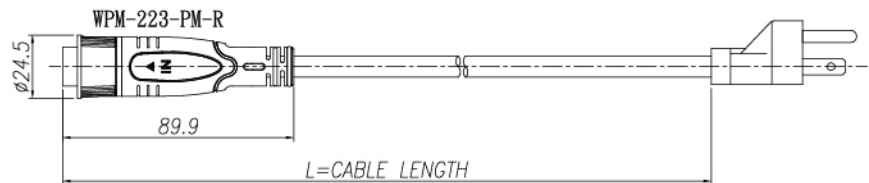

No.	Electrical Specification	
1	Insulation resistance (MΩ MIN.) at DC 500V	≧ 100MΩ at DC500V
2	Withstanding voltage (AC.V.rms) 1 minute	≧ AC600V / 1 Minute

No.	Electrical Specification	
1	Insulation resistance (MΩ MIN.) at DC 500V	≧ 100MΩ at DC500V
2	Withstanding voltage (AC.V.rms) 1 minute	≧ AC300V / 1 Minute

WPM-223-RF-R

WPM-223-RFA-R

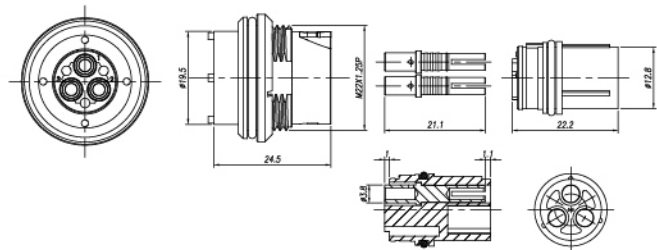

◆ No. of contacts 接點數目	3	3			
Contacts Configuration 接點方位					
Rated voltage 額定電壓	600 V AC	600 V AC			
Rated Current 額定電流	23A	23A			
Withstanding voltage (AC.V.rms) 1 minute 耐電壓1分鐘	2000	2000			
Insulation resistance (MΩ MIN.) at DC 500V 絕緣阻抗	5000	5000			
Contact resistance (mΩ MAX.) at DC 1A 接觸阻抗	3	3			

WPM-305A-PF-R

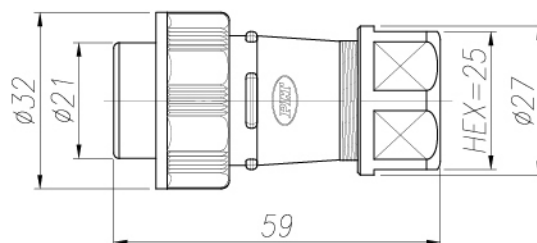
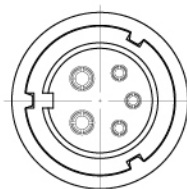

◆ No. of contacts 接點數目	5					
Contacts Configuration 接點方位						
Rated voltage 額定電壓	250 V AC					
Rated Current 額定電流	5A / 20A					
Operation limit voltage (AC.v.rms) 操作電壓限制	250					
Withstanding voltage (AC.V.rms) 1 minute 耐電壓1分鐘	1000					
Insulation resistance (MΩ MIN.) at DC 500V 絕緣阻抗	1000					
Contact resistance (mΩ MAX.) at DC 1A 接觸阻抗	3					

WPM-305A-RM-R

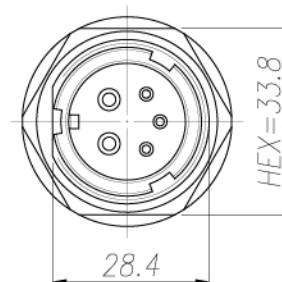
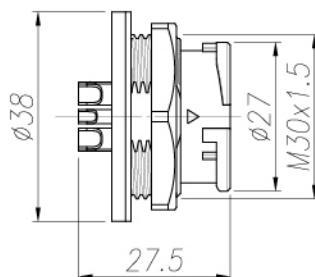

◆ No. of contacts 接點數目	5					
Contacts Configuration 接點方位						
Rated voltage 額定電壓	250 V AC					
Rated Current 額定電流	5A / 20A					
Operation limit voltage (AC.v.rms) 操作電壓限制	250					
Withstanding voltage (AC.V.rms) 1 minute 耐電壓1分鐘	1000					
Insulation resistance (MΩ MIN.) at DC 500V 絕緣阻抗	1000					
Contact resistance (mΩ MAX.) at DC 1A 接觸阻抗	3					

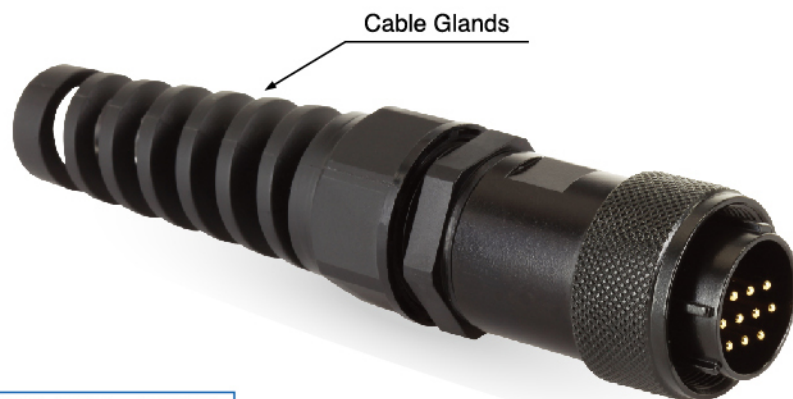

WPM-24 ❖ **-PM-R**

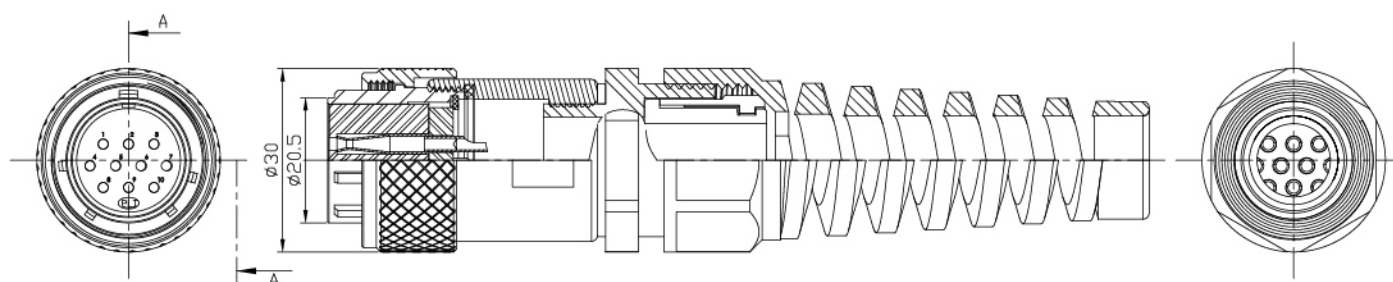

❖ No. Electrical Specification	5	10				
Contacts Configuration 接點方位						
Rated voltage 額定電壓	250 V AC	250 V AC				
Rated Current 額定電流	15A	10A				
Operation limit voltage (AC.V.rms) 操作電壓限制	400	250				
Withstanding voltage (AC.V.rms) 1 minute 耐電壓1分鐘	1800	1000				
Insulation resistance (MΩ MIN.) at DC 500V 絕緣阻抗	2000 MΩ	2000 MΩ				
Contact resistance (mΩ MAX.) at DC 1A 接觸阻抗	3	3				
Solder inner diameter (Φ mm) 焊孔內徑	2.8	1.6				



WA-715A-R

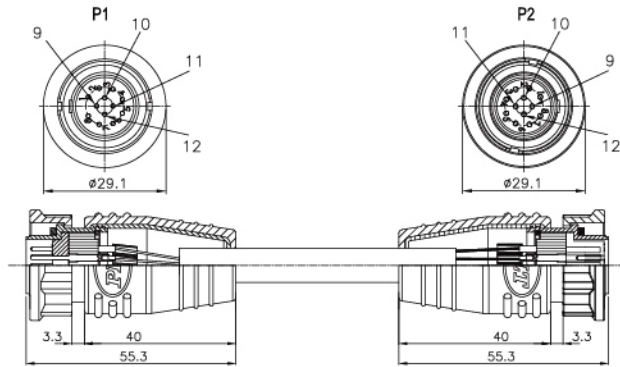

❖ No. Electrical Specification	P1	P2
Contacts Configuration 接點方位		
Withstanding voltage (AC.V.rms) 1 minute 耐電壓1分鐘	300	300
Insulation resistance (MΩ MIN.) at DC 500V 絕緣阻抗	100	100



WA-738A

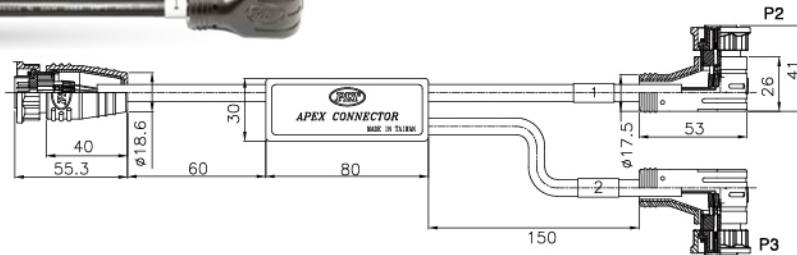

❖ No. Electrical Specification	P1	P2
Contacts Configuration 接點方位		
Withstanding voltage (AC.V.rms) 1 minute 耐電壓1分鐘	300	300
Insulation resistance (MΩ MIN.) at DC 500V 絕緣阻抗	100	100



WA-188A-R

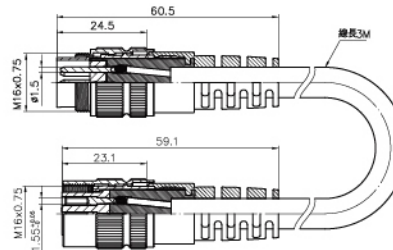

❖ No. of contacts 接點數目	8				
Contacts Configuration 接點方位					
Rated voltage 額定電壓	300 V AC				
Rated Current 額定電流	5A				
Withstanding voltage (AC.V.rms) 1 minute 耐電壓1分鐘	1000				
Insulation resistance (MΩ MIN.) at DC 500V 絕緣阻抗	100				



PLP-123-P9

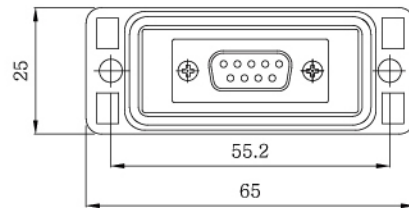
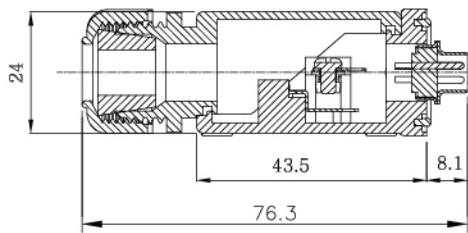
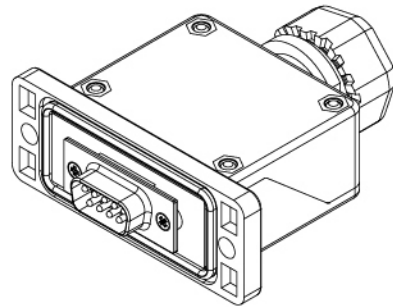
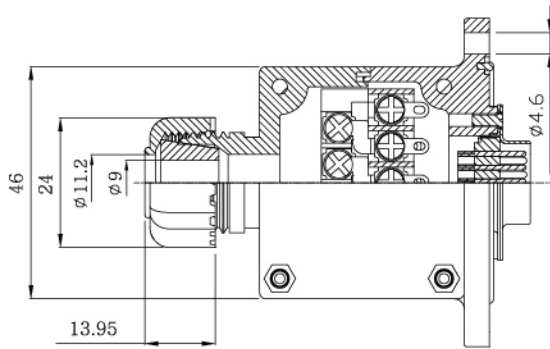

◆ No. of contacts 接點數目	9	15	
Contacts Configuration 接點方位			
Rated current / voltage 額定電流/電壓	3A / AC 350V.	3A / AC 350V.	
Withstanding voltage (AC.V.rms) 1 minute 耐電壓1分鐘	1250	1250	
Insulation resistance (MΩ MIN.) at DC 500V 絕緣阻抗	5000	5000	
Contact resistance (mΩ MAX.) at DC 1A 接觸阻抗	25	25	



PLP-138P8A-R

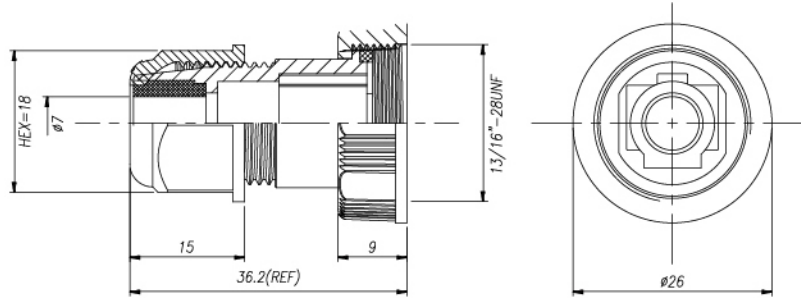

PLP-138R8A-R

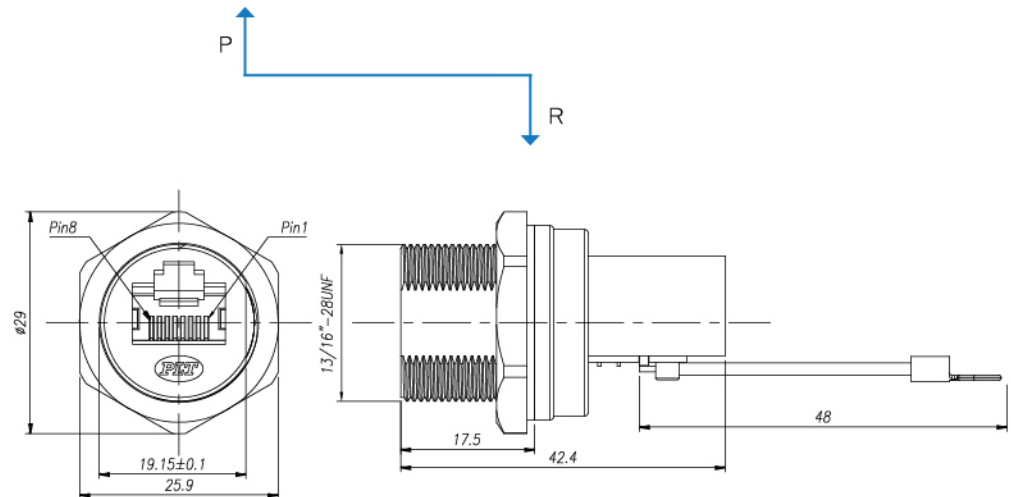

❖ No. Electrical Specification		
Rated current / voltage	Current rating: 1.5A Voltage rating: 125V AC RMS	
Withstanding voltage (AC.V.rms) 1 minute 耐電壓1分鐘	1000	
Insulation resistance (MΩ MIN.) at DC 500V 絕緣阻抗	1000	



PLP-138AD8A-R

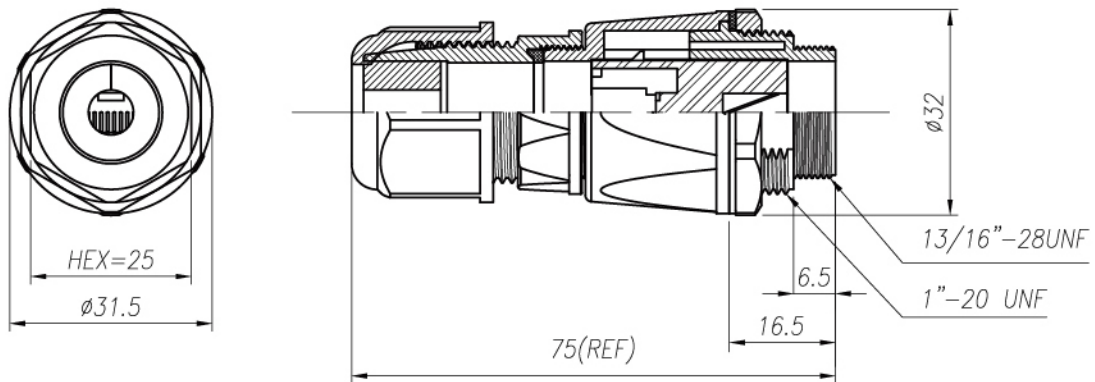

❖ No. Electrical Specification		
Rated current / voltage	Current rating: 1.5A Voltage rating: 125V AC RMS	
Withstanding voltage (AC.V.rms) 1 minute 耐電壓1分鐘	1000	
Insulation resistance (MΩ MIN.) at DC 500V 絕緣阻抗	1000	



PLS-28-RM-R

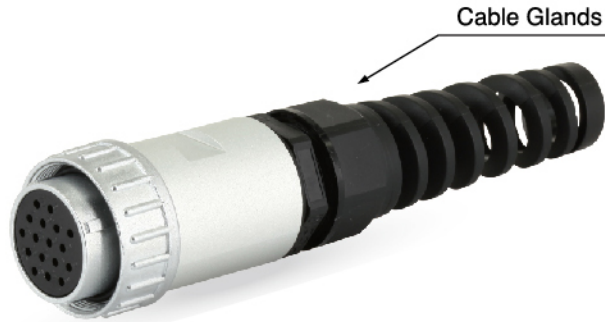
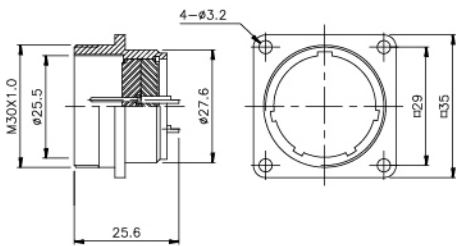

PLS-28-PFD-R

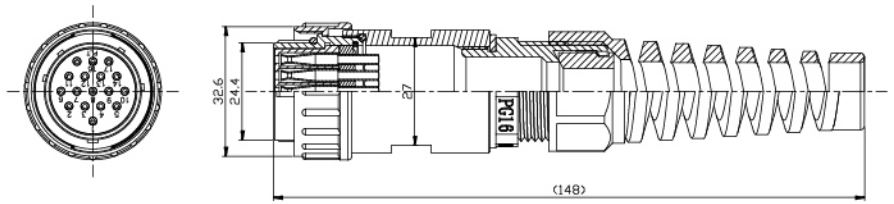

PLS-28-RMA-R

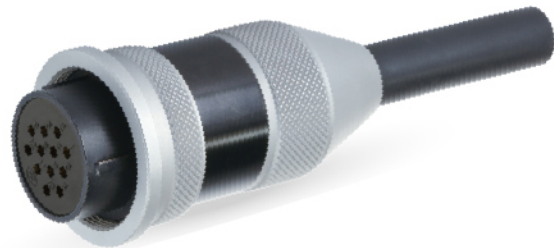
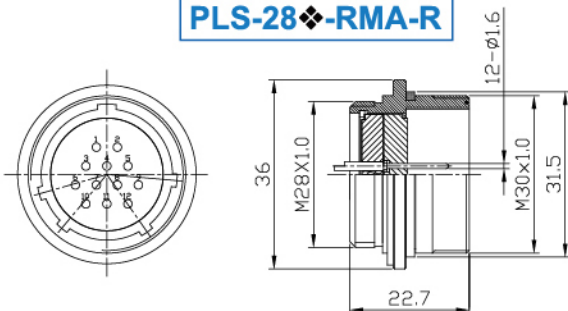

PLS-28-PFA-R

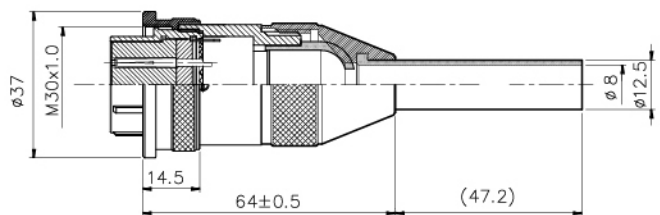

SHELL: STAINLESS STEEL (不鏽鋼)

◆ No. of contacts 接點數目	3	4	7	12	16	17	20	26
Contacts Configuration 接點方位								
Rated voltage 額定電壓	250 V AC	250 V AC	250 V AC	250 V AC	250 V AC	250 V AC	250 V AC	250 V AC
Rated Current 額定電流	15A	15A	15A	10A	5A	5A	5A	5A
Operation limit voltage (AC.V.rms) 操作電壓限制	400	400	400	250	250	250	250	250
Withstanding voltage (AC.V.rms) 1 minute 耐電壓1分鐘	2000	2000	1800	1000	1000	1000	1000	1000
Insulation resistance (MΩ MIN.) at DC 500V 絕緣阻抗	2000	2000	2000	1000	1000	1000	1000	1000
Contact resistance (mΩ MAX.) at DC 1A 接觸阻抗	3	3	3	3	3	3	3	3
Solder inner diameter (Φ mm) 焊孔內徑	3.4	3.4	2.4	1.6	1.6	1.6	1.2	1.2



WPS-2407-LF

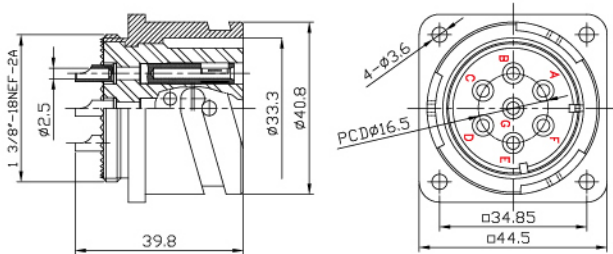

WPS-2407-LM

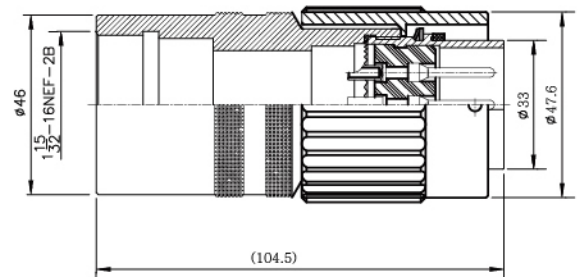

WPS-2407-SF

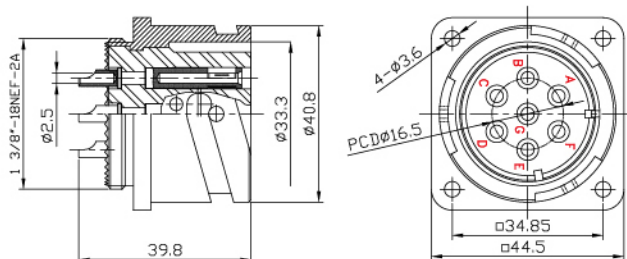

WPS-2407-SM

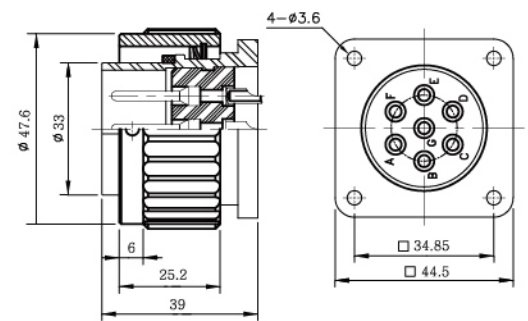

Standard Position

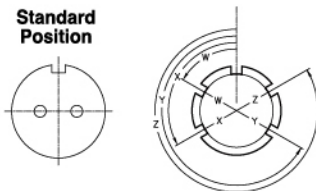

In contrast with the standard inserted position. After the guide key of its shell has formed into certain angle, the position changed shall be indicated by the marks W,X,Y,Z. According to the layout of connector, there is difference on the changable angles. Please refer to the instructions of the said table. Furthermore, what the figure has shown is observed from the joining part of the pins.

◆ No. ELECTRICAL SPECIFICATION

Operation voltage (v)	* DC 700 * AC(rms):500
Withstanding voltage	AC 2000V one minute
Test current	22 Amperes
Insulation resistance	5000MΩ min. at DC 500V

N-301P-SXGT

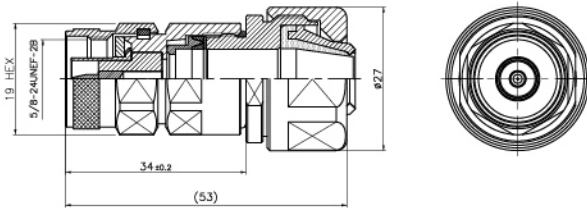

WA-948D

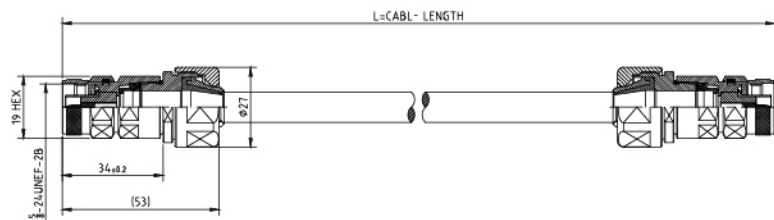

No.	ITEM	SPECIFICATIONS
1	Operating Frequency	Frequency Center: 1 : 924.250 MHz 2 : 922.750 MHz
2	Connector VSWR	Max 1.35
3	Connector Cable LOSS	Min -1.5dB
4	Impedance	50Ω

WA-884A-R



ELECTRICAL SPECIFICATIONS

Voltage rating	5A 125V AC
Operating limit voltage (AC.V.rms)	300
Withstanding voltage (AC.V.rms) 1 minute	1000
Insulation resistance (MΩ. MIN.) at DC 500V	1500

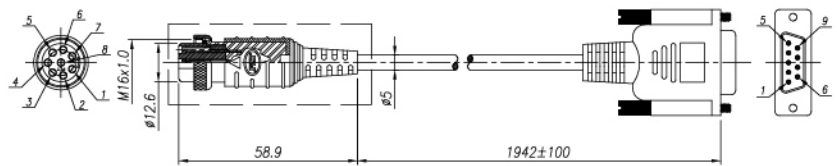

WA-885A-R

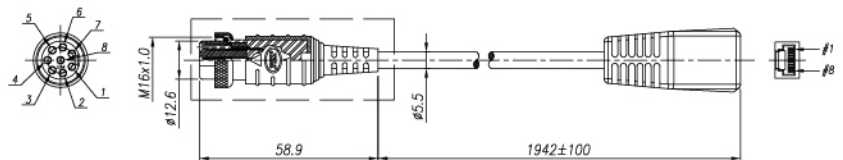

WA-889A-R

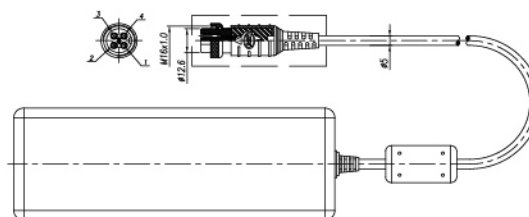

AC INPUT: 100-240V~1.3A, 50-60Hz / DC OUTPUT: 12V-7A Max (84W Max)

BUSINESS SCOPE

100% MADE IN TAIWAN

- | The 1st Business Unit**
Connector
Military / Waterproof / RF Coaxial / Industrial Series
- | The 2nd Business Unit**
Various Types of Molds
Customized Mold and Machinery Components Design & Manufacturing
- | The 3rd Business Unit**
Wire Assembly
- | The 4th Business Unit**
Wireless Communication
Antenna / Transceiver / Peripheral Accessories
- | The 5th Business Unit**
Precision Machine Manufacturing
CNC Turning and Milling Compound Lathe / Precision Arbor Press and Mechanical Press Manufacturing
- | The 6th Business Unit**
Medical Facilities for Senior Health Care
Wireless Remote Control Patient Care System / Medical Care On-Call System
- | The 7th Business Unit**
Channels of Distribution for Products Solution

- A S 9100D 航太國防工業品質管理系統認證通過
Quality Management Systems-Requirements For Aviation, Space, and Defense Organizations
- IATF 16949 全球汽車產業品質管理系統認證通過
Certified In Global Automobile Industry
- I S O 9001 國際品質管理系統認證通過
Environmental Management Systems
- I S O 14001 國際環境管理系統認證通過
Quality Management Systems



Agent / 代理商



Manufacturer **OEM / ODM**
APEX PRECISION TECHNOLOGY CORP.
錫鋼精密科技股份有限公司

總公司/總廠 : 24264 新北市新莊區民安西路405號 E-mail: apexmail@plt.com.tw
 Headquarters No. 405, Min-an W. Rd., Sinjhuang District, New Taipei City 24264, Taiwan
 TEL : +886-2-2206-8899 FAX : +886-2-2208-0559

台中/大雅廠 : 42844 台中市大雅區民生路3段191巷4號、6號、8號
 Taichung Plant No. 8, Lane 191, Section 3, Minsheng Rd., Daya District, Taichung City 42844, Taiwan
 TEL : +886-4-2560-7272 FAX : +886-4-2565-2228

日本分公司 : 株式会社 **PLT JAPAN** Technology R&D / Import & Export
 Japan 〒151-0053 東京都渋谷区代々木3丁目28番-1
 Branch Office 28-1, Yoyogi 3-Chome, Shibuya-ku, Tokyo, Japan
 TEL : +81-3-6276-8845 FAX : +81-3-6276-6645
 日本携帯電話 : +81-80-4166-2688

